

WATER WELL PLUGGING RECORD Form WWC-5P

KSA 82a-1212

ID NO.

MW-4

1 LOCATION OF WATER WELL: County: Saline	Fraction NW 1/4 SE 1/4 SW 1/4 NW 1/4	Section Number 13	Township Number T 14 S	Range Number 3 <input type="checkbox"/> E <input checked="" type="checkbox"/> W
---	---	----------------------	---------------------------	--

Street/Rural Address of Well Location; if unknown, distance & direction from nearest town or intersection: If at owner's address, check here ☐ 303 S. Santa Fe Salina, KS

Global Positioning Systems (GPS) information:

Latitude: 38.83560 (in decimal degrees)
Longitude: 97.60889 (in decimal degrees)
Elevation: 1226.77 TOC
Horizontal Datum: ☐ WGS84, ☒ NAD83, ☐ NAD27
Collection Method:

2 WATER WELL OWNER: KDHE-BER
RR#, St. Address, Box #: 1000 SW Jackson
City, State ZIP Code: Topeka, KS 66612

☐ GPS unit (Make/Model: _____)
☐ Digital Map/Photo, ☐ Topographic Map, ☒ Land Survey
Est. Accuracy: ☒ < 3 m, ☐ 3-5 m, ☐ 5-15 m, ☐ > 15 m

3 MARK WELL'S LOCATION WITH AN "X" IN SECTION BOX:

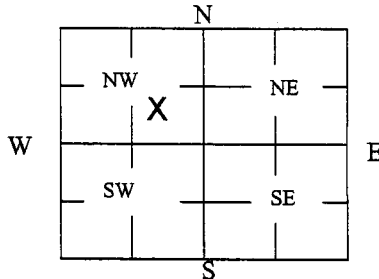

4 DEPTH OF WELL 47.60 ft.

WELL'S STATIC WATER LEVEL 34.35 ft

WELL WAS USED AS:

- | | | |
|-------------------------------------|---|--|
| <input type="checkbox"/> Domestic | <input type="checkbox"/> Public Water Supply | <input type="checkbox"/> Dewatering |
| <input type="checkbox"/> Irrigation | <input type="checkbox"/> Oil Field Water Supply | <input checked="" type="checkbox"/> Monitoring |
| <input type="checkbox"/> Feedlot | <input type="checkbox"/> Domestic (Lawn & Garden) | <input type="checkbox"/> Injection Well |
| <input type="checkbox"/> Industrial | <input type="checkbox"/> Air Conditioning | <input type="checkbox"/> Other _____ |

Was a chemical/bacteriological sample submitted to Department? Yes ☐ No ☒

5 TYPE OF BLANK CASING USED:

- ☒ Steel ☐ RMP (SR) ☐ Wrought ☐ Fiberglass ☐ Other (Specify below)
☒ PVC ☐ ABS ☐ Asbestos-Cement ☐ Concrete Tile

Blank casing diameter 2 in. Was casing pulled? Yes ☒ No ☐ If yes, how much 3 Ft
Casing height above or below land surface _____ in.

6 GROUT PLUG MATERIAL: ☐ Neat cement ☐ Cement grout ☒ Bentonite ☐ Other _____

Grout Plug Intervals: From 3 ft. to 47.60 ft., From _____ ft. to _____ ft., From _____ ft. to _____ ft.

What is the nearest source of possible contamination:

- | | | | |
|---|---|---|--|
| <input type="checkbox"/> Septic tank | <input type="checkbox"/> Seepage pit | <input type="checkbox"/> Fuel storage | <input type="checkbox"/> Other (specify below) _____ |
| <input checked="" type="checkbox"/> Sewer lines | <input type="checkbox"/> Pit privy | <input type="checkbox"/> Fertilizer storage | |
| <input type="checkbox"/> Watertight sewer lines | <input type="checkbox"/> Sewage lagoon | <input type="checkbox"/> Insecticide storage | |
| <input type="checkbox"/> Lateral lines | <input type="checkbox"/> Feedyard | <input type="checkbox"/> Abandoned water well | |
| <input type="checkbox"/> Cess pool | <input type="checkbox"/> Livestock pens | <input type="checkbox"/> Oil well/Gas well | |
- Direction from well? East
How many feet? 130

FROM	TO	PLUGGING MATERIALS	FROM	TO	PLUGGING MATERIALS
0	0.5	Asphalt			
0.5	3	Compacted silt/clay			
3	47.60	Hydrated Bentonite chips			U5-085-14485; Taco Johns

7 CONTRACTOR'S OR LANDOWNER'S CERTIFICATION: This water well was plugged under my jurisdiction and was completed on (mo/day/year) 8/13/19 and this record is true to the best of my knowledge and belief. Kansas Water Well Contractor's License No. 585. This Water Well Record was completed on (mo/day/year) 9/19/19 under the business name of Associated Environmental, Inc. by (signature) _____

Send one white copy to Kansas Department of Health & Environment, Geology Section, 1000 SW Jackson Street, Ste. 420, Topeka, KS 66612-1367. Send one copy to WATER WELL OWNER and retain one for your records.
Visit us at <http://www.kdheks.gov/waterwell/index.html> Telephone 785-296-5524.

KSA82a-1212

Revised 1/20/2015

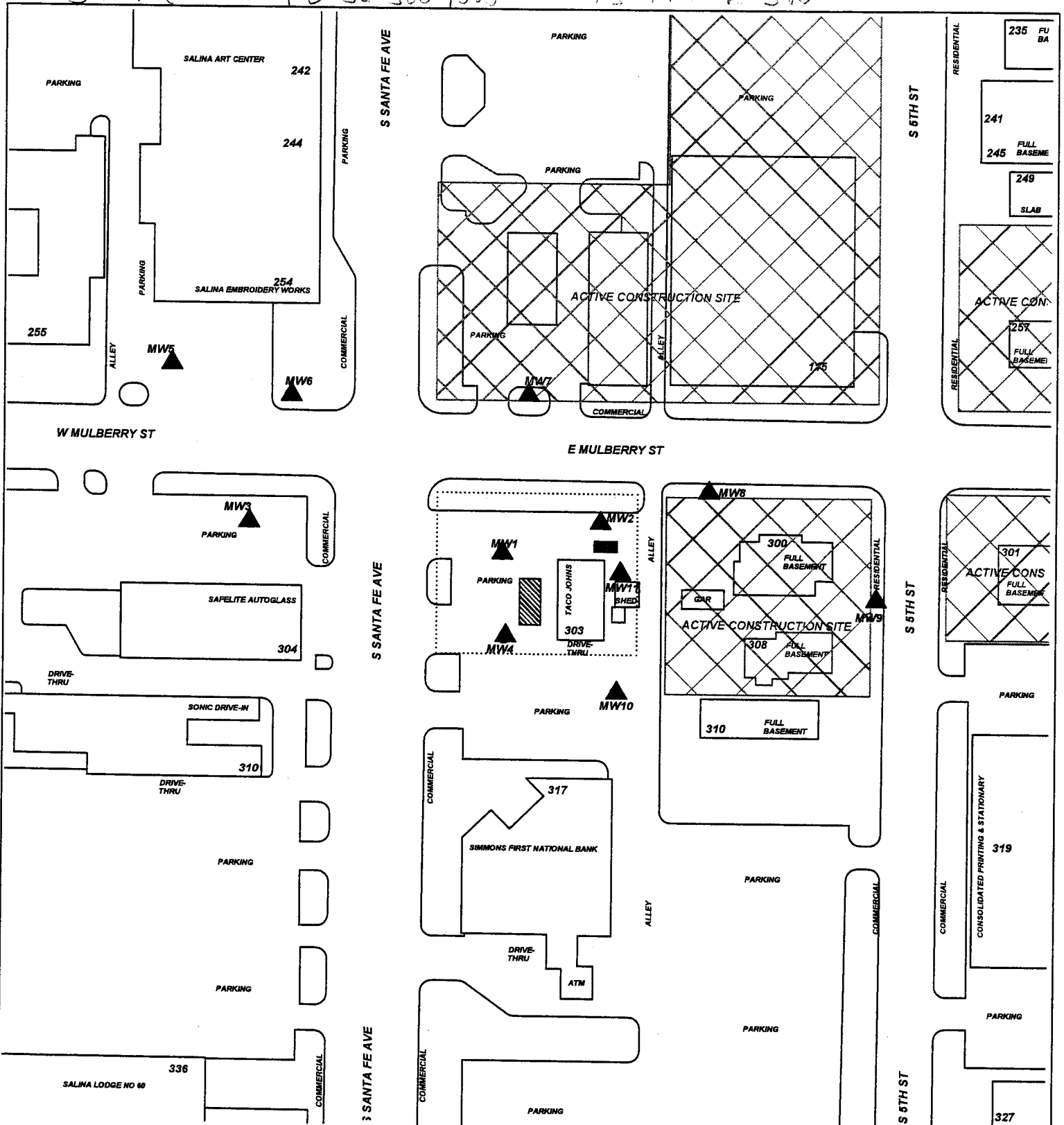

PROJECT: **TACO JOHNS**

ADDRESS: **303 S. SANTA FE**

LOCATION: **SALINA, KS**

DRAWN BY: **B. STALNAKER** DATE: **1/31/19**

REVISED BY: **B. STALNAKER** DATE: **3/26/19**

AE JOB #: **TM244** KDHE JOB #: **U5-085-14485**

TITLE:

ASSOCIATED ENVIRONMENTAL INC.

LEGEND:

- = FORMER UST BASIN
- = MONITORING WELL
- = PLUGGED/DESTROYED WELL
- = SUBJECT PROPERTY

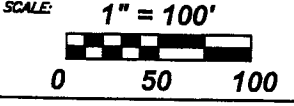

NOTES: