

WATER WELL PLUGGING RECORD Form WWC-5P

KSA 82a-1212 ID NO.

MW-10

| | | | | |
|--|---------------------------------|----------------------|---------------------------|--|
| 1 LOCATION OF WATER WELL: County: Saline | Fraction NE ¼ SE ¼ SW ¼ NW ¼ | Section Number 13 | Township Number T 14 S | Range Number 3 <input type="checkbox"/> E <input checked="" type="checkbox"/> W |
|--|---------------------------------|----------------------|---------------------------|--|

Street/Rural Address of Well Location; if unknown, distance & direction from nearest town or intersection: If at owner's address, check here ☐ 303 S. Santa Fe Salina, KS

Global Positioning Systems (GPS) information:

Latitude: 38.83556 (in decimal degrees)
 Longitude: 97.60862 (in decimal degrees)
 Elevation: 1226.74 TOC
 Horizontal Datum: ☐ WGS84, ☒ NAD83, ☐ NAD27
 Collection Method:

2 WATER WELL OWNER: KDHE-BER
 RR#, St. Address, Box #: 1000 SW Jackson
 City, State ZIP Code: Topeka, KS 66612

☐ GPS unit (Make/Model: _____)
☐ Digital Map/Photo, ☐ Topographic Map, ☒ Land Survey
 Est. Accuracy: ☒ < 3 m, ☐ 3-5 m, ☐ 5-15 m, ☐ > 15 m

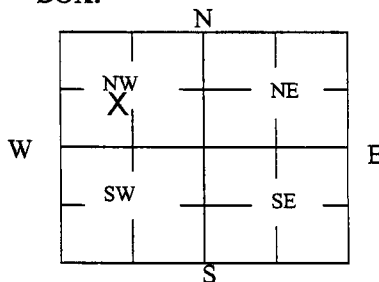
3 MARK WELL'S LOCATION WITH AN "X" IN SECTION BOX:**4 DEPTH OF WELL** 42.44 **ft.**WELL'S STATIC WATER LEVEL 34.35 **ft.**

WELL WAS USED AS:

☐ Domestic
☐ Irrigation
☐ Feedlot
☐ Industrial

☐ Public Water Supply
☐ Oil Field Water Supply
☐ Domestic (Lawn & Garden)
☐ Air Conditioning

☐ Dewatering
☒ Monitoring
☐ Injection Well
☐ Other _____

Was a chemical/bacteriological sample submitted to Department? Yes ☐ No ☒

5 TYPE OF BLANK CASING USED:

☐ Steel ☐ RMP (SR) ☐ Wrought ☐ Fiberglass ☐ Other (Specify below)
☒ PVC ☐ ABS ☐ Asbestos-Cement ☐ Concrete Tile

Blank casing diameter 2 in. Was casing pulled? Yes ☒ No ☐ If yes, how much 3 Ft
 Casing height above or below land surface _____ in.

6 GROUT PLUG MATERIAL: ☐ Neat cement ☐ Cement grout ☒ Bentonite ☐ Other _____

Grout Plug Intervals: From 3 ft. to 42.44 ft., From _____ ft. to _____ ft., From _____ ft. to _____ ft.

What is the nearest source of possible contamination:

☒ Septic tank ☐ Seepage pit ☐ Fuel storage ☐ Other (specify below)
☒ Sewer lines ☐ Pit privy ☐ Fertilizer storage
☐ Watertight sewer lines ☐ Sewage lagoon ☐ Insecticide storage
☐ Lateral lines ☐ Feedyard ☐ Abandoned water well Direction from well? East
☐ Cess pool ☐ Livestock pens ☐ Oil well/Gas well How many feet? 50

| FROM | TO | PLUGGING MATERIALS | FROM | TO | PLUGGING MATERIALS |
|------|-------|--------------------------|------|----|--------------------------|
| 0 | 0.5 | Concrete | | | |
| 0.5 | 3 | Compacted silt/clay | | | |
| 3 | 42.44 | Hydrated Bentonite chips | | | U5-085-14485; Taco Johns |
| | | | | | |
| | | | | | |
| | | | | | |

7 CONTRACTOR'S OR LANDOWNER'S CERTIFICATION: This water well was plugged under my jurisdiction and was completed on (mo/day/year) 8/13/19 and this record is true to the best of my knowledge and belief. Kansas Water Well Contractor's License No. 585. This Water Well Record was completed on (mo/day/year) 9/9/19 under the business name of Associated Environmental, Inc. by (signature) *[Signature]*

Send one white copy to Kansas Department of Health & Environment, Geology Section, 1000 SW Jackson Street, Ste. 420, Topeka, KS 66612-1367. Send one copy to WATER WELL OWNER and retain one for your records.

Visit us at <http://www.kdheks.gov/waterwell/index.html> Telephone 785-296-5524.

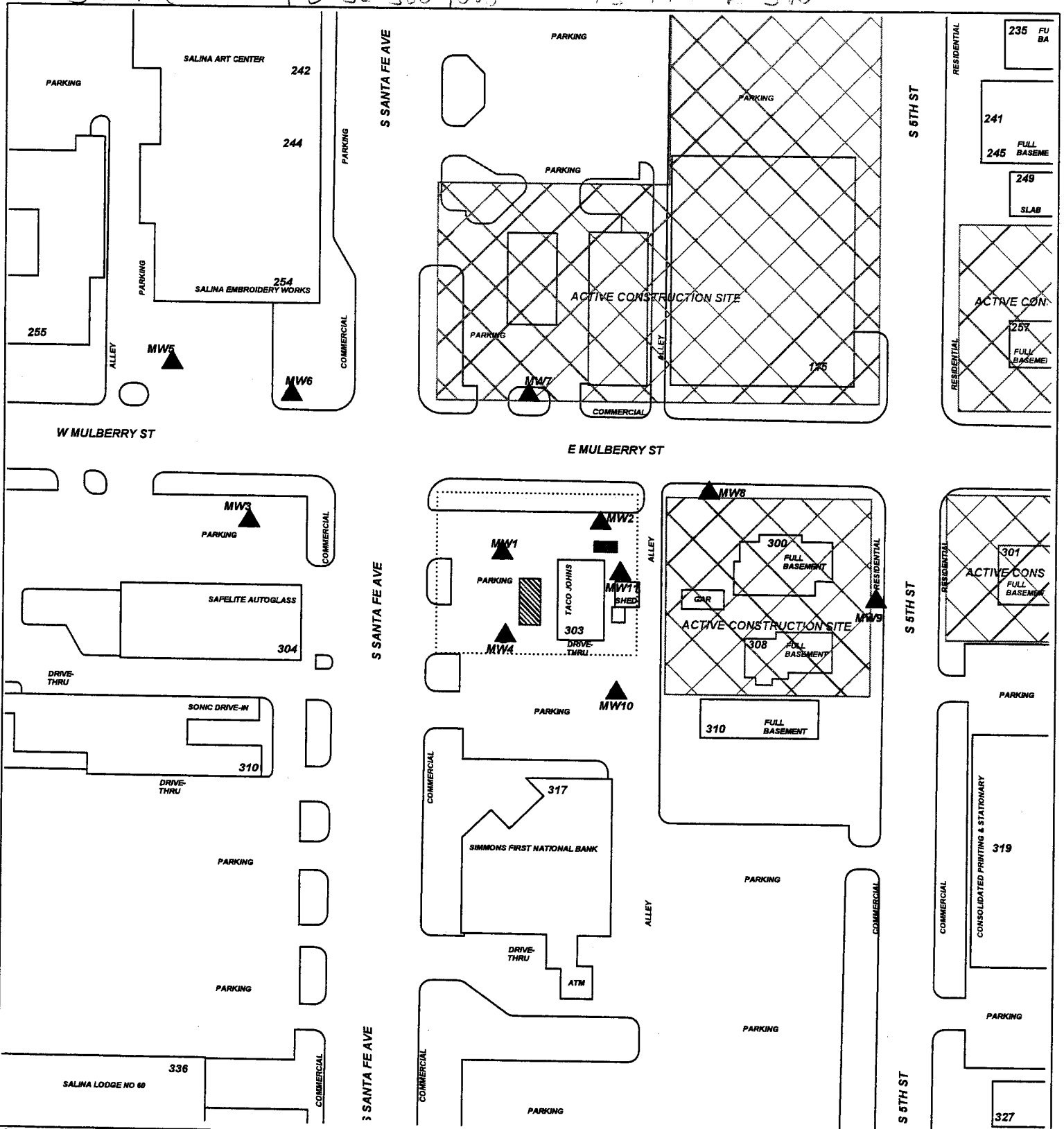

PROJECT: **TACO JOHNS**

ADDRESS: **303 S. SANTA FE**

LOCATION: **SALINA, KS**

DRAWN BY: **B. STALNAKER** DATE: **1/31/19**

REVISED BY: **B. STALNAKER** DATE: **3/26/19**

AE JOB #: **TM244** KDHE JOB #: **U5-085-14485**

TITLE:

ASSOCIATED ENVIRONMENTAL INC.

LEGEND:

- = FORMER UST BASIN
- = MONITORING WELL
- = PLUGGED/DESTROYED WELL
- = SUBJECT PROPERTY

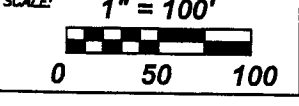

NOTES: