

WATER WELL RECORD

Form WWC-5

Division of Water Resources App. No.

[]

Well ID

MW1R

[X] Original Record [] Correction [] Change in Well Use

1 LOCATION OF WATER WELL: County Saline Fraction NE 1/4 NE 1/4 NE 1/4 NE 1/4 Section Number 13 Township Number T 14 S Range Number R 3 E [X] W

2 WELL OWNER: Last Name: Business: KDHE Address: 1000 SW Jackson Street City Topeka State: KS ZIP: 66612 Street or Rural Address where well is located (if unknown, distance and direction from nearest town or intersection): 1041 E Iron, Salina, KS

3 LOCATE WELL WITH "X" IN SECTION BOX: [Diagram showing a 3x3 grid with 'X' in the top-right corner and 'N', 'S', 'E', 'W' labels.]

4 DEPTH OF COMPLETED WELL: 34 ft Depth(s) Groundwater Encountered: 1) _____ ft 2) _____ ft 3) _____ ft, or 4) [] Dry Well WELL'S STATIC WATER LEVEL: 21.36 ft. [X] below land surface, measured on (mo-day-yr) 5/10/2022 [] above land surface, measured on (mo-day-yr) _____ Pump test data: Well water was _____ ft after _____ hours pumping _____ gpm Water well was _____ ft after _____ hours pumping _____ gpm Estimated Yield: _____ gpm Bore Hole Diameter: 7.25 in to _____ ft, and _____ in to _____ ft

5 Latitude: 38.84091 (decimal degrees) Longitude: 97.59427 (decimal degrees) Horizontal Datum [X] WGS 84 [] NAD 83 [] NAD 27 Source for Latitude/Longitude: [] GPS (unit make/model: _____) (WAAS enabled? [] Yes [] No) [X] Land Survey [] Topographic Map [] Online Mapper 6 Elevation 1219.18 ft [] Ground Level [X] TOC Source [X] Land Survey [] GPS [] Topographic Map [] Other _____

7 WELL WATER TO BE USED AS: 1 Domestic: [] Household [] Lawn & Garden [] Livestock 2 [] Irrigation 3 [] Feedlot 4 [] Industrial 5 [] Public Water Supply: well ID _____ 6 [] Dewatering: how many wells? _____ 7 [] Aquifer Recharge: well ID _____ 8 [X] Monitoring: well ID MW1R 9 Environmental Remediation: well ID _____ [] Air Sparge [] Soil Vapor Extractor [] Recovery [] Injection 10 [] Oil Field Water Supply: lease _____ 11 Test Hole: well ID _____ [] Cased [] Uncased [] Geotechnical 12 Geothermal: How many bores? _____ a) Closed Loop [] Horizontal [] Vertical b) Open Loop [] Surface Discharge [] Inj. of Water [] Other (specify): _____

Was a chemical/bacteriological sample submitted to KDHE? [] Yes [X] No If yes, date sample was submitted: _____ Water well disinfected? [] Yes [X] No

8 TYPE OF CASING USED: [] Steel [X] PVC [] Other _____ CASING JOINTS: [] Glued [] Clamped [] Welded [X] Threaded Casing diameter 2 in. to 19 ft. Diameter _____ in. to _____ ft. Diameter _____ in. to _____ ft. Casing height above land surface -0.27 in. Weight _____ lbs./ft. Well thickness or gauge No _____ TYPE OF SCREEN OR PERFORATION MATERIAL: [] Steel [] Stainless Steel [] Fiberglass [X] PVC [] Brass [] Galvanized Steel [] Concrete tile [] None used (open hole) [] Other (Specify) _____ SCREEN OR PERFORATION OPENINGS ARE: [] Continuous Slot [X] Mill Slot [] Gauze Wrapped [] Torch Cut [] Drilled Holes [] Other (Specify) _____ [] Louvered Shutter [] Key Punched [] Wire Wrapped [] Saw Cut [] None (Open Hole) SCREEN-PERFORATED INTERVALS: From 19 ft. to 34 ft. From _____ ft. to _____ ft. From _____ ft. to _____ ft. GRAVEL PACK INTERVALS: From 17 ft. to 34 ft. From _____ ft. to _____ ft. From _____ ft. to _____ ft.

9 GROUT MATERIAL: [] Neat cement [] Cement grout [X] Bentonite [X] Other Concrete: 0-0.5' Grout intervals: From 0.5 ft. to 17 ft. From _____ ft. to _____ ft. From _____ ft. to _____ ft.

Nearest source of possible contamination: [] Septic Tank [] Lateral Lines [] Pit Privy [] Livestock Pens [] Insecticide Storage [] Sewer Lines [] Cess Pool [] Sewage Lagoon [X] Fuel Storage [] Abandoned Water Well [] Watertight Sewer Lines [] Seepage Pit [] Feedyard [] Fertilizer Storage [] Oil Well / Gas Well [] Other (Specify) _____ Direction from well? W Distance from well? ~5 ft

Table with 6 columns: 10 FROM, TO, LITHOLOGIC LOG, FROM, TO, LITHO. LOG (cont.) or PLUGGING INTERVALS. Rows: 0-0.5 Concrete, 0.5-0.7 Gravel fill, 0.7-13 Clay, 13-34 Silty sand.

Notes: KDHE ID: Pump Mart; U5-085-12478 Target of monitoring well is shallow groundwater, <20' of grout was installed at the direction of KDHE.

11 CONTRACTOR'S OR LANDOWNER'S CERTIFICATION: This water well was [X] constructed, [] reconstructed, or [] plugged under my jurisdiction and was completed on (mo-day-year) 12/22/21 and this record is true to the best of my knowledge and belief. Kansas Water Well Contractor's License No 757 This Water Well Record was completed on (mo-day-year) 5/26/22 under the business name of Larsen & Associates, Inc. Signature [Signature]

Salina

13-14-3W

DENNIS L HANDKE

1820 NW 59th Terrace
TOPEKA, KANSAS 66618
785-286-4047 Home
785-286-1990 Fax

Jess Chapman
Larson & Assoc.
1311 E. 25th St., Suite B
Lawrence, Kansas, 66046

January 18, 2022

RE: Monitor Well Elevation Survey
1041 E. Iron Ave., Salina, Kansas

Proj. 22-00A
Pump Mart
U5-085-12478

Bench Mark: Chisled square on Northwest corner of storm sewer inlet near the SE corner of the property.

	Elev:	North	West	(from SE Cor. Sec. 13-14-3W)
MW-1R	rim top pipe	1219.45 1219.18	North West	5046.76 68.79
				NE1/4,NE1/4,NE1/NE1/4 Lat= 38.84091 Long = 97.59427
MW-2R	rim top pipe	1219.48 1219.19	North West	4966.15 202.49
				NE1/4,NE1/4,NE1/4,NE1/4 Lat= 38.84069 Long = 97.59474
MW-3R	rim top pipe	1220.34 1220.12	North West	5100.33 228.06
				NE1/4,NE1/4,NE1/4,NE1/4 Lat= 38.84106 Long = 97.59483
MW-4	rim top pipe	1221.07 1220.80	North East	5184.83 32.33
				NW1/4,NW1/4,NW1/4,NW1/4 (Sec 18-14-2W) Lat= 38.84129 Long = 97.59391
MW-7	rim top pipe	1219.51 1219.25	North West	5119.26 386.09
				NW1/4,NE1/4,NE1/4,NE1/4 Lat= 38.84112 Long = 97.59538
MW-9	rim top pipe	1220.32 1219.95	North West	4940.18 294.27
				SE1/4,NE1/4,NE1/4,NE1/4 Lat= 38.84062 Long = 97.59506
MW-10	rim top pipe	1220.51 1220.22	North West	4859.49 87.44
				SE1/4,NE1/4,NE1/4,NE1/4 Lat= 38.84040 Long = 97.59434
MW-11	rim top pipe	1220.23 1219.85	North East	5002.37 38.18
				NW1/4,NW1/4,NW1/4,NW1/4 (Sec 18-14-2W) Lat= 38.84079 Long = 97.59389

Lat & Long derived from Salina 7.5' quad map. WGS 84.

Elevation established from USGS Bench Mark: Q 167, NAVD 88.

If you have any questions, please feel free to call me. Thank you for the opportunity to be of service to you.

January 26, 2022
Dennis L Handke RLS
Dennis L Handke
SURVEYOR

NOTE: Figures exhibited within this report are only to be used within the context of this report. Placement of property lines, wells, structures, and roads is based on the available information from county appraiser maps, surveys, site visits, and/or previous vendor reports and should be considered approximate.

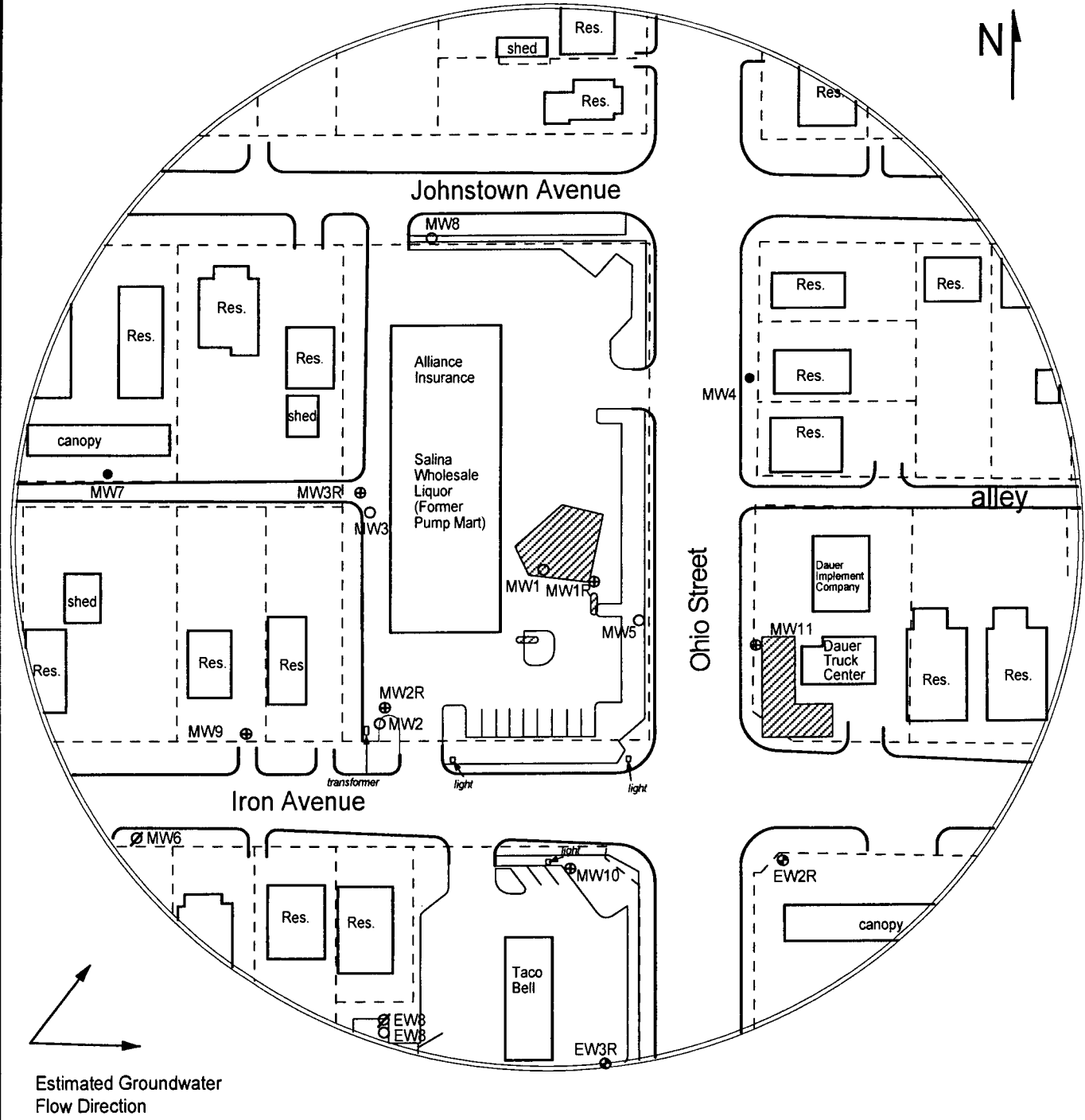

FIGURE 1 - 350 FT RADIUS AREA BASE MAP



PROJECT:

Pump Mart
1041 E Iron
Salina, KS
KDHE ID: U5-085-12478
Date: 12/21-23/22

LEGEND:

- Approximate Location of Former UST Basin & Pump Island
- Building with Basement
- Approximate Location of Property Line
- Existing Monitoring Well
- New Monitoring Well (Installed 12/21-23/21)
- Plugged Monitoring Well
- Destroyed Monitoring Well
- Monitoring Well nearby site Green Lantern U5-085-10386

1311 E 25th St. Suite B 785-841-8707 office
Lawrence, KS 66046 785-865-4282 fax

