

WATER WELL RECORD

Form WWC-5

Division of Water Resources App. No.

Well ID MW10

Original Record Correction Change in Well Use

1 LOCATION OF WATER WELL: County Saline, Fraction SE 1/4 NE 1/4 NE 1/4 NE 1/4, Section Number 13, Township Number T 14 S R 3, Range Number 3

2 WELL OWNER: Last Name: Business: KDHE, Address: 1000 SW Jackson Street, City: Topeka, State: KS, ZIP: 66612, Street or Rural Address where well is located: 1040 E Iron, Salina, KS

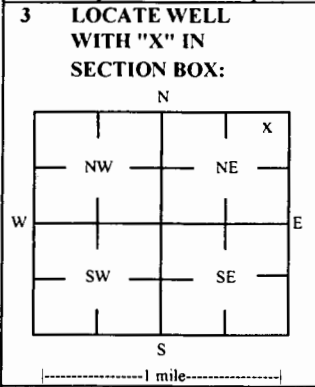

4 DEPTH OF COMPLETED WELL: 34.5 ft, Depth(s) Groundwater Encountered: 1) 34.5 ft, 2) ft, 3) ft, or 4) Dry Well, WELL'S STATIC WATER LEVEL: 22.32 ft, below land surface, measured on (mo-day-yr) 5/10/2022

5 Latitude: 38.84040 (decimal degrees), Longitude: 97.59434 (decimal degrees), Horizontal Datum: X WGS 84, Source for Latitude/Longitude: X Land Survey, Elevation: 1220.22 ft, TOC

7 WELL WATER TO BE USED AS: 1 Domestic: Household, Lawn & Garden, Livestock, Irrigation, Feedlot, Industrial; 2 Public Water Supply: well ID; 3 Dewatering: how many wells?; 4 Aquifer Recharge: well ID; 5 Monitoring: well ID MW10; 6 Environmental Remediation: well ID; 7 Air Sparge, Soil Vapor Extractor, Recovery, Injection; 8 Oil Field Water Supply: lease; 9 Test Hole: well ID; 10 Cased, Uncased, Geotechnical; 11 Geothermal: How many bores?; 12 a) Closed Loop, Horizontal, Vertical; b) Open Loop, Surface Discharge, Inj. of Water; Other (specify):

Was a chemical/bacteriological sample submitted to KDHE? No, Water well disinfected? No, If yes, date sample was submitted:

8 TYPE OF CASING USED: Steel, PVC, Other, CASING JOINTS: Glued, Clamped, Welded, Threaded, Casing diameter: 2 in. to 19 ft., Diameter: in. to ft., Casing height above land surface: -0.29 in., Weight: lbs./ft., Well thickness or gauge No., TYPE OF SCREEN OR PERFORATION MATERIAL: Steel, Stainless Steel, Fiberglass, PVC, Other (Specify), SCREEN OR PERFORATION OPENINGS ARE: Continuous Slot, Mill Slot, Gauze Wrapped, Torch Cut, Drilled Holes, Other (Specify), Louvered Shutter, Key Punched, Wire Wrapped, Saw Cut, None (Open Hole), SCREEN-PERFORATED INTERVALS: From 19.5 ft. to 34.5 ft., GRAVEL PACK INTERVALS: From 17.5 ft. to 34.5 ft.

9 GROUT MATERIAL: Neat cement, Cement grout, Bentonite, Other Concrete: 0-0.5', Grout intervals: From 0.5 ft. to 17.5 ft., From ft. to ft., From ft. to ft., From ft. to ft.

Nearest source of possible contamination: Septic Tank, Lateral Lines, Pit Privy, Livestock Pens, Insecticide Storage, Sewer Lines, Cess Pool, Sewage Lagoon, Fuel Storage, Abandoned Water Well, Watertight Sewer Lines, Seepage Pit, Feedyard, Fertilizer Storage, Oil Well / Gas Well, Other (Specify), Direction from well? N, Distance from well? ~150 ft.

10 FROM TO LITHOLOGIC LOG FROM TO LITHO. LOG (cont.) or PLUGGING INTERVALS
0 0.2 Landscaping rocks
0.2 6 Silty clay
6 8 Clay
8 9 Silty clay
9 34.5 Sand

Notes: KDHE ID: Pump Mart; U5-085-12478, Target of monitoring well is shallow groundwater. <20' of grout was installed at the direction of KDHE.

11 CONTRACTOR'S OR LANDOWNER'S CERTIFICATION: This water well was constructed, reconstructed, or plugged under my jurisdiction and was completed on (mo-day-year) 12/22/21 and this record is true to the best of my knowledge and belief. Kansas Water Well Contractor's License No. 757, This Water Well Record was completed on (mo-day-year) 5/26/22, under the business name of Larsen & Associates, Inc. Signature

Salina

13-14-3W

DENNIS L HANDKE

1820 NW 59th Terrace
TOPEKA, KANSAS 66618
785-286-4047 Home
785-286-1990 Fax

Jess Chapman
Larson & Assoc.
1311 E. 25th St., Suite B
Lawrence, Kansas, 66046

January 18, 2022

RE: Monitor Well Elevation Survey
1041 E. Iron Ave., Salina, Kansas

Proj. 22-00A
Pump Mart
U5-085-12478

Bench Mark: Chisled square on Northwest corner of storm sewer inlet near the SE corner of the property.

Elev: 1219.86 North 4933.28 West 45.70 (from SE Cor. Sec. 13-14-3W)

MW-1R	rim	1219.45	North	5046.76	NE1/4,NE1/4,NE1/NE1/4
	top pipe	1219.18	West	68.79	Lat= 38.84091 Long = 97.59427
MW-2R	rim	1219.48	North	4966.15	NE1/4,NE1/4,NE1/4,NE1/4
	top pipe	1219.19	West	202.49	Lat= 38.84069 Long = 97.59474
MW-3R	rim	1220.34	North	5100.33	NE1/4,NE1/4,NE1/4,NE1/4
	top pipe	1220.12	West	228.06	Lat= 38.84106 Long = 97.59483
MW-4	rim	1221.07	North	5184.83	NW1/4,NW1/4,NW1/4,NW1/4 (Sec 18-14-2W)
	top pipe	1220.80	East	32.33	Lat= 38.84129 Long = 97.59391
MW-7	rim	1219.51	North	5119.26	NW1/4,NE1/4,NE1/4,NE1/4
	top pipe	1219.25	West	386.09	Lat= 38.84112 Long = 97.59538
MW-9	rim	1220.32	North	4940.18	SE1/4,NE1/4,NE1/4,NE1/4
	top pipe	1219.95	West	294.27	Lat= 38.84062 Long = 97.59506
MW-10	rim	1220.51	North	4859.49	SE1/4,NE1/4,NE1/4,NE1/4
	top pipe	1220.22	West	87.44	Lat= 38.84040 Long = 97.59434
MW-11	rim	1220.23	North	5002.37	NW1/4,NW1/4,NW1/4,NW1/4 (Sec 18-14-2W)
	top pipe	1219.85	East	38.18	Lat= 38.84079 Long = 97.59389

Lat & Long derived from Salina 7.5' quad map. WGS 84.

Elevation established from USGS Bench Mark: Q 167, NAVD 88.

If you have any questions, please feel free to call me. Thank you for the opportunity to be of service to you.

Dennis L Handke RLS

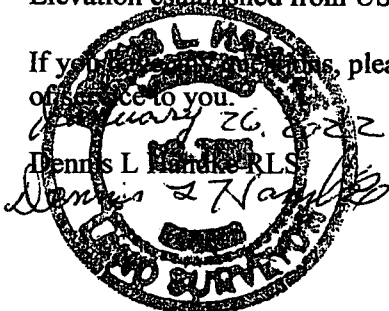

NOTE: Figures exhibited within this report are only to be used within the context of this report. Placement of property lines, wells, structures, and roads is based on the available information from county appraiser maps, surveys, site visits, and/or previous vendor reports and should be considered approximate.

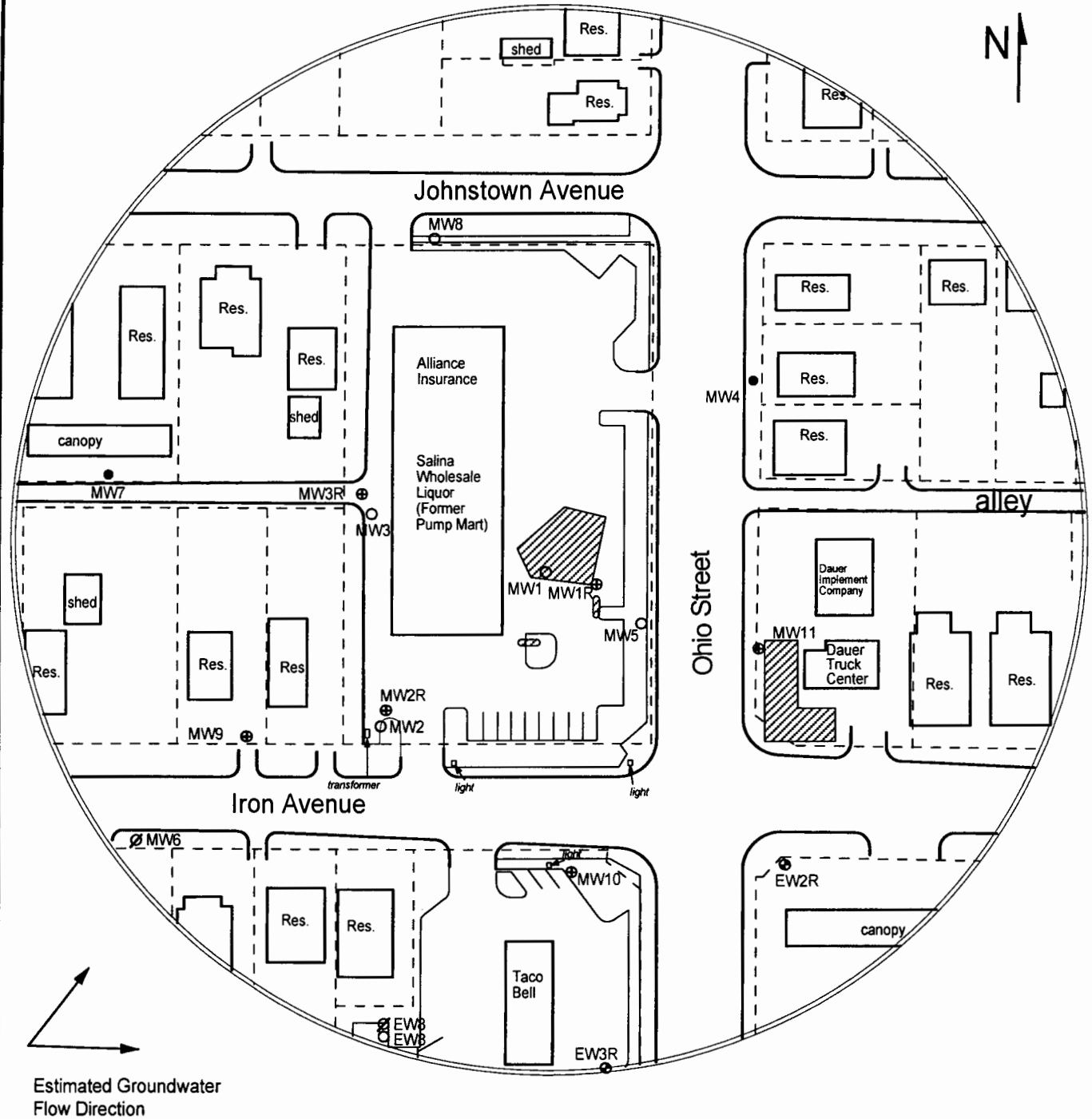

FIGURE 1 - 350 FT RADIUS AREA BASE MAP



PROJECT:

Pump Mart
 1041 E Iron
 Salina, KS
 KDHE ID: U5-085-12478
 Date: 12/21-23/22

1311 E 25th St. Suite B 785-841-8707 office
 Lawrence, KS 66046 785-865-4282 fax



LEGEND:

- Approximate Location of Former UST Basin & Pump Island
- Building with Basement
- Approximate Location of Property Line
- Existing Monitoring Well
- New Monitoring Well (Installed 12/21-23/21)
- Plugged Monitoring Well
- Destroyed Monitoring Well
- Monitoring Well nearby site Green Lantern U5-085-10386