

Revision

WATER WELL RECORD

Form WWC-5

Division of Water Resources App. No.

Well ID

MW2R

Original Record Correction Change in Well Ust

1 LOCATION OF WATER WELL: County Saline Fraction NE 1/4 NE 1/4 NW 1/4 NE 1/4 Section Number 26 Township Number T 14 S Range Number R 3 E W

2 WELL OWNER: Last Name: First: Street or Rural Address where well is located (if unknown, distance and direction from nearest town or intersection): If at owner's address, check here: Business: KDHE (K & B Pit Stop) Address: 1000 SW Jackson City Topeka State: KS ZIP: 66612

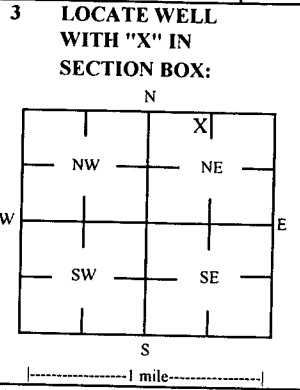

4 DEPTH OF COMPLETED WELL: 40 ft Depth(s) Groundwater Encountered: 1) ft 2) ft 3) ft, or 4) Dry Well WELL'S STATIC WATER LEVEL: ft. below land surface, measured on (mo-day-yr) above land surface, measured on (mo-day-yr) Pump test data: Well water was ft after hours pumping gpm Water well was ft after hours pumping gpm Estimated Yield: gpm Bore Hole Diameter: 7.25 in to ft, and in to ft

5 Latitude: 38.81222 (decimal degrees) Longitude: 97.61821 (decimal degrees) Horizontal Datum: X WGS 84 NAD 83 NAD 27 Source for Latitude/Longitude: GPS (unit make/model) Land Survey Topographic Map Online Mapper

6 Elevation 1235.61 ft Ground Level TOC Source: X Land Survey GPS Topographic Map Other

7 WELL WATER TO BE USED AS: 1 Domestic: Household Lawn & Garden Livestock Irrigation Feedlot Industrial 2 Public Water Supply: well ID 3 Dewatering: how many wells? 4 Aquifer Recharge: well ID 5 Monitoring: well ID MW2R 6 Environmental Remediation: well ID 7 Air Sparge Soil Vapor Extraction Recovery Injection 8 Oil Field Water Supply: lease 9 Test Hole: well ID Cased Uncased Geotechnical 10 Geothermal: How many bores? a) Closed Loop Horizontal Vertical b) Open Loop Surface Discharge Inj. of Water Other (specify):

Was a chemical/bacteriological sample submitted to KDHE? Yes No If yes, date sample was submitted: Water well disinfected? Yes No

8 TYPE OF CASING USED: Steel PVC Other CASING JOINTS: Glued Clamped Welded Threaded Casing diameter 2 in. to 25 ft, Diameter in. to ft, Diameter in. to ft, Casing height above land surface -0.52 in. Weight lbs./ft. Well thickness or gauge No TYPE OF SCREEN OR PERFORATION MATERIAL: Steel Stainless Steel Fiberglass PVC Other (Specify) SCREEN OR PERFORATION OPENINGS ARE: Continuous Slot Mill Slot Gauze Wrapped Torch Cut Drilled Holes Other (Specify) Louvered Shutter Key Punched Wire Wrapped Saw Cut None (Open Hole) SCREEN-PERFORATED INTERVALS: From 25 ft. to 40 ft, From ft. to ft, From ft. to ft, GRAVEL PACK INTERVALS: From 22 ft. to 40 ft, From ft. to ft, From ft. to ft,

9 GROUT MATERIAL: Neat cement Cement grout Bentonite Other Concrete: 0-0.5' Grout intervals: From 0.5 ft. to 22 ft, From ft. to ft, From ft. to ft,

Nearest source of possible contamination: Septic Tank Lateral Lines Pit Privy Livestock Pens Insecticide Storage Sewer Lines Cess Pool Sewage Lagoon Fuel Storage Abandoned Water Well Watertight Sewer Lines Seepage Pit Feedyard Fertilizer Storage Oil Well / Gas Well Other (Specify)

Direction from well? NW Distance from well? ~70 ft

Table with columns: FROM, TO, LITHOLOGIC LOG, FROM, TO, LITHO. LOG (cont.) or PLUGGING INTERVALS. Rows: 0-2 Topsoil, 2-25 Clayey silt, 25-37 Silty clay, 37-40 Medium-coarse sand

Notes: KDHE ID: K&B Pit Stop ; U5-085-00367 Target of monitoring well is shallow groundwater, <20' of grout was installed at the direction of KDHE.

11 CONTRACTOR'S OR LANDOWNER'S CERTIFICATION: This water well was constructed, reconstructed, or plugged under my jurisdiction and was completed on (mo-day-year) 9/21/22 and this record is true to the best of my knowledge and belief. Kansas Water Well Contractor's License No 757 This Water Well Record was completed on (mo-day-year) 10/17/22 under the business name of Larsen & Associates, Inc. Signature

Mail 1 white copy along with a fee of \$5.00 for each constructed well to: Kansas Department of Health and Environment, Bureau of Water, GWTS Section, 1000 SW Jackson St., Suite 420, Topeka, Kansas 66612-1367. Mail one to Water Well Owner and retain one for your records. Telephone 785-296-5524. Visit us at http://www.kdheks.gov/waterwell/index.html KSA 82a-1212

Revised 7/10/2015

Salina

NOTE: Figures exhibited within this report are only to be used within the context of this report. Placement of property lines, wells, structures, and roads is based on the available information from county appraiser maps, surveys, site visits, and/or previous vendor reports and should be considered approximate. Estimated concentration lines represent estimated contaminant concentrations based on data collected during the sampling event. Actual extent or concentration of contamination beyond the sample point is unknown.

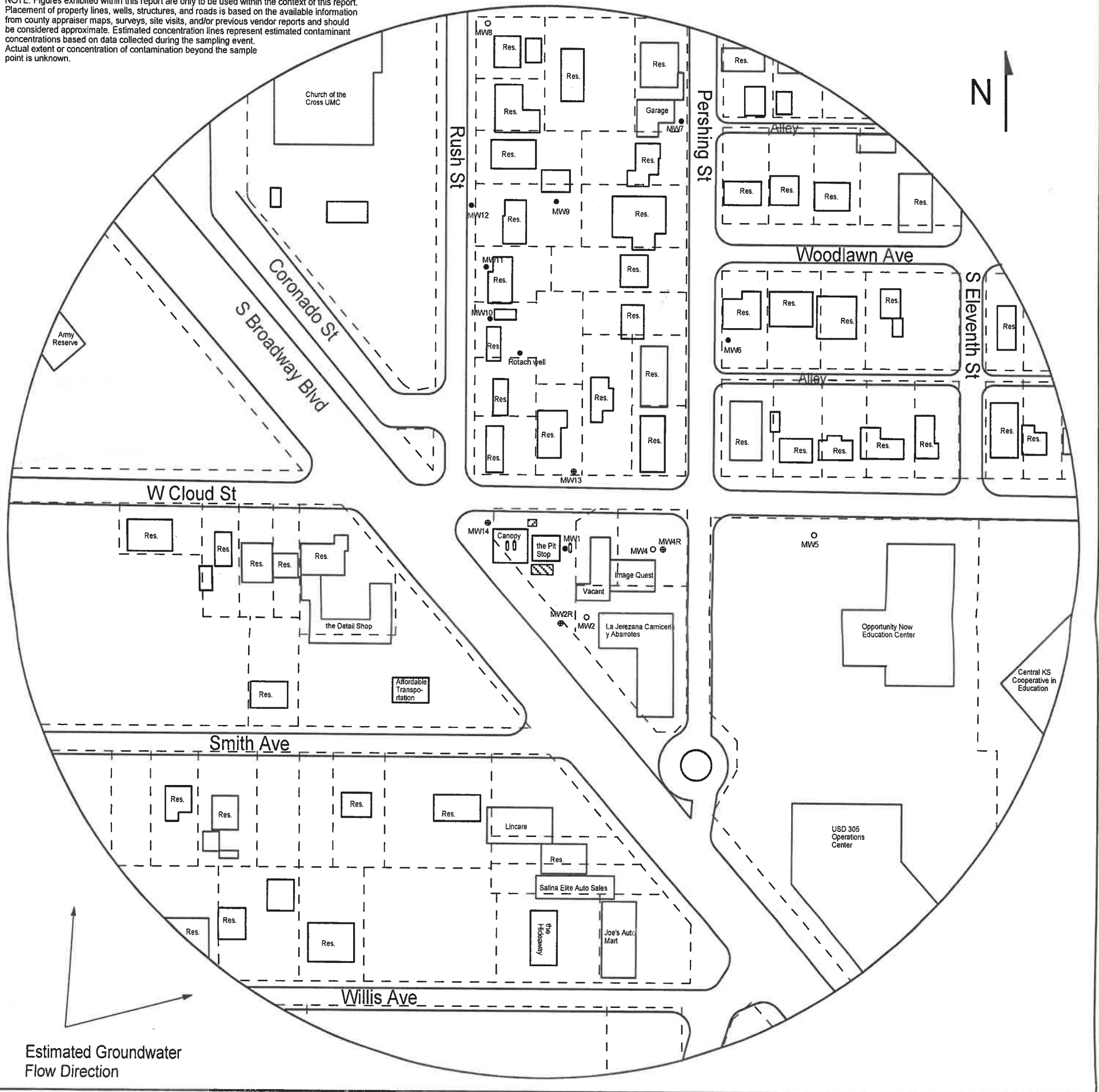

FIGURE 1 - 700 FT RADIUS AREA BASE MAP

- LEGEND**
- Approximate Location of Former UST Basin, & Pump Islands
 - Approximate Location of Active UST Basin, & Pump Islands
 - Building with Basement
 - Approximate Location of Property Line
 - Existing Monitoring Well
 - Plugged Monitoring Well
 - Newly installed Monitoring Well



PROJECT:
 K&B Pit Stop
 647 West Cloud St.
 Salina, KS
 KDHE ID: U5-085-00367
 Date: 9/20-21/22

1311 E 25th St., Suite B 785-841-8707 office
 Lawrence, KS 66046 785-865-4282 fax

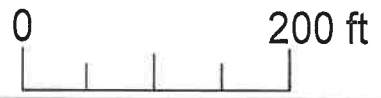

NOTE: Location of product lines is unknown

26-14-3W