

1 LOCATION OF WATER WELL:	Fraction <u>NW 1/4 of NE</u> 1/4 1/4 1/4	Section Number <u>25</u>	Township Number <u>14</u>	Range Number <u>43</u> E/W
County: <u>Wallace</u>				

Distance and direction from nearest town or city street address of well if located within city?  
X

2 WATER WELL OWNER: <u>Purvis Farms Inc</u>	RR #, St. Address, Box #: <u>210 Ironhorse Rd</u> City, State, ZIP Code: <u>Weskan, Ks 67762</u>	Board of Agriculture, Division of Water Resources Application Number: <u>15542</u>
--	---	---

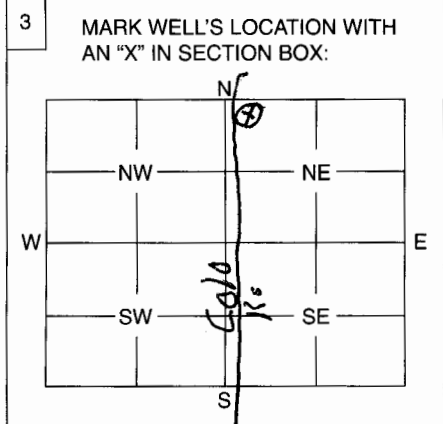

4 DEPTH OF WELL ..... ft. 290'  
WELL'S STATIC WATER LEVEL ..... ft. 285  
WELL WAS USED AS:

1 Domestic	5 Public Water Supply	9 Dewatering
<u>2 Irrigation</u>	6 Oil Field Water Supply	10 Monitoring Well
3 Feedlot	7 Domestic (Lawn & Garden)	11 Injection Well
4 Industrial	8 Air Conditioning	12 Other .....

Was a chemical / bacteriological sample submitted to Department? Yes ..... No X.....  
If yes, mo/day/yr sample was submitted .....

Water Well Disinfected: Yes X..... No .....

5 TYPE OF BLANK CASING USED:

<u>1 Steel</u>	3 RMP (SR)	5 Wrought	7 Fiberglass	9 Other (Specify below)
2 PVC	4 ABS	6 Asbestos-Cement	8 Concrete Tile	.....

Blank casing diameter 16 in. Was casing pulled? Yes ..... No X..... If yes, how much .....

Casing height above or below land surface 48 in.

6 GROUT PLUG MATERIAL: 1 Neat cement 2 Cement grout 3 Bentonite 4 Other .....

Grout Plug Intervals: 3 From 248 ft. to 246 ft., 3 From 5 ft. to 3 ft., From ..... to ..... ft.

What is the nearest source of possible contamination:

<u>1 Septic tank</u>	6 Seepage pit	11 Fuel storage	16 Other (specify below)
2 Sewer lines	7 Pit privy	12 Fertilizer storage	.....
3 Watertight sewer lines	8 Sewage lagoon	13 Insecticide storage	.....
4 Lateral lines	9 Feedyard	14 Abandoned water well	.....
5 Cess pool	10 Livestock pens	15 Oil well/Gas well	.....

Direction from well? East ..... How many feet? 1400 .....

FROM	TO	PLUGGING MATERIALS
<u>290</u>	<u>248</u>	<u>River sand</u>
<u>248</u>	<u>246</u>	<u>clay</u>
<u>246</u>	<u>5'</u>	<u>Sub soil</u>
<u>5'</u>	<u>3'</u>	<u>clay</u>
<u>3</u>	<u>0</u>	<u>Top soil</u>

7 CONTRACTOR'S OF LANDOWNER'S CERTIFICATION: This water well was plugged under my jurisdiction and was completed on (mo/day/year) 8-28-06 ..... and this record is true to the best of my knowledge and belief. Kansas Water Well Contractor's License No. 8-28-06 ..... under the business name of Purvis Farms Inc ..... by (signature) Jamrence Purvis ..... This Water Well Record was completed on (mo/day/year) .....

INSTRUCTIONS: Use typewriter or ball point pen. Please press firmly and print clearly. Please fill in blanks, underline or circle the correct answers. Send top three copies to Kansas Department of Health and Environment, Bureau of Water, Geology Section, 1000 SW Jackson St., Ste. 420, Topeka, Kansas 66612-1367. Telephone: 785/296-5522. Send one to Water Well Owner and retain one for your records.