

WATER WELL RECORD

Form WWC-5

Division of Water Resources App. No.

15335

| | | | | |
|---|------------------------------|----------------------|------------------------|---|
| 1 LOCATION OF WATER WELL: County: Wallace | Fraction ¼ NW ¼ SE ¼ NE ¼ | Section Number 36 | Township No. T 14 S | Range Number R 43 <input type="checkbox"/> E <input checked="" type="checkbox"/> W |
|---|------------------------------|----------------------|------------------------|---|

Street/Rural Address of Well Location; if unknown, distance & direction from nearest town or intersection: If at owner's address, check here .
4 miles west and 6 miles south of Weskan, KS.

Global Positioning System (GPS) information:
Latitude: (in decimal degrees)
Longitude: (in decimal degrees)
Elevation:
Datum: WGS 84, NAD 83, NAD 27
Collection Method:
 GPS unit (Make/Model:)
 Digital Map/Photo, Topographic Map, Land Survey
Est. Accuracy: <3 m, 3-5 m, 5-15 m, >15 m

2 WATER WELL OWNER: Purvis Farms
RR#, Street Address, Box #: 340 Jack Rabbit Rd.
City, State, ZIP Code : Weskan, KS 67762

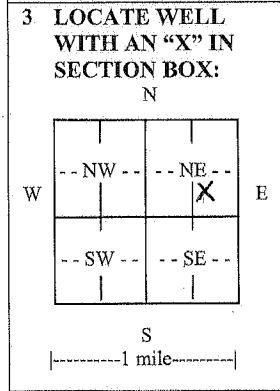

4 DEPTH OF COMPLETED WELL 380 ft.

Depth(s) Groundwater Encountered (1)..... 280 ft. (2)..... ft. (3)..... ft.

WELL'S STATIC WATER LEVEL..... 280ft. below land surface measured on mo/day/yr.....

Pump test data: Well water wasft. after..... hours pumping..... gpm
EST. YIELD. 1000 gpm. Well water wasft. after..... hours pumping..... gpm

Bore Hole Diameter 28in. to 380ft., andin. toft.

WELL WATER TO BE USED AS: Public water supply Geothermal Injection well
 Domestic Feedlot Oil field water supply Dewatering Other (Specify below)
 Irrigation Industrial Domestic-lawn & garden Monitoring well

Was a chemical/bacteriological sample submitted to Department? Yes No
If yes, mo/day/yr sample was submitted.....

Water well disinfected? Yes No

5 TYPE OF CASING USED: Steel PVC Other

CASING JOINTS: Glued Clamped Welded Threaded
Casing diameter 16 in. to 380 ft., Diameter in. to ft., Diameter in. to ft.
Casing height above land surface..... 12 in., Weight lbs./ft., Wall thickness or gauge No. 250

TYPE OF SCREEN OR PERFORATION MATERIAL:
 Steel Stainless Steel PVC Other (Specify)
 Brass Galvanized Steel None used (open hole)

SCREEN OR PERFORATION OPENINGS ARE:
 Continuous slot Mill slot Gauze wrapped Torch cut Drilled holes None (open hole)
 Louvered shutter Key punched Wire wrapped Saw cut Other (specify)

SCREEN-PERFORATED INTERVALS: From..... 380 ft. to 300 ft., From ft. to ft.
From ft. to ft., From ft. to ft.

GRAVEL PACK INTERVALS: From..... 380 ft. to 20 ft., From ft. to ft.
From ft. to ft., From ft. to ft.

6 GROUT MATERIAL: Neat cement Cement grout Bentonite Other

Grout Intervals: From 20 ft. to 0 ft., From ft. to ft., From ft. to ft.

What is the nearest source of possible contamination:
 Septic tank Lateral lines Pit privy Livestock pens Insecticide storage Other (specify below)
 Sewer lines Cesspool Sewage lagoon Fuel storage Abandoned water well
 Watertight sewer lines Sepage pit Feedyard Fertilizer storage Oil well/gas well

Direction from well Distance from well ... 3/4 mile west

| FROM | TO | LITHOLOGIC LOG | FROM | TO | LITHO. LOG (cont.) or PLUGGING INTERVALS |
|------|-----|----------------|------|-----|--|
| 141 | 145 | Clay | 353 | 380 | Shale |
| 145 | 168 | Gravel | | | |
| 168 | 196 | Sandy Clay | | | |
| 196 | 231 | Clay | | | |
| 231 | 238 | Gravel medium | | | |
| 238 | 243 | Clay | | | |
| 243 | 263 | Gravel | | | |
| 263 | 305 | Sandy Clay | | | |
| 305 | 326 | Sand | | | |
| 326 | 353 | Gravel Coarse | | | |

7 CONTRACTOR'S OR LANDOWNER'S CERTIFICATION: This water well was constructed, reconstructed, or plugged under my jurisdiction and was completed on (mo/day/year) ... 3-8-13 ... and this record is true to the best of my knowledge and belief. Kansas Water Well Contractor's License No. ... 722 This Water Well Record was completed on (mo/day/year) ... 3-8-13 under the business name of ... Western Sprinklers, Inc. by (signature) *Paul R. Nelson*

INSTRUCTIONS: Use typewriter or ball point pen. PLEASE PRESS FIRMLY and PRINT clearly. Please fill in blanks and check the correct answers. Send three copies (white, blue, pink) to Kansas Department of Health and Environment, Bureau of Water, Geology Section, 1000 SW Jackson St., Suite 420, Topeka, Kansas 66612-1367. Telephone 785-296-5524. Send one copy to WATER WELL OWNER and retain one for your records. Include fee of \$5.00 for each constructed well. Visit us at <http://www.kdheks.gov/waterwell/index.html>.