

WATER WELL RECORD

Form WWC-5

Division of Water Resources App. No.

1 LOCATION OF WATER WELL: County: Ellsworth, Fraction: 1/4 NE 1/4 NW 1/4 NE 1/4, Section Number: 11, Township No.: T14 S, Range Number: R8

Street/Rural Address of Well Location; if unknown, distance & direction from nearest town or intersection: 8 miles North & 3 miles East of Ellsworth, KS. Global Positioning System (GPS) information: Latitude, Longitude, Elevation, Datum, Collection Method.

2 WATER WELL OWNER: Koss Construction, RR#, Street Address, Box #: 5830 SW Drury Lane, City, State, ZIP Code: Topeka, KS 66604

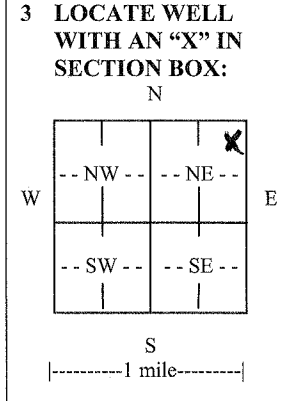

3 LOCATE WELL WITH AN 'X' IN SECTION BOX: N, W, E, S. 4 DEPTH OF COMPLETED WELL: 240 ft. Depth(s) Groundwater Encountered, WELL'S STATIC WATER LEVEL: 1.34 ft. below land surface, Pump test data, EST. YIELD: 100 gpm, Bore Hole Diameter: 12 in. to 240 ft., WELL WATER TO BE USED AS: Road Construction, Was a chemical/bacteriological sample submitted? No, Water well disinfected? Yes

5 TYPE OF CASING USED: PVC, CASING JOINTS: Glued, Casing diameter: .8 in. to 200 ft., Casing height above land surface: 12 in., Weight: 5.72 lbs./ft., Wall thickness or gauge No.: 332, TYPE OF SCREEN OR PERFORATION MATERIAL: PVC, SCREEN OR PERFORATION OPENINGS ARE: Mill slot, SCREEN-PERFORATED INTERVALS: 200 ft. to 240 ft., GRAVEL PACK INTERVALS: 20 ft. to 240 ft.

6 GROUT MATERIAL: Bentonite, Grout Intervals: 0 ft. to 20 ft., What is the nearest source of possible contamination: None within 1/4 mile, Direction from well, Distance from well

Table with columns: FROM, TO, LITHOLOGIC LOG, FROM, TO, LITHO. LOG (cont.) or PLUGGING INTERVALS. Rows include Topsoil, Shale (hard white, gray), Sandstone (tan), Shale (red), and hard rock.

7 CONTRACTOR'S OR LANDOWNER'S CERTIFICATION: This water well was constructed, reconstructed, or plugged under my jurisdiction and was completed on (mo/day/year) 6/14/11 and this record is true to the best of my knowledge and belief. Kansas Water Well Contractor's License No. 138. This Water Well Record was completed on (mo/day/year) 6/24/11 under the business name of Peterson Irrigation, Inc. by (signature) Mike Peterson

INSTRUCTIONS: Use typewriter or ball point pen. PLEASE PRESS FIRMLY and PRINT clearly. Please fill in blanks and check the correct answers. Send three copies (white, blue, pink) to Kansas Department of Health and Environment, Bureau of Water, Geology Section, 1000 SW Jackson St., Suite 420, Topeka, Kansas 66612-1367. Telephone 785-296-5522. Send one copy to WATER WELL OWNER and retain one for your records. Include fee of \$5.00 for each constructed well. Visit us at http://www.kdheks.gov/waterwell/index.html.