

WATER WELL PLUGGING RECORD Form WWC-5P

KSA 82a-1212

ID NO.

MW-4

1 LOCATION OF WATER WELL: County: <u>Saline</u>	Fraction <u>NE 1/4 SW 1/4 NW 1/4 NW 1/4</u>	Section Number <u>12</u>	Township Number <u>T 15 S</u>	Range Number <u>3</u> <input type="checkbox"/> E <input checked="" type="checkbox"/> W
---	--	-----------------------------	----------------------------------	---

Street/Rural Address of Well Location; if unknown, distance & direction from nearest town or intersection: If at owner's address, check here Approx. 750 ft. S. of intersection of S. 9th St. & Water Well Road & approx. 300 ft. east Salina, Ks.

Global Positioning Systems (GPS) information:
 Latitude: 38.766944 (in decimal degrees)
 Longitude: -97.611666 (in decimal degrees)
 Elevation: NA
 Horizontal Datum: WGS84, NAD83, NAD27
 Collection Method:

2 WATER WELL OWNER: Great Plains Mfg. No. 2 LLC
 RR#, St. Address, Box #: 1525 E. North St.
 City, State ZIP Code: Salina, Ks. 67401

GPS unit (Make/Model): _____
 Digital Map/Photo, Topographic Map, Land Survey
 Est. Accuracy: < 3 m, 3-5 m, 5-15 m, > 15 m

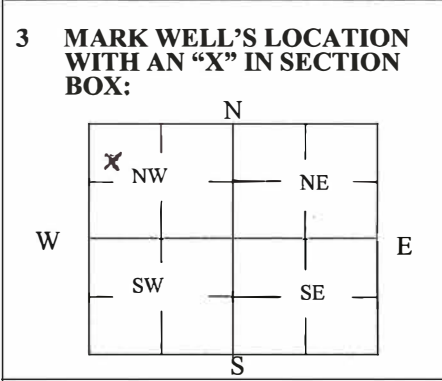

4 DEPTH OF WELL 24.7 ft.
 WELL'S STATIC WATER LEVEL 20.3 ft

WELL WAS USED AS:

<input type="checkbox"/> Domestic	<input type="checkbox"/> Public Water Supply	<input type="checkbox"/> Dewatering
<input type="checkbox"/> Irrigation	<input type="checkbox"/> Oil Field Water Supply	<input checked="" type="checkbox"/> Monitoring
<input type="checkbox"/> Feedlot	<input type="checkbox"/> Domestic (Lawn & Garden)	<input type="checkbox"/> Injection Well
<input type="checkbox"/> Industrial	<input type="checkbox"/> Air Conditioning	<input type="checkbox"/> Other _____

Was a chemical/bacteriological sample submitted to Department? Yes No

5 TYPE OF BLANK CASING USED:

<input type="checkbox"/> Steel	<input type="checkbox"/> RMP (SR)	<input type="checkbox"/> Wrought	<input type="checkbox"/> Fiberglass	<input type="checkbox"/> Other (Specify below) _____
<input checked="" type="checkbox"/> PVC	<input type="checkbox"/> ABS	<input type="checkbox"/> Asbestos-Cement	<input type="checkbox"/> Concrete Tile	

Blank casing diameter 2 in. Was casing pulled? Yes No If yes, how much 3 ft.
 Casing height above or below land surface -36 in.

6 GROUT PLUG MATERIAL: Neat cement Cement grout Bentonite Other _____

Grout Plug Intervals: From 0 ft. to 24.7 ft., From _____ ft. to _____ ft., From _____ ft. to _____ ft.

What is the nearest source of possible contamination:

<input type="checkbox"/> Septic tank	<input type="checkbox"/> Seepage pit	<input type="checkbox"/> Fuel storage	<input checked="" type="checkbox"/> Other (specify below) _____
<input type="checkbox"/> Sewer lines	<input type="checkbox"/> Pit privy	<input type="checkbox"/> Fertilizer storage	<input type="checkbox"/> contaminated site
<input type="checkbox"/> Watertight sewer lines	<input type="checkbox"/> Sewage lagoon	<input type="checkbox"/> Insecticide storage	
<input type="checkbox"/> Lateral lines	<input type="checkbox"/> Feedyard	<input type="checkbox"/> Abandoned water well	Direction from well? _____
<input type="checkbox"/> Cess pool	<input type="checkbox"/> Livestock pens	<input type="checkbox"/> Oil well/Gas well	How many feet? _____

FROM	TO	PLUGGING MATERIALS	FROM	TO	PLUGGING MATERIALS
0	24.7	Bentonite			

7 CONTRACTOR'S OR LANDOWNER'S CERTIFICATION: This water well was plugged under my jurisdiction and was completed on (mo/day/year) 5/1/23 and this record is true to the best of my knowledge and belief. Kansas Water Well Contractor's License No. 604. This Water Well Record was completed on (mo/day/year) 5/5/23 under the business name of Enviormental Priority Service, Inc. by (signature) [Signature]

Send one white copy to Kansas Department of Health & Environment, Geology Section, 1000 SW Jackson Street, Ste. 420, Topeka, KS 66612-1367. Send one copy to WATER WELL OWNER and retain one for your records.
 Visit us at <http://www.kdheks.gov/waterwell/index.html> Telephone 785-296-5524.

T. 15 R. 3W Sec. 12
Saline County

CITY: LITV D:\GROUP\ENV\CAD 08ENV.CAD
C:\Users\jdoyle\ArcGIS\Environmental\CAD Team - BM360 - OneDrive Sync Location\AUS-PIRUPS LIGHTING SIGNIFY NORTH AMERICA\SALINAS California\Project Files\2021\1\Proposed\01.DWG\PE-Signify_NA_Salinas.dwg LAYOUT: 3 SAVED: 5/6/2022 10:12 AM PAGESETUP: --
PLOTFILETABLE.PLT\FULL.DTB PLOTTED: 5/6/2022 10:14 AM BY: LOVING, JEFF

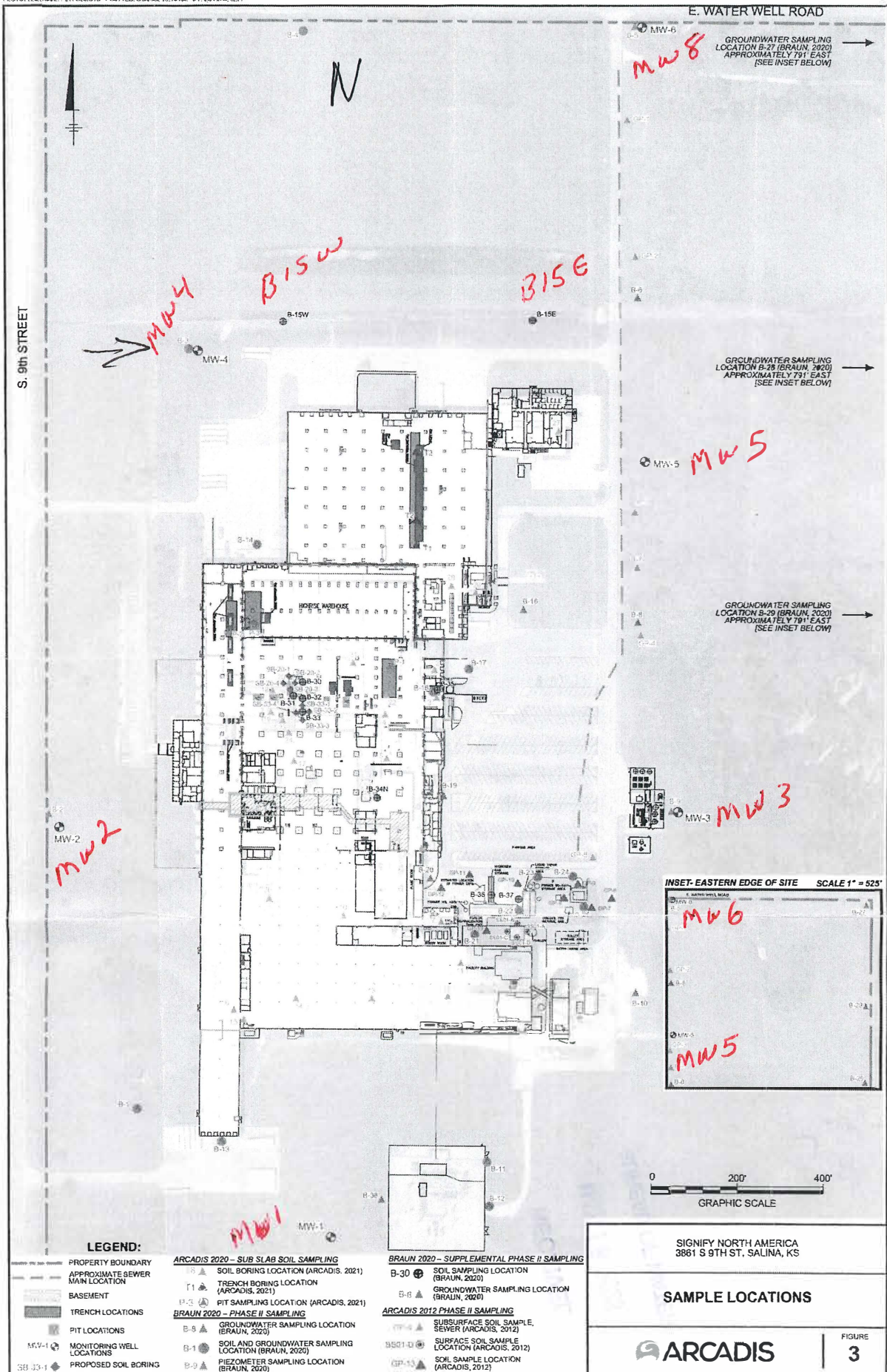

LEGEND:	
	PROPERTY BOUNDARY
	APPROXIMATE SEWER MAIN LOCATION
	BASEMENT
	TRENCH LOCATIONS
	PIT LOCATIONS
	MW-1 MONITORING WELL LOCATIONS
	PROPOSED SOIL BORING
	ARCADIS 2020 - SUB SLAB SOIL SAMPLING
	SOIL BORING LOCATION (ARCADIS, 2021)
	TRENCH BORING LOCATION (ARCADIS, 2021)
	PIT SAMPLING LOCATION (ARCADIS, 2021)
	BRAUN 2020 - PHASE II SAMPLING
	GROUNDWATER SAMPLING LOCATION (BRAUN, 2020)
	SOIL AND GROUNDWATER SAMPLING LOCATION (BRAUN, 2020)
	PIEZOMETER SAMPLING LOCATION (BRAUN, 2020)
	BRAUN 2020 - SUPPLEMENTAL PHASE II SAMPLING
	SOIL SAMPLING LOCATION (BRAUN, 2020)
	GROUNDWATER SAMPLING LOCATION (BRAUN, 2020)
	ARCADIS 2012 PHASE II SAMPLING
	SUBSURFACE SOIL SAMPLE, SEWER (ARCADIS, 2012)
	SURFACE SOIL SAMPLE LOCATION (ARCADIS, 2012)
	SOIL SAMPLE LOCATION (ARCADIS, 2012)

INSET - EASTERN EDGE OF SITE SCALE 1" = 525'

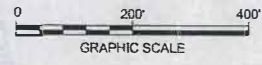

SIGNIFY NORTH AMERICA
3861 S 9TH ST, SALINA, KS

SAMPLE LOCATIONS

ARCADIS

FIGURE
3