

USE TYPEWRITER OR BALL POINT PEN-PRESS FIRMLY, PRINT CLEARLY.

WATER WELL RECORD
KSA 82a-1201-1215

Kansas Department of Health and Environment-Division of Environment
(Water well Contractors)
Topeka, Kansas 66620

1. Location of well:	County Greeley	Fraction NW 1/4 SE 1/4 SE 1/4	Section number 3	Township number T 16 S R 40 E	Range number 40
----------------------	--------------------------	---	----------------------------	---	---------------------------

2. Distance and direction from nearest town or city: 16N, 1E, 3/4S, Street address of well location if in city: 3/4E of Tribune, KS	3. Owner of well: Smith Ranch R.R. or street: Tribune, KS 67879 City, state, zip code:
--	--

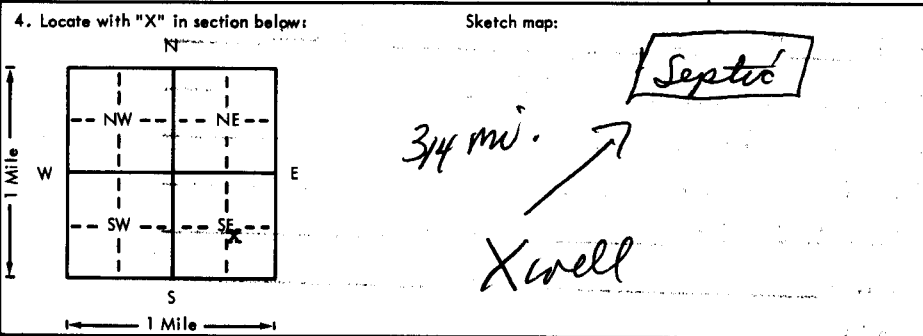

6. Bore hole dia. 26 in. Completion date _____ Well depth 195 ft. 11-5-75
7. Cable tool <input type="checkbox"/> Rotary <input type="checkbox"/> Driven <input type="checkbox"/> Dug <input type="checkbox"/> Hollow rod <input type="checkbox"/> Jetted <input type="checkbox"/> Bored <input checked="" type="checkbox"/> Reverse rotary
8. Use: Domestic <input type="checkbox"/> Public supply <input type="checkbox"/> Industry <input checked="" type="checkbox"/> Irrigation <input type="checkbox"/> Air conditioning <input type="checkbox"/> Stock <input type="checkbox"/> Lawn <input type="checkbox"/> Oil field water <input type="checkbox"/> Other
9. Casing: Material Steel Height Above or below Threaded <input type="checkbox"/> Welded <input checked="" type="checkbox"/> Surface 10 in. RMP <input type="checkbox"/> PVC <input type="checkbox"/> Weight 31.67 lbs./ft. Dia. 16 in. to 195 ft. depth. Wall Thickness: inches or Dia. _____ in. to _____ ft. depth. Loge No. 188

5. Type and color of material	From	To
Clay	0	43
Sd coarse	43	52
Clay	52	60
Sd coarse	60	69
Fine sd clay	69	81
Sd rock	81	88
Fine sd clay	88	100
Sd rock	100	104
Fine sd clay	104	135
Sd coarse	135	140
Clay	140	153
Fine sd clay	153	170
Sd coarse	170	191
Clay yellow	191	197
Shale	197	200

10. Screen: Manufacturer's name Free Flow Type Prime Steel Dia. 16 in. Slot gauze .125 Length 40 ft. Set between 155 ft. and 195 ft. ft. and _____ ft. Gravel pack? yes Size range of material 3/4-1/2
11. Static water level: _____ mo./day/yr. 107 ft. below land surface Date 10-7-75
12. Pumping level below land surfaces: 166 ft. after 4 hrs. pumping 1530 g.p.m. 172 ft. after 4 hrs. pumping 1600 g.p.m. Estimated maximum yield 1600 g.p.m.
13. Water sample submitted: _____ mo./day/yr. Yes <input checked="" type="checkbox"/> No <input type="checkbox"/> Date _____
<input checked="" type="checkbox"/> Well head completion: <input type="checkbox"/> Pitless adapter 12 inches above grade <input checked="" type="checkbox"/> Well grouted? _____ With: <input type="checkbox"/> Neat cement <input type="checkbox"/> Bentonite <input checked="" type="checkbox"/> Concrete Depth: From 0 ft. to 10 ft.
16. Nearest source of possible contamination: ft. 3960 Direction NE Type Septic Well disinfected upon completion? <input checked="" type="checkbox"/> Yes <input type="checkbox"/> No
17. Pump: _____ Not installed Manufacturer's name Western Land Roller Model number GE HP 75 Volts 460 Length of drop pipe 180 ft. capacity 1600 g.p.m. Type: <input type="checkbox"/> Submersible <input checked="" type="checkbox"/> Turbine <input type="checkbox"/> Jet <input type="checkbox"/> Reciprocating <input type="checkbox"/> Centrifugal <input type="checkbox"/> Other

18. Elevation:	19. Remarks:
Topography: <input type="checkbox"/> Hill <input type="checkbox"/> Slope <input checked="" type="checkbox"/> Upland <input type="checkbox"/> Valley	

20. Water well contractor's certification: This well was drilled under my jurisdiction and this report is true to the best of my knowledge and belief. Weishaar Drilling 232 Business name License No. Address: 232 1/2 E. 1st St., KS 67871 Signature: _____ Date: 7-20-76 Authorized representative

T
R
E
S
E
C
1
6
4
0
3
NW
SE
1/4
1/4
1/4