

WATER WELL RECORD Form WWC-5

Division of Water Resources App. No.

ESMW-8

Original Record Correction Change in Well Use

Well ID

1 LOCATION OF WATER WELL: County: Barton Fraction SE 1/4 SE 1/4 SW 1/4 SW 1/4 Section Number 34 Township Number T 17 S Range Number R 11 E W

2 WELL OWNER: Last Name: Business: KDHE BER Address: 1000 SW Jackson St., Ste. 410 City: Topeka State: KS ZIP: 66612 Street or Rural Address where well is located (if unknown, distance and direction from nearest town or intersection): Approx. 265' S, 15' E of NE corner of intersection of K-4 & A St. - Claflin, KS

3 LOCATE WELL WITH "X" IN SECTION BOX: N W E S

4 DEPTH OF COMPLETED WELL: 35 ft. Depth(s) Groundwater Encountered: 1) 25 ft. 2) 25.4 ft. 3) ft. 4) Dry Well WELL'S STATIC WATER LEVEL: 25.54 ft. below land surface, measured on (mo-day-yr) 04/13/2020

5 Latitude: 38.52194 (decimal degrees) Longitude: 98.53200 (decimal degrees) Datum: WGS 84 NAD 83 NAD 27 Source for Latitude/Longitude: Land Survey Topographic Map Online Mapper

6 Elevation: 1805.87 ft. Ground Level TOC Source: Land Survey GPS Topographic Map Other

7 WELL WATER TO BE USED AS: 1. Domestic: Household Lawn & Garden Livestock Irrigation Feedlot Industrial 5. Public Water Supply: well ID 6. Dewatering: how many wells? 7. Aquifer Recharge: well ID 8. Monitoring: well ID ESMW-8 9. Environmental Remediation: well ID Air Sparge Soil Vapor Extraction Recovery Injection 10. Oil Field Water Supply: lease 11. Test Hole: well ID Cased Uncased Geotechnical 12. Geothermal: how many bores? a) Closed Loop Horizontal Vertical b) Open Loop Surface Discharge Inj. of Water 13. Other (specify):

Was a chemical/bacteriological sample submitted to KDHE? Yes No If yes, date sample was submitted: Water well disinfected? Yes No

8 TYPE OF CASING USED: Steel PVC Other CASING JOINTS: Glued Clamped Welded Threaded Casing diameter 2 in. to 20 ft., Diameter in. to ft., Diameter in. to ft. Casing height above land surface 0 in. Weight lbs./ft. Wall thickness or gauge No. 40 TYPE OF SCREEN OR PERFORATION MATERIAL: Steel Stainless Steel PVC Other (Specify) Brass Galvanized Steel None used (open hole) SCREEN OR PERFORATION OPENINGS ARE: Continuous Slot Mill Slot Gauze Wrapped Torch Cut Drilled Holes Other (Specify) Louvered Shutter Key Punched Wire Wrapped Saw Cut None (Open Hole) SCREEN-PERFORATED INTERVALS: From 20 ft. to 35 ft., From ft. to ft., From ft. to ft. GRAVEL PACK INTERVALS: From 18 ft. to 35 ft., From ft. to ft., From ft. to ft.

9 GROUT MATERIAL: Neat cement Cement grout Bentonite Other Grout Intervals: From 3 ft. to 18 ft., From ft. to ft., From ft. to ft. Nearest source of possible contamination: No potential source of contamination within 200 ft. Septic Tank Lateral Lines Pit Privy Livestock Pens Insecticide Storage Sewer Lines Cess Pool Sewage Lagoon Fuel Storage Abandoned Water Well Watertight Sewer Lines Seepage Pit Feedyard Fertilizer Storage Oil Well/Gas Well Other (Specify) Direction from well? North-northeast Distance from well? 145 ft.

Table with 6 columns: 10 FROM, TO, LITHOLOGIC LOG, FROM, TO, LITHO. LOG (cont.) or PLUGGING INTERVALS. Row 1: 0, 35, Lean Clay, dk brn to rd, sandy, , , , , . Notes section below.

11 CONTRACTOR'S OR LANDOWNER'S CERTIFICATION: This water well was constructed, reconstructed, or plugged under my jurisdiction and was completed on (mo-day-year) 03/30/2020 and this record is true to the best of my knowledge and belief. Kansas Water Well Contractor's License No. 531 This Water Well Record was completed on (mo-day-year) 06/03/2020 under the business name of GSI Engineering, LLC

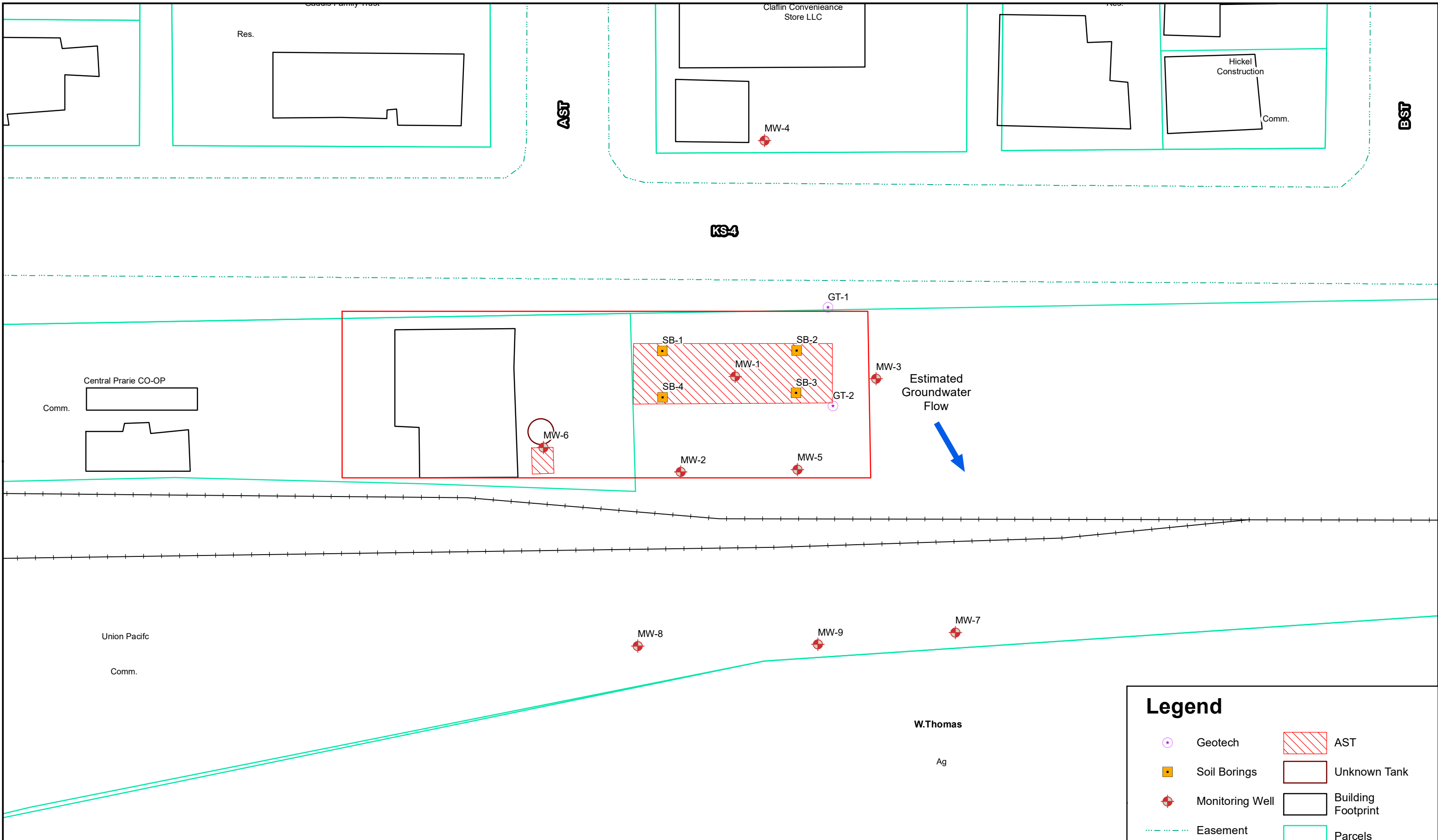

	FIGURE: <b>2.0</b>	FIGURE NAME: <b>Site Base Map</b>	<b>Essmiller Oil Co.</b> <b>Clafin, KS</b> <b>KDHE#: A6-005-40491</b>	 <b>1 in = 50 feet</b>	
	DATE: 4/26/20	PROJECT NUMBER: <b>1974116</b>			
	DRAWN BY: <b>CN</b>	PROJECT MANAGER: A. Chadd			

### Legend

	Geotech		AST
	Soil Borings		Unknown Tank
	Monitoring Well		Building Footprint
	Easement		Parcels
	Railroad		Site Boundary

*PRODUCT LINE LOCATIONS UNKNOWN*  
 ALL BOUNDARIES AND LOCATIONS ARE APPROXIMATE