

WATER WELL RECORD Form WWC-5

Original Record Correction Change in Well Use

Division of Water Resources App. No.

Well ID

1 LOCATION OF WATER WELL: County: _____	Fraction ¼ ¼ ¼ ¼	Section Number	Township Number T S	Range Number R E W	
2 WELL OWNER: Last Name: _____ First: _____ Business: _____ Address: _____ Address: _____ City: _____ State: _____ ZIP: _____		Street or Rural Address where well is located (if unknown, distance and direction from nearest town or intersection): If at owner's address, check here: <input type="checkbox"/>			
3 LOCATE WELL WITH "X" IN SECTION BOX: N  S -----1 mile-----	4 DEPTH OF COMPLETED WELL: ft. Depth(s) Groundwater Encountered: 1) ft. 2) ft. 3) ft., or 4) <input type="checkbox"/> Dry Well WELL'S STATIC WATER LEVEL: ft. <input type="checkbox"/> below land surface, measured on (mo-day-yr)..... <input type="checkbox"/> above land surface, measured on (mo-day-yr)..... Pump test data: Well water was ft. after hours pumping gpm Well water was ft. after hours pumping gpm Estimated Yield:gpm Bore Hole Diameter: in. to ft. and in. to ft.		5 Latitude:(decimal degrees) Longitude:(decimal degrees) Datum: <input type="checkbox"/> WGS 84 <input type="checkbox"/> NAD 83 <input type="checkbox"/> NAD 27 Source for Latitude/Longitude: <input type="checkbox"/> GPS (unit make/model:) (WAAS enabled? <input type="checkbox"/> Yes <input type="checkbox"/> No) <input type="checkbox"/> Land Survey <input type="checkbox"/> Topographic Map <input type="checkbox"/> Online Mapper:		
	7 WELL WATER TO BE USED AS: 1. Domestic: <input type="checkbox"/> Household <input type="checkbox"/> Lawn & Garden <input type="checkbox"/> Livestock 2. <input type="checkbox"/> Irrigation 3. <input type="checkbox"/> Feedlot 4. <input type="checkbox"/> Industrial 5. <input type="checkbox"/> Public Water Supply: well ID 6. <input type="checkbox"/> Dewatering: how many wells? 7. <input type="checkbox"/> Aquifer Recharge: well ID 8. <input type="checkbox"/> Monitoring: well ID 9. Environmental Remediation: well ID <input type="checkbox"/> Air Sparge <input type="checkbox"/> Soil Vapor Extraction <input type="checkbox"/> Recovery <input type="checkbox"/> Injection 10. <input type="checkbox"/> Oil Field Water Supply: lease 11. Test Hole: well ID <input type="checkbox"/> Cased <input type="checkbox"/> Uncased <input type="checkbox"/> Geotechnical 12. Geothermal: how many bores? a) Closed Loop <input type="checkbox"/> Horizontal <input type="checkbox"/> Vertical b) Open Loop <input type="checkbox"/> Surface Discharge <input type="checkbox"/> Inj. of Water 13. <input type="checkbox"/> Other (specify):		6 Elevation:ft. <input type="checkbox"/> Ground Level <input type="checkbox"/> TOC Source: <input type="checkbox"/> Land Survey <input type="checkbox"/> GPS <input type="checkbox"/> Topographic Map <input type="checkbox"/> Other		
Was a chemical/bacteriological sample submitted to KDHE? <input type="checkbox"/> Yes <input type="checkbox"/> No If yes, date sample was submitted: Water well disinfected? <input type="checkbox"/> Yes <input type="checkbox"/> No					
8 TYPE OF CASING USED: <input type="checkbox"/> Steel <input type="checkbox"/> PVC <input type="checkbox"/> Other CASING JOINTS: <input type="checkbox"/> Glued <input type="checkbox"/> Clamped <input type="checkbox"/> Welded <input type="checkbox"/> Threaded Casing diameter in. to ft., Diameter in. to ft., Diameter in. to ft. Casing height above land surface in. Weight lbs./ft. Wall thickness or gauge No. TYPE OF SCREEN OR PERFORATION MATERIAL: <input type="checkbox"/> Steel <input type="checkbox"/> Stainless Steel <input type="checkbox"/> PVC <input type="checkbox"/> Other (Specify) <input type="checkbox"/> Brass <input type="checkbox"/> Galvanized Steel <input type="checkbox"/> None used (open hole) SCREEN OR PERFORATION OPENINGS ARE: <input type="checkbox"/> Continuous Slot <input type="checkbox"/> Mill Slot <input type="checkbox"/> Gauze Wrapped <input type="checkbox"/> Torch Cut <input type="checkbox"/> Drilled Holes <input type="checkbox"/> Other (Specify) <input type="checkbox"/> Louvered Shutter <input type="checkbox"/> Key Punched <input type="checkbox"/> Wire Wrapped <input type="checkbox"/> Saw Cut <input type="checkbox"/> None (Open Hole) SCREEN-PERFORATED INTERVALS: From ft. to ft., From ft. to ft., From ft. to ft. GRAVEL PACK INTERVALS: From ft. to ft., From ft. to ft., From ft. to ft.					
9 GROUT MATERIAL: <input type="checkbox"/> Neat cement <input type="checkbox"/> Cement grout <input type="checkbox"/> Bentonite <input type="checkbox"/> Other Grout Intervals: From ft. to ft., From ft. to ft., From ft. to ft. Nearest source of possible contamination: No potential source of contamination within 200 ft. <input type="checkbox"/> Septic Tank <input type="checkbox"/> Lateral Lines <input type="checkbox"/> Pit Privy <input type="checkbox"/> Livestock Pens <input type="checkbox"/> Insecticide Storage <input type="checkbox"/> Sewer Lines <input type="checkbox"/> Cess Pool <input type="checkbox"/> Sewage Lagoon <input type="checkbox"/> Fuel Storage <input type="checkbox"/> Abandoned Water Well <input type="checkbox"/> Watertight Sewer Lines <input type="checkbox"/> Seepage Pit <input type="checkbox"/> Feedyard <input type="checkbox"/> Fertilizer Storage <input type="checkbox"/> Oil Well/Gas Well <input type="checkbox"/> Other (Specify) Direction from well? Distance from well? ft.					
10 FROM	TO	LITHOLOGIC LOG	FROM	TO	LITHO. LOG (cont.) or PLUGGING INTERVALS
			Notes:		
11 CONTRACTOR'S OR LANDOWNER'S CERTIFICATION: This water well was <input type="checkbox"/> constructed, <input type="checkbox"/> reconstructed, or <input type="checkbox"/> plugged under my jurisdiction and was completed on (mo-day-year) and this record is true to the best of my knowledge and belief. Kansas Water Well Contractor's License No. This Water Well Record was completed on (mo-day-year) under the business name of Send one copy to WATER WELL OWNER and retain one for your records. Fee of \$5.00 for each constructed well.					

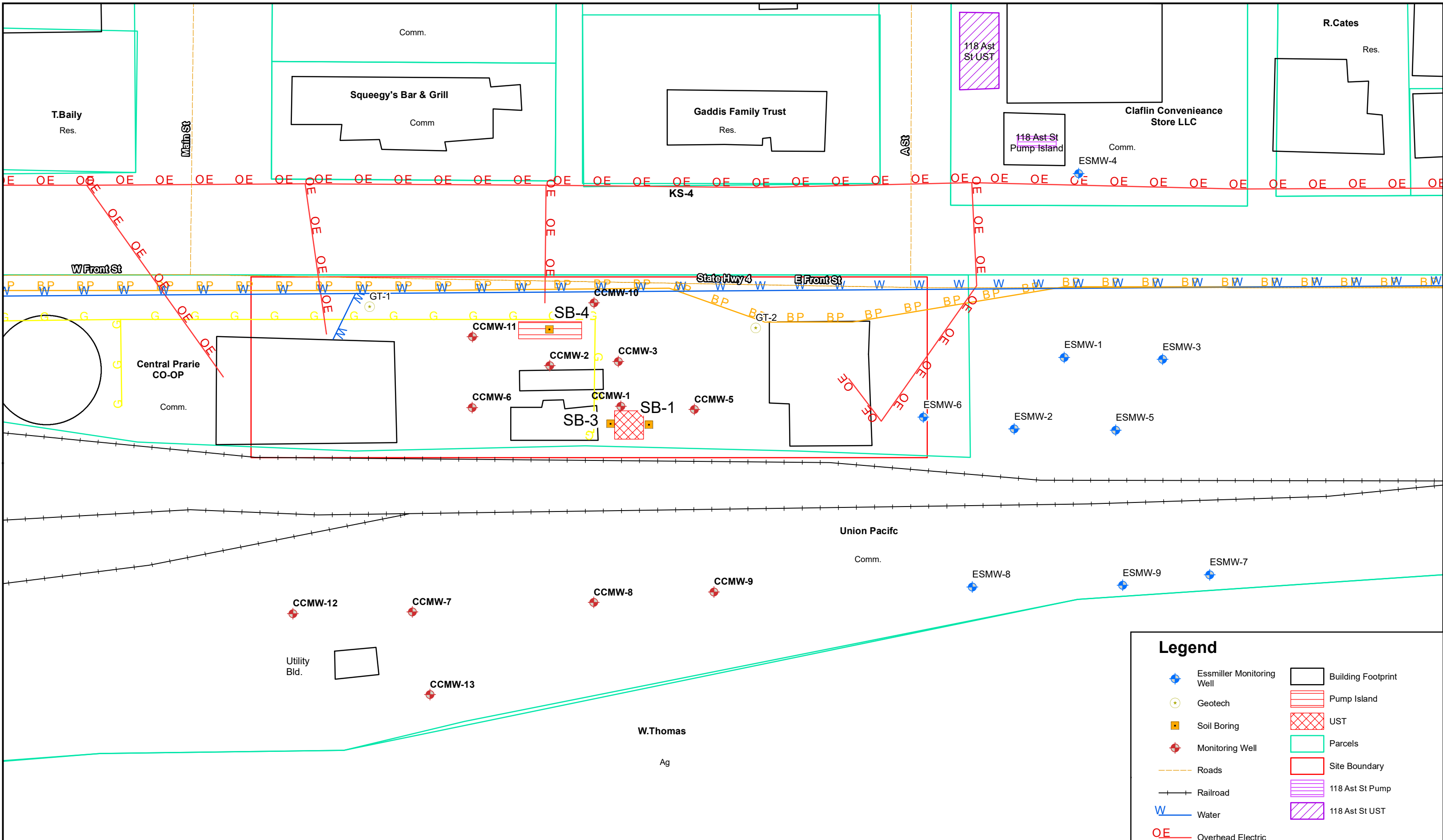

Legend

	Essmiller Monitoring Well		Building Footprint
	Geotech		Pump Island
	Soil Boring		UST
	Monitoring Well		Parcels
	Roads		Site Boundary
	Railroad		118 Ast St Pump
	Water		118 Ast St UST
	Overhead Electric		
	Phone		
	Gas		

PRODUCT LINE LOCATIONS UNKNOWN

ALL BOUNDARIES AND LOCATIONS ARE APPROXIMATE

	FIGURE: 2.2	FIGURE NAME: Site Base Map	Claflin COOP Claflin, KS KDHE#: U6-005-00193	Feet 0 60 1 in = 60 feet	
	DATE: 10/28/2021	PROJECT NUMBER: 1974113			
	DRAWN BY: PM	PROJECT MANAGER: RE			