

WATER WELL RECORD

Form WWC-5

Division of Water Resources App. No.

Well ID

MW5

Original Record Correction Change in Well Ust

1 LOCATION OF WATER WELL: County Barton Fraction NW 1/4 SE 1/4 SW 1/4 SW 1/4 Section Number 34 Township Number T 17 S Range Number R 11 E X W

2 WELL OWNER: Last Name: Business: KDHE Address: 1000 SW Jackson Blvd City Topeka State: KS ZIP: 66612 Street or Rural Address where well is located (if unknown, distance and direction from nearest town or intersection): ~75' NW of 200 E Front St., Claflin, KS

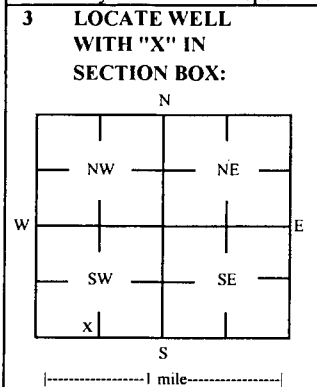

4 DEPTH OF COMPLETED WELL: 35 ft Depth(s) Groundwater Encountered: 1) ft 2) ft 3) ft, or 4) Dry Well WELLS STATIC WATER LEVEL: 27.86 ft. X below land surface, measured on (mo-day-yr) 4/29/22

5 Latitude: 38.52301 (decimal degrees) Longitude: 98.53231 (decimal degrees) Horizontal Datum: WGS 84 NAD 83 NAD 27 Source for Latitude/Longitude: GPS (unit make/model): Land Survey Topographic Map Online Mapper

6 Elevation 1807.33 ft Ground Level X TOC Source X Land Survey GPS Topographic Map Other

7 WELL WATER TO BE USED AS: 1 Domestic: Household Lawn & Garden Livestock Irrigation Feedlot Industrial 5 Public Water Supply: well ID 6 Dewatering: how many wells? 7 Aquifer Recharge: well ID 8 X Monitoring: well ID MW5 9 Environmental Remediation: well ID Air Sparge Soil Vapor Extraction Recovery Injection 10 Oil Field Water Supply: lease 11 Test Hole: well ID Cased Uncased Geotechnical 12 Geothermal: How many bores? a) Closed Loop Horizontal Vertical b) Open Loop Surface Discharge Inj. of Water Other (specify):

Was a chemical/bacteriological sample submitted to KDHE? Yes No X No If yes, date sample was submitted: Water well disinfected? Yes No X No

8 TYPE OF CASING USED: Steel PVC X Other CASING JOINTS: Glued Clamped Welded X Threaded Casing diameter 2 in. to 20 ft. Diameter in. to ft. Diameter in. to ft. Casing height above land surface -0.29 in. Weight lbs./ft. Well thickness or gauge No TYPE OF SCREEN OR PERFORATION MATERIAL: Steel Stainless Steel Fiberglass X PVC Brass Galvanized Steel Concrete tile None used (open hole) SCREEN OR PERFORATION OPENINGS ARE: Continuous Slot X Mill Slot Gauze Wrapped Torch Cut Drilled Holes Other (Specify) Louvered Shutter Key Punched Wire Wrapped Saw Cut None (Open Hole) SCREEN-PERFORATED INTERVALS: From 20 ft. to 35 ft. From ft. to ft. From ft. to ft. GRAVEL PACK INTERVALS: From 18 ft. to 35 ft. From ft. to ft. From ft. to ft.

9 GROUT MATERIAL: Neat cement Cement grout X Bentonite X Other Concrete: 0-0.5' Grout intervals: From 0.5 ft. to 18 ft. From ft. to ft. From ft. to ft.

Nearest source of possible contamination: Septic Tank Lateral Lines Pit Privy Livestock Pens Insecticide Storage Sewer Lines Cess Pool Sewage Lagoon X Fuel Storage Abandoned Water Well Watertight Sewer Lines Seepage Pit Feedyard Fertilizer Storage Oil Well / Gas Well Other (Specify): Direction from well? SE Distance from well? ~150 ft

10 FROM TO LITHOLOGIC LOG FROM TO LITHO. LOG (cont.) or PLUGGING INTERVALS

0	1	Topsoil, clay			
1	20	Silty clay			
20	29	Clay			
29	35	Silt			

Notes: KDHE ID: K-4 Fuel, LLC; U6-005-15448 Target of monitoring well is shallow groundwater, <20' of grout was installed at the direction of KDHE.

11 CONTRACTOR'S OR LANDOWNER'S CERTIFICATION: This water well was X constructed, reconstructed or plugged under my jurisdiction and was completed on (mo-day-year) 4/26/22 and this record is true to the best of my knowledge and belief. Kansas Water Well Contractor's License No 757 This Water Well Record was completed on (mo-day-year) 5/31/22 under the business name of Larsen & Associates, Inc. Signature

Barton

34-17S-11W

DENNIS L HANDKE

1820 NW 59th Terrace
TOPEKA, KANSAS 66618
785-286-4047 Home

Jess Chapman
Larsen & Assoc.
1311 E. 25th Street, Suite B
Lawrence, Kansas, 66046

May 22, 2022

RE: Monitor Well Elevation Survey
200 E. Front St., Claflin, Kansas

Proj. 22-00CC
K-4 Fuel, LLC#12588
U6-005-15448

Bench Mark: Chisled Square on East center of concrete vacuum pad near SE corner of property.

Elev: 1807.57 North 196.57 West 4101.60 (from SE Cor. Sec. 34-17-11W)

MW-1	rim	1806.75	North	233.81	SE1/4,SE1/4,SW1/4,SW1/4
	top pipe	1806.41	West	4244.34	Lat= 38.52266 Long = 98.53216
MW-2	rim	1806.82	North	217.73	SE1/4,SE1/4,SW1/4,SW1/4
	top pipe	1806.54	West	4108.41	Lat= 38.52261 Long = 98.53168
MW-3	rim	1807.95	North	328.69	SE1/4,SE1/4,SW1/4,SW1/4
	top pipe	1807.43	West	4162.34	Lat= 38.52292 Long = 98.53187
MW-4	rim	1805.75	North	200.22	SW1/4,SW1/4,SE1/4,SW1/4
	top pipe	1805.45	West	3918.08	Lat= 38.52256 Long = 98.53102
MW-5	rim	1807.62	North	360.06	NW1/4,SE1/4,SW1/4,SW1/4
	top pipe	1807.33	West	4291.07	Lat= 38.52301 Long = 98.53231
MW-6	rim	1808.31	North	488.02	NE1/4,SE1/4,SW1/4,SW1/4
	top pipe	1807.93	West	4133.36	Lat= 38.52336 Long = 98.53176
MW-7	rim	1808.74	North	328.63	SE1/4,SE1/4,SW1/4,SW1/4
	top pipe	1808.29	West	4489.19	Lat= 38.52293 Long = 98.53301
EMW-4	rim	1806.73	North	213.36	SE1/4,SE1/4,SW1/4,SW1/4
	top pipe	1806.40	West	4173.75	Lat= 38.52260 Long = 98.53191
EMW-17	rim	1806.47	North	200.76	SE1/4,SE1/4,SW1/4,SW1/4
	top pipe	1806.11	West	4237.81	Lat= 38.52257 Long = 98.53213

Lat & Long derived from Claflin 7.5' quad map. WGS84

Elevation established from NGS BM X 195. NAVD 88

If you have any questions, please feel free to call me. Thank you for the opportunity to be of service to you.

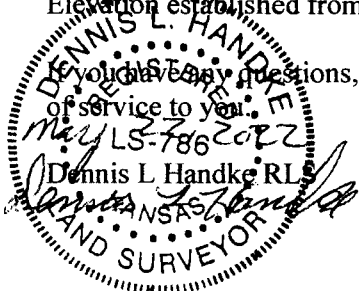

RECEIVED

JUN 07 2022

BUREAU OF WATER

NOTE: Figures exhibited within this report are only to be used within the context of this report. Placement of property lines, wells, structures, and roads is based on the available information from county appraiser maps, surveys, site visits, and/or previous vendor reports and should be considered approximate.

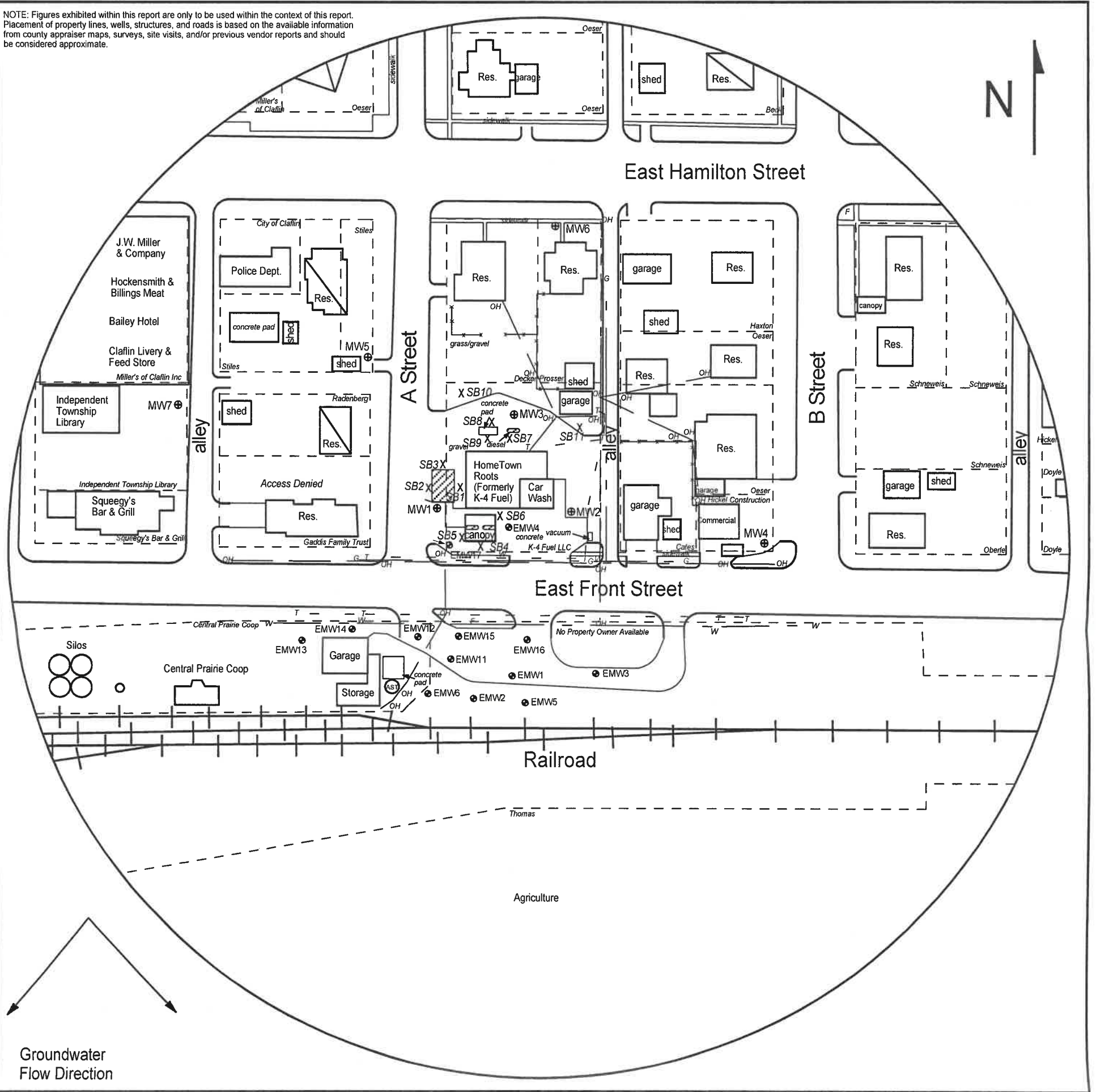

FIGURE 2.1 - 500 FT RADIUS AREA BASE MAP

LEGEND

- Approximate Location of Active UST Basin & Pump Islands
- Building with Basement
- - - - - Approximate Location of Property Line
- Existing Monitoring Well
Essmiller Oil Co (former) A6-005-40491
- New Monitoring Well (installed 4/25,26,28&29/22)
- Soil Boring (drilled 4/26-28/22)
- Fire Hydrant
- Gas Lines (1.5 - 3 ft bgs)
- Overhead Lines (25'-40' high)
- Telephone Lines (2 - 6 ft bgs)
- Water Lines (2 - 6 ft bgs)

NOTE: SB10 & SB11 were drilled to collect hydrologic samples.
NOTE: Utility depths, heights and locations are approximate.



PROJECT:

K-4 Fuel, LLC #12588
200 E. Front Street
Claflin, KS
KDHE ID: U6-005-15448
Date: 4/29/22

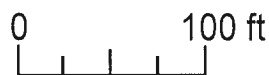

1311 E 25th St., Suite B 785-841-8707 office
Lawrence, KS 66046 785-865-4282 fax