

<b>1 LOCATION OF WATER WELL:</b> County: Barton	Fraction 1/4 SW 1/4 NW 1/4 NW 1/4	Section Number 19	Township No. T 17 S	Range Number R 15 <input type="checkbox"/> E <input checked="" type="checkbox"/> W
Street/Rural Address of Well Location; if unknown, distance & direction from nearest town or intersection: If at owner's address, check here <input type="checkbox"/> Approximately 2 miles north and 1.5 miles east of Otis.		<b>Global Positioning System (GPS) information:</b> Latitude: 38.562377 (in decimal degrees) Longitude: -99.031454 (in decimal degrees) Elevation: Unknown Datum: <input type="checkbox"/> WGS 84, <input checked="" type="checkbox"/> NAD 83, <input type="checkbox"/> NAD 27 Collection Method: <input checked="" type="checkbox"/> GPS unit (Make/Model: WAAS) _____ <input type="checkbox"/> Digital Map/Photo, <input type="checkbox"/> Topographic Map, <input type="checkbox"/> Land Survey Est. Accuracy: <input type="checkbox"/> <3 m, <input checked="" type="checkbox"/> 3-5 m, <input type="checkbox"/> 5-15 m, <input type="checkbox"/> >15 m		

**2 WATER WELL OWNER:** Randy Stos  
 RR#, Street Address, Box #: 1374 NW 140 Ave.  
 City, State, ZIP Code : Otis, KS 67565

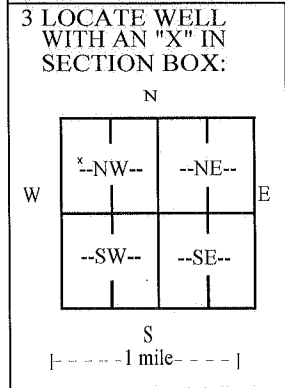

**4 DEPTH OF COMPLETED WELL** 318 ft.

Depth(s) Groundwater Encountered (1) \_\_\_\_\_ ft. (2) \_\_\_\_\_ ft. (3) \_\_\_\_\_ ft.  
 WELL'S STATIC WATER LEVEL 19.40 ft. below land surface measured on mo/day/yr 05/22/13

Pump test data: Well water was not checked ft. after \_\_\_\_\_ hours pumping \_\_\_\_\_ gpm  
 EST. YIELD \_\_\_\_\_ gpm. Well water was \_\_\_\_\_ ft. after \_\_\_\_\_ hours pumping \_\_\_\_\_ gpm  
 Bore Hole Diameter 8 3/4 in. to 320 ft., and \_\_\_\_\_ in. to \_\_\_\_\_ ft.

WELL WATER TO BE USED AS:  Public water supply  Geothermal  Injection well  
 Domestic  Feedlot  Oil field water supply  Dewatering  Other (Specify below) Stock  
 Irrigation  Industrial  Domestic-lawn & garden  Monitoring well  
 Was a chemical/bacteriological sample submitted to Department?  Yes  No  
 If yes, mo/day/yr sample was submitted \_\_\_\_\_  
 Water well disinfected?  Yes  No

**5 TYPE OF CASING USED:**  Steel  PVC  Other \_\_\_\_\_

CASING JOINTS:  Glued  Clamped  Welded  Threaded  
 Casing diameter 5 in. to 179 ft., Diameter 5 in. to 266 ft., Diameter \_\_\_\_\_ in. to \_\_\_\_\_ ft.  
 Casing height above land surface 24 in., Weight 2.87 lbs./ft., Wall thickness or gauge No. 265

TYPE OF SCREEN OR PERFORATION MATERIAL:  
 Steel  Stainless Steel  PVC  Other (Specify) \_\_\_\_\_  
 Brass  Galvanized Steel  None used (open hole)

SCREEN OR PERFORATION OPENINGS ARE:  
 Continuous slot  Mill slot  Gauze wrapped  Torch cut  Drilled holes  None (open hole)  
 Louvered shutter  Key punched  Wire wrapped  Saw cut  Other (specify) \_\_\_\_\_

SCREEN-PERFORATED INTERVALS: From 179 ft. to 189 ft., From 266 ft. to 316 ft.  
 From \_\_\_\_\_ ft. to \_\_\_\_\_ ft., From \_\_\_\_\_ ft. to \_\_\_\_\_ ft.  
 GRAVEL PACK INTERVALS: From 25 ft. to 316 ft., From \_\_\_\_\_ ft. to \_\_\_\_\_ ft.  
 From \_\_\_\_\_ ft. to \_\_\_\_\_ ft., From \_\_\_\_\_ ft. to \_\_\_\_\_ ft.

**6 GROUT MATERIAL:**  Neat cement  Cement grout  Bentonite  Other \_\_\_\_\_

Grout Intervals: From 4 ft. to 25 ft., From \_\_\_\_\_ ft. to \_\_\_\_\_ ft., From \_\_\_\_\_ ft. to \_\_\_\_\_ ft.

What is the nearest source of possible contamination:  
 Septic tank  Lateral lines  Pit privy  Livestock pens  Insecticide storage  Other (specify below) None Known  
 Sewer lines  Cesspool  Sewage lagoon  Fuel storage  Abandoned water well  
 Watertight sewer lines  Seepage pit  Feedyard  Fertilizer storage  Oil well/gas well  
 Direction from well \_\_\_\_\_ Distance from well \_\_\_\_\_

FROM	TO	LITHOLOGIC LOG	FROM	TO	LITHO. LOG (cont.) or PLUGGING INTERVALS
0	2	Topsoil	140	167	Shale, black, clay, brown, gray clay streaks
2	40	Clay, brown	167	169	Shale, black clay, sandstone streaks
40	46	Clay, brown, gray, broken limestone	169	186	Shale, black, clay
46	102	Shale, black, clay, hard, gray, limestone streaks	186	190	Clay, gray, sandstone streaks
			190	191	Limestone, gray, hard
102	105	Clay, black, shale, sandstone streaks	191	237	Clay, gray, an occasional sandstone streak
105	109	Shale, black, clay	237	239	Shale, black
109	110	Limestone, gray, hard	239	290	Clay, gray, an occasional sandstone streak
110	140	Clay, brown, black shale, gray, limestone streaks, hard	290	317	Clay, gray, sandstone streaks
			317	320	Clay, red, hard, gray, limestone

**7 CONTRACTOR'S OR LANDOWNER'S CERTIFICATION:** This water well was  constructed,  reconstructed, or  plugged under my jurisdiction and was completed on (mo/day/year) 05/22/13 and this record is true to the best of my knowledge and belief.  
 Kansas Water Well Contractor's License No. 185 This Water Well Record was completed on (mo/day/year) 05/31/13  
 under the business name of Clarke Well & Equipment, Inc. by (signature) \_\_\_\_\_

INSTRUCTIONS: Use typewriter or ball point pen. PLEASE PRESS FIRMLY and PRINT clearly. Please fill in blanks and check the correct answers. Send three copies (white, blue, pink) to Kansas Department of Health and Environment, Bureau of Water, Geology Section, 1000 SW Jackson St., Suite 420, Topeka, Kansas 66612-1367. Telephone 785-296-5522. Send one copy to WATER WELL OWNER and retain one for your records. Include fee of \$5.00 for each constructed well. Visit us at <http://www.kdheks.gov/waterwell/index.html>.