

WATER WELL RECORD Form WWC-5

Original Record Correction Change in Well Use

Division of Water Resources App. No.

Well ID MW14

1 LOCATION OF WATER WELL: County: RUSH Fraction NW 1/4 NE 1/4 SW 1/4 SE 1/4 Section Number 20 Township Number T 17 S Range Number R 19 E W

2 WELL OWNER: Last Name: MORAN First: PAUL Street or Rural Address where well is located (if unknown, distance and direction from nearest town or intersection): If at owner's address, check here:
 Business: Address: RR1, BOX 108
 Address: City: HARGRAVE State: KS ZIP: 67556

3 LOCATE WELL WITH "X" IN SECTION BOX:

N

W	NW	NE	E
SW	SE		
	S		

-----1 mile-----

4 DEPTH OF COMPLETED WELL: 40 ft.
 Depth(s) Groundwater Encountered: 1) 20 ft.
 2) ft. 3) ft., or 4) Dry Well
WELL'S STATIC WATER LEVEL: 26.73 ft.
 below land surface, measured on (mo-day-yr) 11/27/18
 above land surface, measured on (mo-day-yr)
 Pump test data: Well water was ft.
 after hours pumping gpm
 Well water was ft.
 after hours pumping gpm
 Estimated Yield: gpm
 Bore Hole Diameter: 8.5 in. to 40 ft. and
 in. to ft.

5 Latitude: 38.55601 (decimal degrees)
Longitude: 99.44487 (decimal degrees)
Horizontal Datum: WGS 84 NAD 83 NAD 27
Source for Latitude/Longitude:
 GPS (unit make/model:)
 (WAAS enabled? Yes No)
 Land Survey Topographic Map
 Online Mapper:
6 Elevation: 2176.01 ft. Ground Level TOC
Source: Land Survey GPS Topographic Map
 Other

7 WELL WATER TO BE USED AS:

1. Domestic: <input type="checkbox"/> Household <input type="checkbox"/> Lawn & Garden <input type="checkbox"/> Livestock 2. <input type="checkbox"/> Irrigation 3. <input type="checkbox"/> Feedlot 4. <input type="checkbox"/> Industrial	5. <input type="checkbox"/> Public Water Supply: well ID 6. <input type="checkbox"/> Dewatering: how many wells? 7. <input type="checkbox"/> Aquifer Recharge: well ID 8. <input checked="" type="checkbox"/> Monitoring: well ID MW14 9. Environmental Remediation: well ID <input type="checkbox"/> Air Sparge <input type="checkbox"/> Soil Vapor Extraction <input type="checkbox"/> Recovery <input type="checkbox"/> Injection	10. <input type="checkbox"/> Oil Field Water Supply: lease 11. Test Hole: well ID <input type="checkbox"/> Cased <input type="checkbox"/> Uncased <input type="checkbox"/> Geotechnical 12. Geothermal: how many bores? a) Closed Loop <input type="checkbox"/> Horizontal <input type="checkbox"/> Vertical b) Open Loop <input type="checkbox"/> Surface Discharge <input type="checkbox"/> Inj. of Water 13. <input type="checkbox"/> Other (specify):
---	--	---

Was a chemical/bacteriological sample submitted to KDHE? Yes No If yes, date sample was submitted:
 Water well disinfected? Yes No

8 TYPE OF CASING USED: Steel PVC Other CASING JOINTS: Glued Clamped Welded Threaded
 Casing diameter 2 in. to 20 ft., Diameter in. to ft., Diameter in. to ft.
 Casing height above land surface in. Weight lbs./ft. Wall thickness or gauge No. 40
TYPE OF SCREEN OR PERFORATION MATERIAL:
 Steel Stainless Steel Fiberglass PVC
 Brass Galvanized Steel Concrete tile None used (open hole) Other (Specify)
SCREEN OR PERFORATION OPENINGS ARE:
 Continuous Slot Mill Slot Gauze Wrapped Torch Cut Drilled Holes Other (Specify)
 Louvered Shutter Key Punched Wire Wrapped Saw Cut None (Open Hole)
SCREEN-PERFORATED INTERVALS: From .30 ft. to .40 ft., From ft. to ft., From ft. to ft.
GRAVEL PACK INTERVALS: From 28 ft. to 40 ft., From ft. to ft., From ft. to ft.

9 GROUT MATERIAL: Neat cement Cement grout Bentonite Other Concrete Surface Completion 0-1
 Grout Intervals: From 0 ft. to 1 ft., From 1 ft. to 26 ft., From 26 ft. to 28 ft.
Nearest source of possible contamination:
 Septic Tank Lateral Lines Pit Privy Livestock Pens Insecticide Storage
 Sewer Lines Cess Pool Sewage Lagoon Fuel Storage Abandoned Water Well
 Watertight Sewer Lines Seepage Pit Feedyard Fertilizer Storage Oil Well/Gas Well
 Other (Specify) Former Fuel Storage USTs
 Direction from well? West Distance from well? 100 ft.

10 FROM	TO	LITHOLOGIC LOG	FROM	TO	LITHO. LOG (cont.) or PLUGGING INTERVALS
0	1	TOPSOIL			
1	40	SILTY CLAY			

11 CONTRACTOR'S OR LANDOWNER'S CERTIFICATION: This water well was constructed, reconstructed, or plugged under my jurisdiction and was completed on (mo-day-year) 11/27/18 and this record is true to the best of my knowledge and belief. Kansas Water Well Contractor's License No. 585 This Water Well Record was completed on (mo-day-year) 12/21/18 under the business name of ASSOCIATED ENVIRONMENTAL INC. Signature *[Signature]*

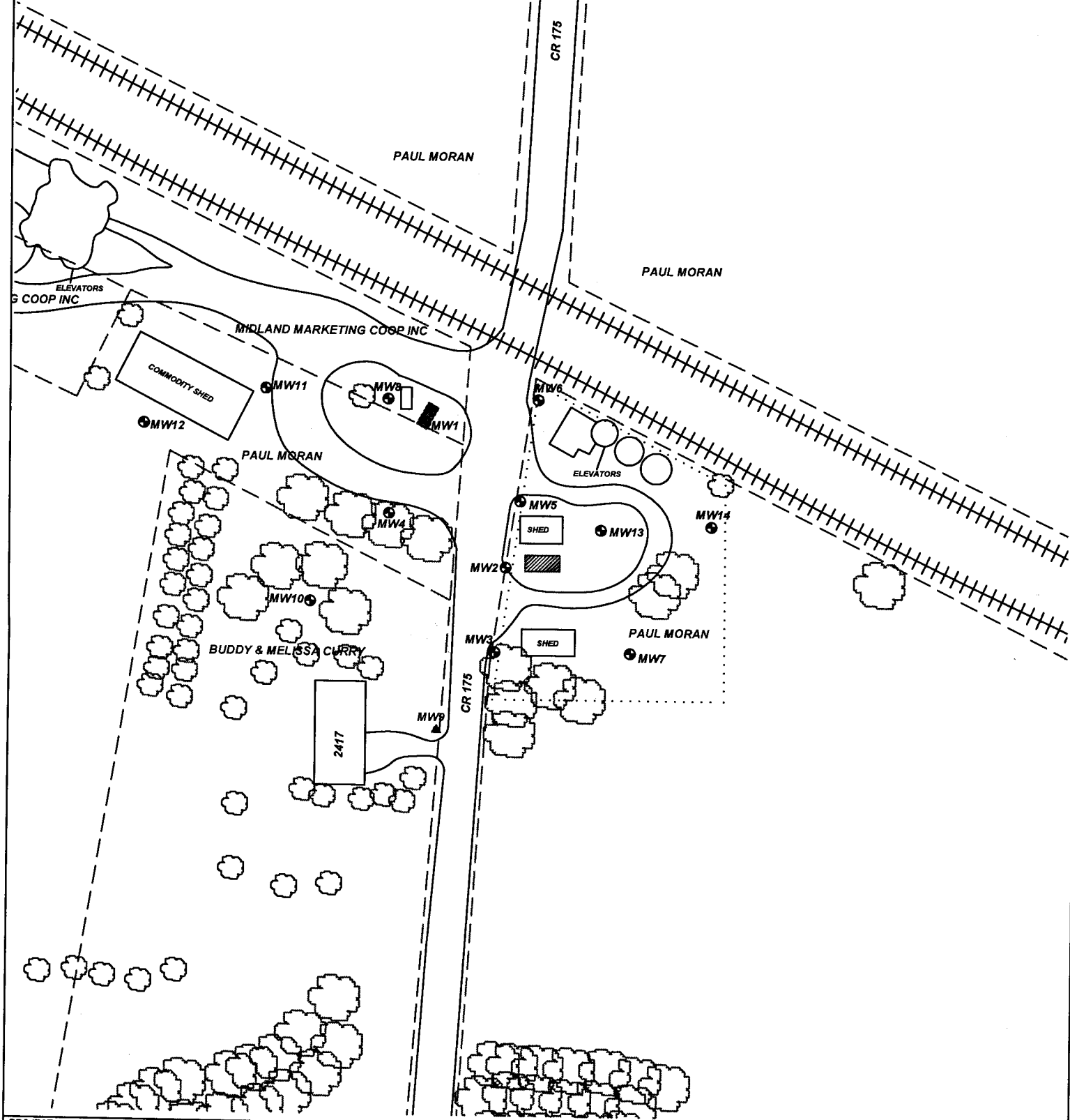

PROJECT: **MORAN, JAMES C.**
 ADDRESS: **RR1 BOX 108**
 LOCATION: **HARGRAVE, KS**
 DRAWN BY: **B. STALNAKER** DATE: **1/7/18**
 REVISED BY: **C. ROE** DATE: **12/6/18**
 AEI JOB #: **TF175** K0HE JOB #: **U6-083-00806**

TITLE: **FIGURE 2.1
 AREA BASE MAP
 350' RADIUS**

AEI ASSOCIATED ENVIRONMENTAL INC.

LEGEND:
 = FORMER 10,000 GAL GASOLINE UST
 = FORMER 750 GAL GASOLINE, 1000 GAL GASOLINE USTs
 = MONITORING WELL
 = PLUGGED/DESTROYED WELL

..... = SUBJECT PROPERTY
 --- = PARCEL BOUNDARY

SCALE: **1" = 100'**

NOTES:
 No basements observed within 500'.

