

1 LOCATION OF WATER WELL: Fraction Se 1/4 Sec 12 Section Number 12 Township Number T 17 S Range Number R 3 EW
 County: Moprherson

Distance and direction from nearest town or city street address of well if located within city?
4 E Hindsberg

2 WATER WELL OWNER: Shelly Heimer
 RR#, St. Address, Box #: 2901 Tasker Ln Board of Agriculture, Division of Water Resources
 City, State, ZIP Code: Salina, KS, 67401 Application Number:

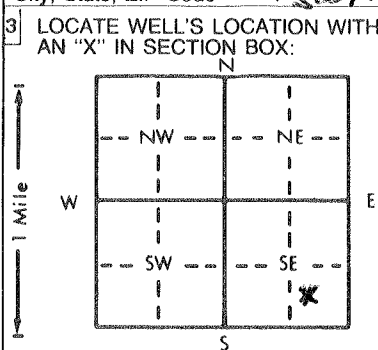

4 DEPTH OF COMPLETED WELL: 90 ft. ELEVATION:
 Depth(s) Groundwater Encountered 1. 22 ft. 2. ft. 3. ft.
 WELL'S STATIC WATER LEVEL: 12 ft. below land surface measured on mo/day/yr 2-21-98
 Pump test data: Well water was ft. after hours pumping gpm
 Est. Yield 10-20 gpm: Well water was ft. after hours pumping gpm
 Bore Hole Diameter: 4 1/2 in. to 35 ft., and 7 1/2 in. to 90 ft.
 WELL WATER TO BE USED AS:
 1 Domestic 3 Feedlot 6 Oil field water supply 9 Dewatering 12 Other (Specify below)
 2 Irrigation 4 Industrial 7 Lawn and garden only 10 Monitoring well
 Was a chemical/bacteriological sample submitted to Department? Yes.....No X.....; If yes, mo/day/yr sample was submitted
 Water Well Disinfected? Yes X No

5 TYPE OF BLANK CASING USED:
 1 Steel 3 RMP (SR) 5 Wrought iron 8 Concrete tile CASING JOINTS: Glued X Clamped
 2 PVC 4 ABS 6 Asbestos-Cement 9 Other (specify below) Welded
 7 Fiberglass Threaded
 Blank casing diameter: 5 in. to 20 ft., Dia. 5 in. to 20 ft., Dia. in. to ft.
 Casing height above land surface: 12 in., weight class 160 lbs./ft. Wall thickness or gauge No. 214
 TYPE OF SCREEN OR PERFORATION MATERIAL:
 1 Steel 3 Stainless steel 5 Fiberglass 7 PVC 10 Asbestos-cement
 2 Brass 4 Galvanized steel 6 Concrete tile 8 RMP (SR) 11 Other (specify)
 9 ABS 12 None used (open hole)
 SCREEN OR PERFORATION OPENINGS ARE:
 1 Continuous slot 3 Mill slot 5 Gauzed wrapped 8 Saw cut 11 None (open hole)
 2 Louvered shutter 4 Key punched 6 Wire wrapped 9 Drilled holes
 7 Torch cut 10 Other (specify)
 SCREEN-PERFORATED INTERVALS: From 20 ft. to 30 ft., From 20 ft. to 90 ft.
 GRAVEL PACK INTERVALS: From 18 ft. to 90 ft., From ft. to ft.

6 GROUT MATERIAL: 1 Neat cement 2 Cement grout 3 Bentonite 4 Other
 Grout Intervals: From 0 ft. to 18 ft., From ft. to ft., From ft. to ft.
 What is the nearest source of possible contamination:
 1 Septic tank 4 Lateral lines 7 Pit privy 10 Livestock pens 14 Abandoned water well
 2 Sewer lines 5 Cess pool 8 Sewage lagoon 11 Fuel storage 15 Oil well/Gas well
 3 Watertight sewer lines 6 Seepage pit 9 Feedyard 12 Fertilizer storage 16 Other (specify below)
 13 Insecticide storage
 Direction from well? Will be N How many feet? 100'

FROM	TO	LITHOLOGIC LOG	FROM	TO	PLUGGING INTERVALS
0	25	Sand			
25	90	Blue Gray Shale			

7 CONTRACTOR'S OR LANDOWNER'S CERTIFICATION: This water well was (1) constructed, (2) reconstructed, or (3) plugged under my jurisdiction and was completed on (mo/day/year) 2-21-98 and this record is true to the best of my knowledge and belief. Kansas Water Well Contractor's License No. 180 This Water Well Record was completed on (mo/day/yr) 2-25-98 under the business name of Backhus Drilling by (signature) Paul H. Backhus

INSTRUCTIONS: Use typewriter or ball point pen. PLEASE PRESS FIRMLY and PRINT clearly. Please fill in blanks, underline or circle the correct answers. Send top three copies to Kansas Department of Health and Environment, Bureau of Water, Topeka, Kansas 66620-0001. Telephone: 913-296-5545. Send one to WATER WELL OWNER and retain one for your records.