

WATER WELL RECORD

Form WWC-5

Division of Water Resources App. No.

[Empty box for application number]

1 LOCATION OF WATER WELL: County: McPherson Fraction SW 1/4 SE 1/4 SW 1/4 SE 1/4 Section Number 25 Township No. T 17 S Range Number R 4 [] E [x] W

Street/Rural Address of Well Location; if unknown, distance & direction from nearest town or intersection: If at owner's address, check here []. 2 south, 1 1/4 west of Lindsborg

Global Positioning System (GPS) information: Latitude: ... Longitude: ... Elevation: ... Datum: [] WGS 84, [] NAD 83, [] NAD 27 Collection Method: [] GPS unit, [] Digital Map/Photo, [] Topographic Map, [] Land Survey Est. Accuracy: [] <3 m, [] 3-5 m, [] 5-15 m, [] >15 m

2 WATER WELL OWNER: Husky Ventures Inc. RR#, Street Address, Box #: 204 N. Robinson Ave.-Ste. 1800 City, State, ZIP Code : Oklahoma City. OK 73102

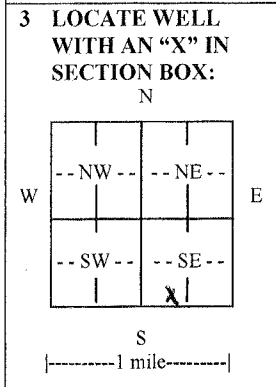

3 LOCATE WELL WITH AN "X" IN SECTION BOX: 4 DEPTH OF COMPLETED WELL 71 ft. Depth(s) Groundwater Encountered (1) ... ft. (2) ... ft. (3) ... ft. WELL'S STATIC WATER LEVEL 27 ft. below land surface measured on mo/day/yr. 11-15-11 Pump test data: Well water was ... ft. after ... hours pumping ... gpm EST. YIELD NA gpm. Well water was ... ft. after ... hours pumping ... gpm Bore Hole Diameter 10 in. to 71 ft., and ... in. to ... ft. WELL WATER TO BE USED AS: [] Public water supply [] Geothermal [] Injection well [] Domestic [] Feedlot [x] Oil field water supply [] Dewatering [] Other (Specify below) [] Irrigation [] Industrial [] Domestic-lawn & garden [] Monitoring well Was a chemical/bacteriological sample submitted to Department? [] Yes [x] No If yes, mo/day/yr sample was submitted. Water well disinfected? [x] Yes [] No

5 TYPE OF CASING USED: [] Steel [x] PVC [] Other CASING JOINTS: [x] Glued [] Clamped [] Welded [] Threaded Casing diameter .5 in. to .71 ft., Diameter ... in. to ... ft., Diameter ... in. to ... ft. Casing height above land surface .18 in., Weight SDR 26 lbs./ft., Wall thickness or gauge No. TYPE OF SCREEN OR PERFORATION MATERIAL: [] Steel [] Stainless Steel [x] PVC [] Other (Specify) [] Brass [] Galvanized Steel [] None used (open hole) SCREEN OR PERFORATION OPENINGS ARE: [] Continuous slot [] Mill slot [] Gauze wrapped [] Torch cut [] Drilled holes [] None (open hole) [] Louvered shutter [] Key punched [] Wire wrapped [x] Saw cut [] Other (specify) SCREEN-PERFORATED INTERVALS: From .71 ft. to .51 ft., From ... ft. to ... ft. From ... ft. to ... ft. From ... ft. to ... ft. GRAVEL PACK INTERVALS: From .71 ft. to .20 ft., From ... ft. to ... ft. From ... ft. to ... ft.

6 GROUT MATERIAL: [] Neat cement [] Cement grout [x] Bentonite [] Other Grout intervals: From ... ft. to ... ft., From 20 ft. to 0 ft., From ... ft. to ... ft. What is the nearest source of possible contamination: [] Septic tank [] Lateral lines [] Pit privy [] Livestock pens [] Insecticide storage [] Other (specify below) [] Sewer lines [] Cesspool [] Sewage lagoon [] Fuel storage [] Abandoned water well [] Watertight sewer lines [] Seepage pit [] Feedyard [] Fertilizer storage [] Oil well/gas well None Direction from well Distance from well

Table with columns: FROM, TO, LITHOLOGIC LOG, FROM, TO, LITHO. LOG (cont.) or PLUGGING INTERVALS. Rows: 0-3 Black top soil, 3-27 Brown clay, 27-35 Sand & gravel-medium, 35-40 Soft Tan & gray clay, 40-68 Sand & gravel-medium, 68-71 Gray clay.

7 CONTRACTOR'S OR LANDOWNER'S CERTIFICATION: This water well was [x] constructed, [] reconstructed, or [] plugged under my jurisdiction and was completed on (mo/day/year) 11-15-11 and this record is true to the best of my knowledge and belief. Kansas Water Well Contractor's License No. 134 This Water Well Record was completed on (mo/day/year) 12-10-11 under the business name of Rosencrantz-Bemis by (signature) [Signature]

INSTRUCTIONS: Use typewriter or ball point pen. PLEASE PRESS FIRMLY and PRINT clearly. Please fill in blanks and check the correct answers. Send three copies (white, blue, pink) to Kansas Department of Health and Environment, Bureau of Water, Geology Section, 1000 SW Jackson St., Suite 420, Topeka, Kansas 66612-1367. Telephone 785-296-5524. Send one copy to WATER WELL OWNER and retain one for your records. I include fee of \$5.00 for each constructed well. Visit us at http://www.kdheks.gov/waterwell/index.html.