

1 LOCATION OF WATER WELL: Fraction 1/4 NE 1/4 SW 1/4 NE 1/4 Section Number 29 Township Number T 17 S Range Number 9 E W
 County: Ellsworth

Street/Rural Address of Well Location; if unknown, distance & direction from nearest town or intersection: If at owner's address, check here 1 1/4 South, 3/4 West of Lorraine

Global Positioning Systems (GPS) information:
 Latitude: _____ (in decimal degrees)
 Longitude: _____ (in decimal degrees)
 Elevation: _____
 Datum: WGS84, NAD83, NAD27
 Collection Method:
 GPS unit (Make/Model: _____)
 Digital Map/Photo, Topographic Map, Land Survey
 Est. Accuracy: < 3 m, 3-5 m, 5-15 m, > 15 m

2 WATER WELL OWNER: Farmers National-Molhagen
 RR#, St. Address, Box #: P.O. Box 56
 City, State ZIP Code: Hays, KS 67601

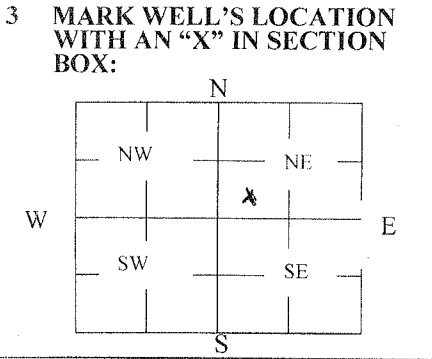

4 DEPTH OF WELL 138 ft.
 WELL'S STATIC WATER LEVEL 63 ft.
 WELL WAS USED AS:
 Domestic Public Water Supply Dewatering
 Irrigation Oil Field Water Supply Monitoring
 Feedlot Domestic (Lawn & Garden) Injection Well
 Industrial Air Conditioning Other _____
 Was a chemical/bacteriological sample submitted to Department? Yes No

5 TYPE OF BLANK CASING USED:
 Steel RMP (SR) Wrought Fiberglass Other (Specify below)
 PVC ABS Asbestos-Cement Concrete Tile
 Blank casing diameter 16 in. Was casing pulled? Yes No If yes, how much _____
 Casing height above or below land surface 36 in.

6 GROUT PLUG MATERIAL: Neat cement Cement grout Bentonite Other _____
 Grout Plug Intervals: From 25 ft. to 3 ft., From _____ ft. to _____ ft., From _____ to _____ ft.
 What is the nearest source of possible contamination:
 Septic tank Seepage pit Fuel Storage Other (specify below)
 Sewer lines Pit privy Fertilizer storage
 Watertight sewer lines Sewage lagoon Insecticide storage
 Lateral lines Feedyard Abandoned water well
 Cess pool Livestock pens Oil well/Gas well
 Direction from well? Northwest
 How many feet? 1000

| FROM | TO | PLUGGING MATERIALS | FROM | TO | PLUGGING MATERIALS |
|------|----|--------------------|------|----|--------------------|
| 138 | 25 | Chlorinated gravel | | | |
| 25 | 3 | Cement | | | |
| 3 | 0 | Top soil | | | |
| | | | | | |
| | | | | | |
| | | | | | |

7 CONTRACTOR'S OR LANDOWNER'S CERTIFICATION: This water well was plugged under my jurisdiction and was completed on (mo/day/year) 8-1-14 and this record is true to the best of my knowledge and belief. Kansas Water Well Contractor's License No. 134. This Water Well Record was completed on (mo/day/year) 8-15-14 under the business name of Rosencrantz-Bemis Ent Inc by (signature) [Signature]

INSTRUCTIONS: Use typewriter or ballpoint pen. Please press firmly and print clearly. Please fill in blanks, underline or circle the correct answers. Send top three copies to Kansas Department of Health and Environment, Bureau of Water, Geology Section, 1000 SW Jackson St., Ste. 420, Topeka, Kansas 66612-1367. Telephone: 785/296-5524. Send one to Water Well Owner and retain one for your records. Visit us at <http://www.kdheks.gov/waterwell/index.html>.