

WATER WELL PLUGGING RECORD Form WWC-5P

03-19155
KSA 82a-1212 ID NO.

1 LOCATION OF WATER WELL: Fraction $\frac{1}{4}$ $\frac{1}{4}$ SW $\frac{1}{4}$ SE $\frac{1}{4}$ Section Number 31 Township Number T 17 S Range Number 9 E W
 County: Ellsworth
 Street/Rural Address of Well Location; if unknown, distance & direction from nearest town or intersection: If at owner's address, check here OneOK Facility (Kinder Morgarn) 777 Y Avenue Bushton KS 67427
Global Positioning Systems (GPS) information:
 Latitude: 38.522157 (in decimal degrees)
 Longitude: -98.361737 (in decimal degrees)
 Elevation: _____
 Horizontal Datum: WGS84, NAD83, NAD27
 Collection Method: _____

2 WATER WELL OWNER: KMI
 RR#, St. Address, Box #: 1001 Louisiana Street
 City, State ZIP Code: Houston TX 77002
 GPS unit (Make/Model: Garmin etrek
 Digital Map/Photo, Topographic Map, Land Survey
 Est. Accuracy: < 3 m, 3-5 m, 5-15 m, > 15 m

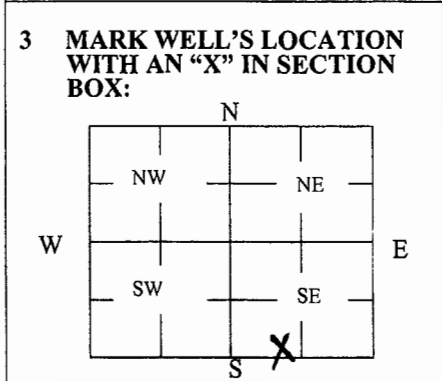

4 DEPTH OF WELL 28 ft.
 WELL'S STATIC WATER LEVEL _____ ft
 WELL WAS USED AS:
 Domestic Public Water Supply Dewatering
 Irrigation Oil Field Water Supply Monitoring
 Feedlot Domestic (Lawn & Garden) Injection Well
 Industrial Air Conditioning Other _____
 Was a chemical/bacteriological sample submitted to Department? Yes No

5 TYPE OF BLANK CASING USED:
 Steel RMP (SR) Wrought Fiberglass Other (Specify below)
 PVC ABS Asbestos-Cement Concrete Tile
 Blank casing diameter 2 in. Was casing pulled? Yes No If yes, how much all _____
 Casing height above or below land surface 30 in.

6 GROUT PLUG MATERIAL: Neat cement Cement grout Bentonite Other Top Soil
 Grout Plug Intervals: From 0 ft. to 3 ft., From 3 ft. to 28 ft., From - ft. to - ft.
 What is the nearest source of possible contamination:
 Septic tank Seepage pit Fuel storage Other (specify below)
 Sewer lines Pit privy Fertilizer storage
 Watertight sewer lines Sewage lagoon Insecticide storage
 Lateral lines Feedyard Abandoned water well Direction from well? _____
 Cess pool Livestock pens Oil well/Gas well How many feet? _____

FROM	TO	PLUGGING MATERIALS	FROM	TO	PLUGGING MATERIALS
0	3	Top Soil			
3	28	Bentonite			

7 CONTRACTOR'S OR LANDOWNER'S CERTIFICATION: This water well was plugged under my jurisdiction and was completed on (mo/day/year) 9-27-16 and this record is true to the best of my knowledge and belief. Kansas Water Well Contractor's License No. 710. This Water Well Record was completed on (mo/day/year) 10/31/16 under the business name of Below Ground Surface, Inc. by (signature) Michael T. Osborn

Send one white copy to Kansas Department of Health & Environment, Geology Section, 1000 SW Jackson Street, Ste. 420, Topeka, KS 66612-1367. Send one copy to WATER WELL OWNER and retain one for your records.
 Visit us at <http://www.kdheks.gov/waterwell/index.html> Telephone 785-296-5524.