

WATER WELL RECORD

Form WWC-5

Division of Water Resources App. No.

Blank box for application number

1 LOCATION OF WATER WELL: County: Barton, Fraction: NE 1/4 SW 1/4 NE 1/4 SE 1/4, Section Number: 5, Township No.: T 18 S, Range Number: R 13

Street/Rural Address of Well Location; if unknown, distance & direction from nearest town or intersection: 165 W Broadway Ave. Hoisington, KS 67544. Global Positioning System (GPS) information: Latitude: 38.51306, Longitude: 98.77877, Elevation: 1836.96

2 WATER WELL OWNER: Don Horton, RR#, Street Address, Box #: 165 W Broadway ave, City, State, ZIP Code: Hoisington, KS 67544. Collection Method: Land Survey

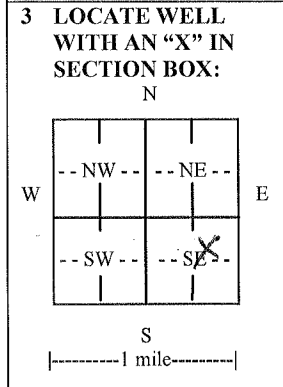

3 LOCATE WELL WITH AN 'X' IN SECTION BOX: [Diagram] 4 DEPTH OF COMPLETED WELL 33 ft. Depth(s) Groundwater Encountered (1) 23 ft. (2) ft. (3) ft. WELL'S STATIC WATER LEVEL 22.35 ft. below land surface measured on mo/day/yr. 1/28/14. Pump test data: Well water was ft. after hours pumping gpm. EST. YIELD gpm. Well water was ft. after hours pumping gpm. Bore Hole Diameter 8.5 in. to 33 ft., and in. to ft. WELL WATER TO BE USED AS: Monitoring well MW27. Was a chemical/bacteriological sample submitted to Department? No. Water well disinfected? No.

5 TYPE OF CASING USED: PVC. CASING JOINTS: Threaded. Casing diameter 2.0 in. to 1.8 ft., Diameter in. to ft., Diameter in. to ft. Casing height above land surface 4.68 in., Weight lbs./ft., Wall thickness or gauge No. Sch 40 PVC. TYPE OF SCREEN OR PERFORATION MATERIAL: PVC. SCREEN OR PERFORATION OPENINGS ARE: Mill slot. SCREEN-PERFORATED INTERVALS: From 18 ft. to 33 ft. GRAVEL PACK INTERVALS: From 16 ft. to 33 ft.

6 GROUT MATERIAL: Bentonite. Grout Intervals: From 1 ft. to 16 ft. What is the nearest source of possible contamination: Other (specify below) LUST Site. Direction from well Distance from well

Table with columns: FROM, TO, LITHOLOGIC LOG, FROM, TO, LITHO. LOG (cont.) or PLUGGING INTERVALS. Row 1: 0, 33, Clay, silty.

7 CONTRACTOR'S OR LANDOWNER'S CERTIFICATION: This water well was constructed, reconstructed, or plugged under my jurisdiction and was completed on (mo/day/year) 1-16-14 and this record is true to the best of my knowledge and belief. Kansas Water Well Contractor's License No. 594. This Water Well Record was completed on (mo/day/year) 2-28-14 under the business name of Coranco Great Plains, Inc. by (signature) [Signature]

INSTRUCTIONS: Use typewriter or ball point pen. PLEASE PRESS FIRMLY and PRINT clearly. Please fill in blanks and check the correct answers. Send one copy to Kansas Department of Health and Environment, Bureau of Water, Geology Section, 1000 SW Jackson St., Suite 420, Topeka, Kansas 66612-1367. Telephone 785-296-5524. Send one copy to WATER WELL OWNER and retain one for your records. Include fee of \$5.00 for each constructed well. Visit us at http://www.kdheks.gov/waterwell/index.html