

WATER WELL RECORD

Form WWC-5

Division of Water Resources App. No.

Well ID

MW21

[X] Original Record [ ] Correction [ ] Change in Well Use

1 LOCATION OF WATER WELL: County Barton Fraction SE 1/4 SW 1/4 NE 1/4 SE 1/4 Section Number 5 Township Number T 18 S Range Number R 13 E W

2 WELL OWNER: Last Name: Business: Manweiler Chevrolet Co. Address: PO Box 390 City: Hoisington State: KS ZIP: 67544 Street or Rural Address where well is located (if unknown, distance and direction from nearest town or intersection): 169 W Railroad St, Hoisington, KS 67544

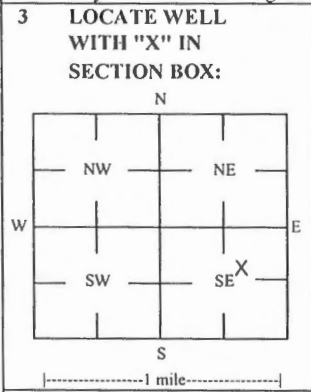

3 LOCATE WELL WITH "X" IN SECTION BOX: 4 DEPTH OF COMPLETED WELL: 25 ft. Depth(s) Groundwater Encountered: 1) 13.41 ft. 2) ... 3) ... 4) Dry Well. WELL'S STATIC WATER LEVEL: 12/4/18. [X] below land surface, measured on (mo-day-yr) 12/4/18. Pump test data: Well water was ... ft after ... hours pumping ... gpm. Water well was ... ft after ... hours pumping ... gpm. Estimated Yield: ... gpm. Bore Hole Diameter: 7.25 in to ... ft, and ... in to ... ft.

5 Latitude: 38.51153 (decimal degrees) Longitude: 98.77793 (decimal degrees) Horizontal Datum: [ ] WGS 84 [ ] NAD 83 [X] NAD 27 Source for Latitude/Longitude: [ ] GPS (unit make/model: ) (WAAS enabled? [ ] Yes [ ] No) [X] Land Survey [ ] Topographic Map [ ] Online Mapper 6 Elevation 1831.23 ft [ ] Ground Level [X] TOC Source [X] Land Survey [ ] GPS [ ] Topographic Map [ ] Other

7 WELL WATER TO BE USED AS: 1 Domestic: [ ] Household [ ] Lawn & Garden [ ] Livestock [ ] Irrigation [ ] Feedlot [ ] Industrial 2 [ ] Public Water Supply: well ID 3 [ ] Dewatering: how many wells? 4 [ ] Aquifer Recharge: well ID 5 [X] Monitoring: well ID MW21 6 Environmental Remediation: well ID [ ] Air Sparge [ ] Soil Vapor Extractor [ ] Recovery [ ] Injection 7 [ ] Oil Field Water Supply: lease 8 Test Hole: well ID [ ] Cased [ ] Uncased [ ] Geotechnical 9 Geothermal: How many bores? a) Closed Loop [ ] Horizontal [ ] Vertical b) Open Loop [ ] Surface Discharge [ ] Inj. of Water [ ] Other (specify):

Was a chemical/bacteriological sample submitted to KDHE? [ ] Yes [X] No If yes, date sample was submitted: Water well disinfected? [ ] Yes [X] No

8 TYPE OF CASING USED: [ ] Steel [X] PVC [ ] Other CASING JOINTS: [ ] Glued [ ] Clamped [ ] Welded [X] Threaded Casing diameter 2 in. to 10 ft, Diameter in. to ft, Diameter in. to ft, Casing height above land surface -0.56 in. Weight lbs./ft. Well thickness or gauge No TYPE OF SCREEN OR PERFORATION MATERIAL: [ ] Steel [ ] Stainless Steel [ ] Fiberglass [X] PVC [ ] Other (Specify) [ ] Brass [ ] Galvanized Steel [ ] Concrete tile [ ] None used (open hole) SCREEN OR PERFORATION OPENINGS ARE: [ ] Continuous Slot [X] Mill Slot [ ] Gauze Wrapped [ ] Torch Cut [ ] Drilled Holes [ ] Other (Specify) [ ] Louvered Shutter [ ] Key Punched [ ] Wire Wrapped [ ] Saw Cut [ ] None (Open Hole) SCREEN-PERFORATED INTERVALS: From 10 ft. to 25 ft, From ft. to ft, From ft. to ft, GRAVEL PACK INTERVALS: From 8 ft. to 25 ft, From ft. to ft, From ft. to ft

9 GROUT MATERIAL: [ ] Neat cement [ ] Cement grout [X] Bentonite [X] Other Concrete: 0-0.5' Grout intervals: From 0.5 ft. to 8 ft, From ft. to ft, From ft. to ft

Nearest source of possible contamination: [ ] Septic Tank [ ] Lateral Lines [ ] Pit Privy [ ] Livestock Pens [ ] Insecticide Storage [ ] Sewer Lines [ ] Cess Pool [ ] Sewage Lagoon [X] Fuel Storage [ ] Abandoned Water Well [ ] Watertight Sewer Lines [ ] Seepage Pit [ ] Feedyard [ ] Fertilizer Storage [ ] Oil Well / Gas Well [ ] Other (Specify) Direction from well? NE Distance from well? ~95 ft

10 FROM TO LITHOLOGIC LOG FROM TO LITHO. LOG (cont.) or PLUGGING INTERVALS

|     |     |             |  |  |  |
|-----|-----|-------------|--|--|--|
| 0   | 0.3 | Gravel      |  |  |  |
| 0.3 | 6   | Silty clay  |  |  |  |
| 6   | 12  | Clayey silt |  |  |  |
| 12  | 25  | Silty clay  |  |  |  |

Notes: KDHE ID: Manweiler Chevrolet Co.; U6-005-14581

11 CONTRACTOR'S OR LANDOWNER'S CERTIFICATION: This water well was [X] constructed, [ ] reconstructed, or [ ] plugged under my jurisdiction and was completed on (mo-day-year) 12/3/18 and this record is true to the best of my knowledge and belief. Kansas Water Well Contractor's License No 757 This Water Well Record was completed on (mo-day-year) 1/11/19 under the business name of Larsen & Associates, Inc. Signature

Mail 1 white copy along with a fee of \$5.00 for each constructed well to: Kansas Department of Health and Environment, Bureau of Water, GWTS Section, 1000 SW Jackson St., Suite 420, Topeka, Kansas 66612-1367. Mail one to Water Well Owner and retain one for your records. Telephone 785-296-5524.

NOTE: Figures exhibited within this report are only to be used within the context of this report. Placement of property lines, wells, structures, and roads is based on the available information from county appraiser maps, surveys, site visits, and/or previous vendor reports and should be considered approximate.

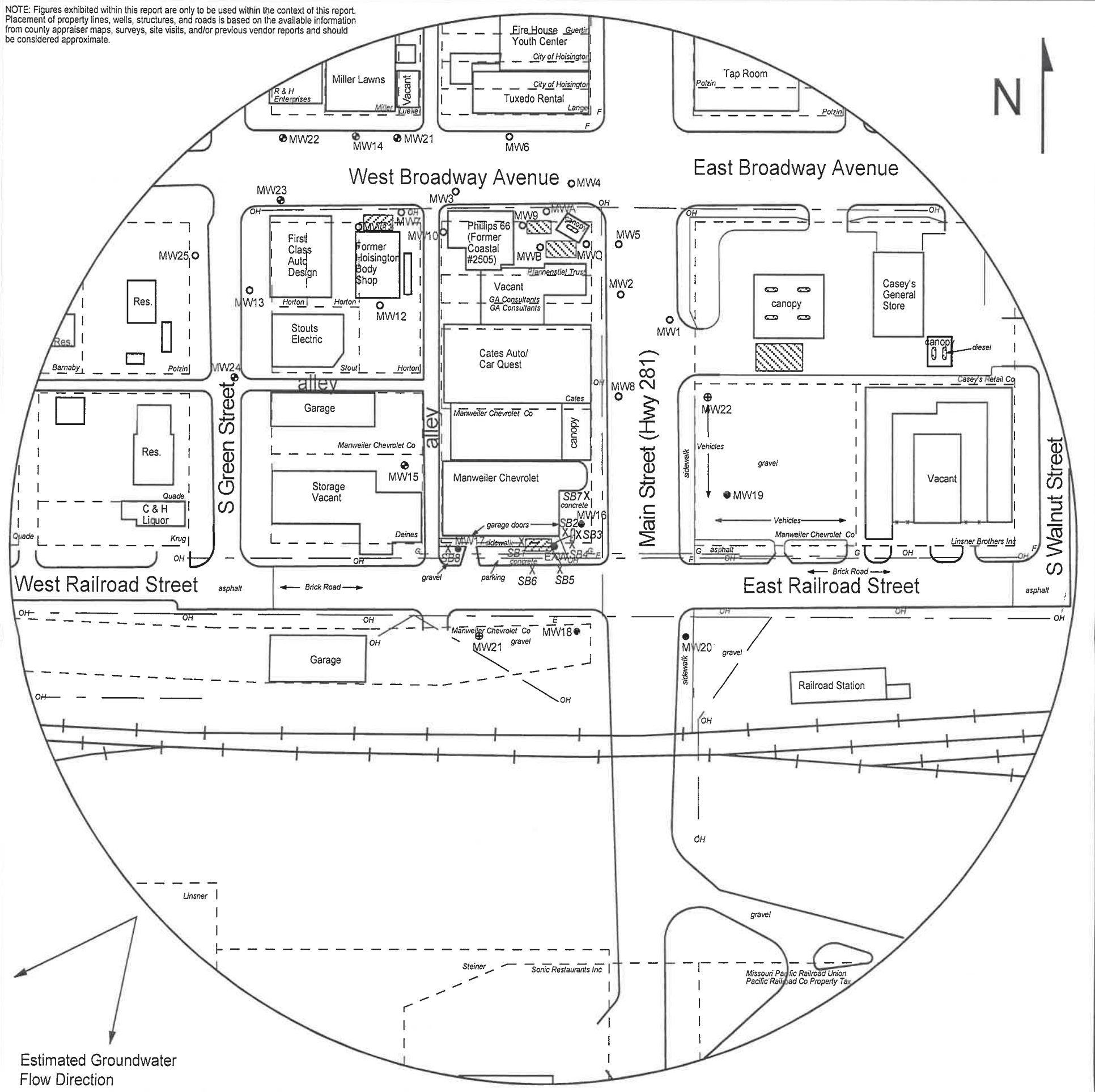

FIGURE 2.2 - 500 FT RADIUS AREA BASE MAP

**LEGEND**

- Approximate Location of Former UST Basin, Product Lines & Pump Islands
- Approximate Location of Active UST Basin & Pump Islands
- - - Approximate Location of Property Line
- Existing Monitoring Well
- ⊕ Monitoring Well from nearby sites
- ⊕ Monitoring Well (Installed 12/3/18)
- Plugged Well
- X Soil Boring (Drilled 12/4-5/18)
- E Electric Meter
- F Fire Hydrant
- Gas Lines (1.5 - 3 ft bgs)
- Overhead Lines (25'-40' high)

NOTE: SB7 & SB8 were used to collect hydrologic samples  
NOTE: Utility depths, heights and locations are approximate.



1311 E 25th St., Suite B 785-841-8707 office  
Lawrence, KS 66046 785-865-4282 fax

**PROJECT:**

Manweiler Chevrolet Co.  
271 S. Main  
Hoisington, KS  
KDHE ID: U6-005-14581  
Date: 12/5/18



RECEIVED  
JAN 31 2019  
BUREAU OF WATER