

WATER WELL RECORD

Form WWC-5

Division of Water Resources App. No.

Well ID

MW22

Original Record Correction Change in Well Ust

1 LOCATION OF WATER WELL: Fraction Section Number Township Number Range Number

2 WELL OWNER: Last Name: Business: Manweiler Chevrolet Co. Address: PO Box 390

3 LOCATE WELL WITH "X" IN SECTION BOX: 4 DEPTH OF COMPLETED WELL: 5 Latitude: Longitude: Horizontal Datum:

7 WELL WATER TO BE USED AS: 1 Domestic: 2 Irrigation: 3 Feedlot: 4 Industrial: 5 Public Water Supply: well ID: 6 Dewatering: how many wells?: 7 Aquifer Recharge: well ID: 8 Monitoring: well ID MW22: 9 Environmental Remediation: well ID: 10 Oil Field Water Supply: lease: 11 Test Hole: well ID: 12 Geothermal: How many bores?:

Was a chemical/bacteriological sample submitted to KDHE? Water well disinfected? If yes, date sample was submitted:

8 TYPE OF CASING USED: Steel PVC Other CASING JOINTS: Glued Clamped Welded Threaded Casing diameter Casing height above land surface TYPE OF SCREEN OR PERFORATION MATERIAL: Steel Stainless Steel Fiberglass PVC Other (Specify) SCREEN OR PERFORATION OPENINGS ARE: Continuous Slot Mill Slot Gauze Wrapped Torch Cut Drilled Holes Other (Specify) Louvered Shutter Key Punched Wire Wrapped Saw Cut None (Open Hole) SCREEN-PERFORATED INTERVALS: GRAVEL PACK INTERVALS:

9 GROUT MATERIAL: Neat cement Cement grout Bentonite Other Concrete: 0-0.5' Grout intervals:

Nearest source of possible contamination: Septic Tank Lateral Lines Pit Privy Livestock Pens Insecticide Storage Sewer Lines Cess Pool Sewage Lagoon Fuel Storage Abandoned Water Well Watertight Sewer Lines Seepage Pit Feedyard Fertilizer Storage Oil Well / Gas Well Other (Specify) Direction from well? Distance from well?

Table with columns: FROM, TO, LITHOLOGIC LOG, FROM, TO, LITHO. LOG (cont.) or PLUGGING INTERVALS

Notes: KDHE ID: Manweiler Chevrolet Co.; U6-005-14581

11 CONTRACTOR'S OR LANDOWNER'S CERTIFICATION: This water well was constructed, reconstructed or plugged under my jurisdiction and was completed on (mo-day-year) 12/3/18 and this record is true to the best of my knowledge and belief.

NOTE: Figures exhibited within this report are only to be used within the context of this report. Placement of property lines, wells, structures, and roads is based on the available information from county appraiser maps, surveys, site visits, and/or previous vendor reports and should be considered approximate.

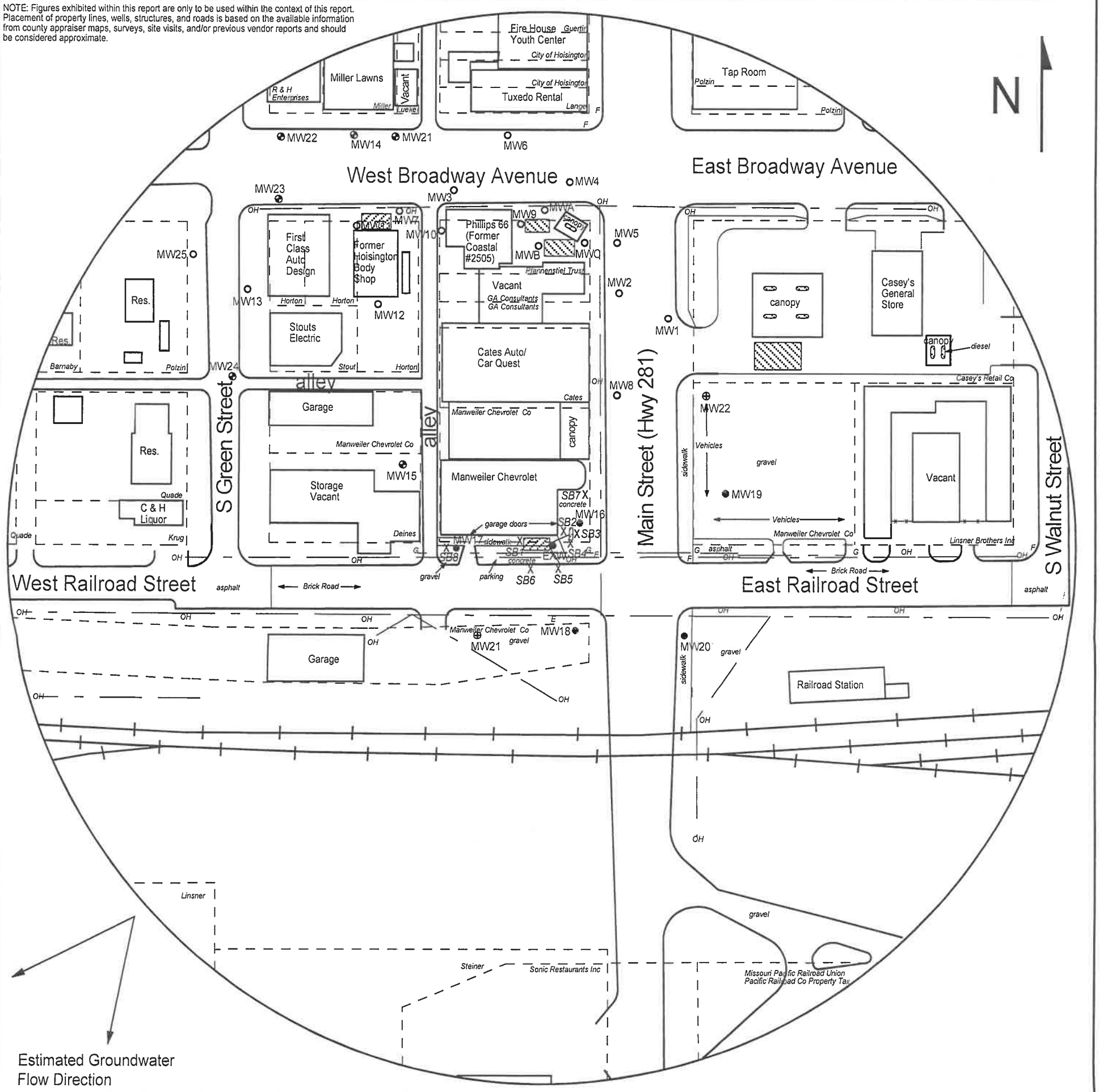

FIGURE 2.2 - 500 FT RADIUS AREA BASE MAP

LEGEND

- Approximate Location of Former UST Basin, Product Lines & Pump Islands
- Approximate Location of Active UST Basin & Pump Islands
- - - - - Approximate Location of Property Line
- Existing Monitoring Well
- ⊕ Monitoring Well from nearby sites
- ⊕ Monitoring Well (Installed 12/3/18)
- Plugged Well
- X Soil Boring (Drilled 12/4-5/18)
- E Electric Meter
- F Fire Hydrant
- Gas Lines (1.5 - 3 ft bgs)
- Overhead Lines (25'-40' high)

NOTE: SB7 & SB8 were used to collect hydrologic samples
NOTE: Utility depths, heights and locations are approximate.



1311 E 25th St., Suite B 785-841-8707 office
Lawrence, KS 66046 785-865-4282 fax

PROJECT:

Manweiler Chevrolet Co.
271 S. Main
Hoisington, KS
KDHE ID: U6-005-14581
Date: 12/5/18

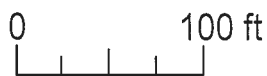

RECEIVED
JAN 31 2019
BUREAU OF WATER