

revised

MW12

WATER WELL PLUGGING RECORD Form WWC-5P KSA 82a-1212 ID NO.

1 LOCATION OF WATER WELL: County: BARTON Fraction SE 1/4 SE 1/4 NW 1/4 NW 1/4 Section Number 1 Township Number T 18 S Range Number 15 [] E [x] W

Street/Rural Address of Well Location; if unknown, distance & direction from nearest town or intersection: If at owner's address, check here [] 318 1ST ST OLMITZ, KS 67564

Global Positioning Systems (GPS) information: Latitude: (in decimal degrees) Longitude: (in decimal degrees) Elevation: 2018.64 Horizontal Datum: [] WGS84, [x] NAD83, [] NAD27 Collection Method:

2 WATER WELL OWNER: AGRI TRAILS COOP RR#, St. Address, Box #: PO BOX 157 City, State ZIP Code: HOPE, KS 67451-0157

[] GPS unit (Make/Model): [] Digital Map/Photo, [] Topographic Map, [x] Land Survey Est. Accuracy: [] < 3 m, [] 3-5 m, [] 5-15 m, [] > 15 m

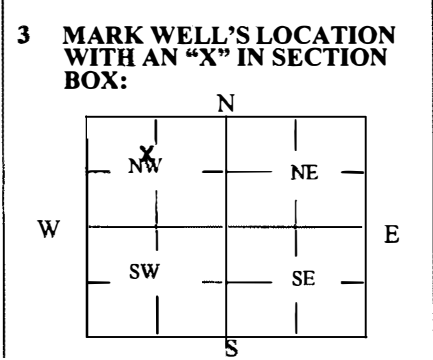

4 DEPTH OF WELL 29.31 ft. WELL'S STATIC WATER LEVEL 17.84 ft. WELL WAS USED AS: [] Domestic [] Irrigation [] Feedlot [] Industrial [] Public Water Supply [] Oil Field Water Supply [] Domestic (Lawn & Garden) [] Air Conditioning [] Dewatering [x] Monitoring [] Injection Well [] Other Was a chemical/bacteriological sample submitted to Department? Yes [] No [x]

5 TYPE OF BLANK CASING USED: [x] Steel [] PVC [] RMP (SR) [] ABS [] Wrought Asbestos-Cement [] Fiberglass Concrete Tile [] Other (Specify below) Blank casing diameter 2 in. Was casing pulled? Yes [x] No [] If yes, how much 3' Casing height above or below land surface in.

6 GROUT PLUG MATERIAL: [] Neat cement [] Cement grout [x] Bentonite [x] Other GRASS 0-0.5 Grout Plug Intervals: From 0.5 ft. to 29.31 ft., From ft. to ft., From ft. to ft. What is the nearest source of possible contamination: [] Septic tank [] Sewer lines [] Watertight sewer lines [] Lateral lines [] Cess pool [] Seepage pit [] Pit privy [] Sewage lagoon [] Feedyard [] Livestock pens [x] Fuel storage [] Fertilizer storage [] Insecticide storage [] Abandoned water well [] Oil well/Gas well [] Other (specify below) Direction from well? SOUTH How many feet? 70

Table with columns: FROM, TO, PLUGGING MATERIALS. Row 1: 0, 0.5, TOPSOIL. Row 2: 0.5, 29.31, BENTONITE.



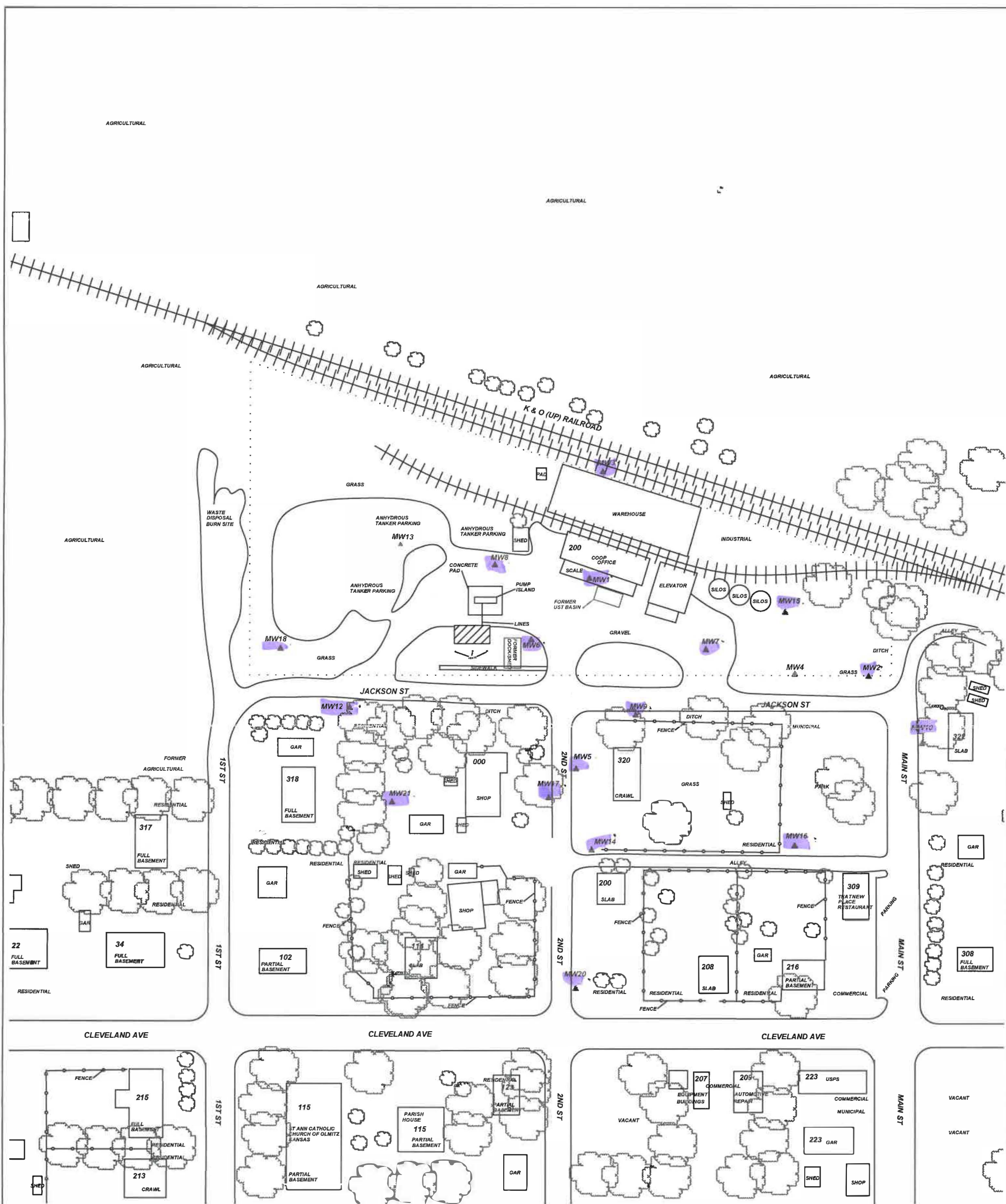

7 CONTRACTOR'S OR LANDOWNER'S CERTIFICATION: This water well was plugged under my jurisdiction and was completed on (mo/day/year) 9/26/22 and this record is true to the best of my knowledge and belief. Kansas Water Well Contractor's License No. 585. This Water Well Record was completed on (mo/day/year) 10/3/22 under the business name of ASSOCIATED ENVIRONMENTAL INC. by (signature)

Send one white copy to Kansas Department of Health & Environment, Geology Section, 1000 SW Jackson Street, Ste. 420, Topeka, KS 66612-1367. Send one copy to WATER WELL OWNER and retain one for your records. Visit us at http://www.kdheks.gov/waterwell/index.html Telephone 785-296-5524.



PROJECT: UNITED AG SERVICES, INC.
ADDRESS: JACKSON STREET
LOCATION: OLMITZ, KS
DRAWN BY: C. ROE **DATE:** 10/2/21
REVISED BY: B. STALNAKER **DATE:** 2/9/23
AEI JOB #: TF539 **KDHE JOB #:** U6-005-12455
SCALE: 1" = 100'
 0 50 100

TITLE: FIGURE 2.2
 AREA BASE MAP
 500' RADIUS
 **ASSOCIATED ENVIRONMENTAL INC.**

LEGEND:
 = 1-8K GALS. DYED DIESEL / 1-8K GALS. CLEAR DIESEL / 1-8K GALS. E10 GASOLINE, PRODUCT LINES, VENTS, & DISPENSERS
 = MONITORING WELL
 = PLUGGED/DESTROYED WELL
 = SUBJECT PROPERTY

 RECEIVED
 APR 07 2023
 BUREAU OF WATER