

LOCATION OF WATER WELL: County: Rush Fraction: NE 1/4 SE 1/4 SW 1/4 Section Number: 19 Township Number: T 18 S Range Number: R 17 W

Distance and direction from nearest town or city street address of well if located within city?
3 1/2 miles east of Rush Center, Ks

WATER WELL OWNER: Red Tiger Drilling Co } Lester Seuser
 RR#, St. Address, Box #: 1720 Ks St Bnk Bldg } R7D #2 Box 331
 City, State, ZIP Code: Wichita, Ks 67202 } Timken, Ks 67582
 Board of Agriculture, Division of Water Resources
 Application Number: 788-6660

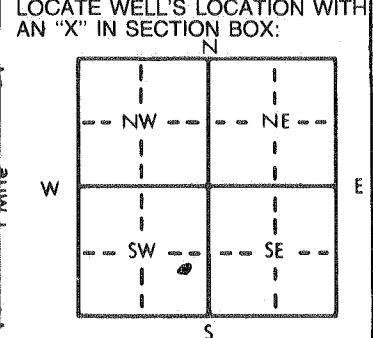

4 DEPTH OF COMPLETED WELL: 70 ft. ELEVATION: _____ ft.
 Depth(s) Groundwater Encountered 1. _____ ft. 2. _____ ft. 3. _____ ft.
 WELL'S STATIC WATER LEVEL: 34 ft. below land surface measured on mo/day/yr 2-8-88
 Pump test data: Well water was _____ ft. after _____ hours pumping _____ gpm
 Est. Yield _____ gpm: Well water was _____ ft. after _____ hours pumping _____ gpm
 Bore Hole Diameter: 7 7/8 in. to _____ ft., and _____ in. to _____ ft.
 WELL WATER TO BE USED AS:
 5 Public water supply 8 Air conditioning 11 Injection well
 1 Domestic 3 Feedlot 6 Oil field water supply 9 Dewatering 12 Other (Specify below)
 2 Irrigation 4 Industrial 7 Lawn and garden only 10 Observation well
 Was a chemical/bacteriological sample submitted to Department? Yes _____ No X; If yes, mo/day/yr sample was submitted _____
 Water Well Disinfected? Yes _____ No X

TYPE OF BLANK CASING USED:
 1 Steel 3 RMP (SR) 5 Wrought iron 8 Concrete tile CASING JOINTS: Glued X Clamped _____
2 PVC 4 ABS 6 Asbestos-Cement 9 Other (specify below) Welded _____
 7 Fiberglass Threaded _____
 Blank casing diameter 5 in. to _____ ft., Dia _____ in. to _____ ft., Dia _____ in. to _____ ft.
 Casing height above land surface: 3' below in., weight _____ lbs./ft. Wall thickness or gauge No. _____

TYPE OF SCREEN OR PERFORATION MATERIAL:
 1 Steel 3 Stainless steel 5 Fiberglass 7 PVC 10 Asbestos-cement
 2 Brass 4 Galvanized steel 6 Concrete tile 8 RMP (SR) 11 Other (specify) _____
 9 ABS 12 None used (open hole)

SCREEN OR PERFORATION OPENINGS ARE:
 1 Continuous slot 3 Mill slot 5 Gauzed wrapped 8 Saw cut 11 None (open hole)
 2 Louvered shutter 4 Key punched 6 Wire wrapped 9 Drilled holes
 7 Torch cut 10 Other (specify) _____

SCREEN-PERFORATED INTERVALS: From _____ ft. to _____ ft., From _____ ft. to _____ ft.
 From _____ ft. to _____ ft., From _____ ft. to _____ ft.
 GRAVEL PACK INTERVALS: From _____ ft. to _____ ft., From _____ ft. to _____ ft.
 From _____ ft. to _____ ft., From _____ ft. to _____ ft.

GROUT MATERIAL: 1 Neat cement 2 Cement grout 3 Bentonite 4 Other _____
 Grout Intervals: From 3 ft. to 6 ft., From _____ ft. to _____ ft., From _____ ft. to _____ ft.

What is the nearest source of possible contamination:
 1 Septic tank 4 Lateral lines 7 Pit privy 10 Livestock pens 14 Abandoned water well
 2 Sewer lines 5 Cess pool 8 Sewage lagoon 11 Fuel storage 15 Oil well/Gas well
 3 Watertight sewer lines 6 Seepage pit 9 Feedyard 12 Fertilizer storage 16 Other (specify below)
 13 Insecticide storage

Direction from well? _____ How many feet? _____

FROM	TO	LITHOLOGIC LOG	FROM	TO	LITHOLOGIC LOG
70	3	Cement	9.1	0	ft
cut off casing 3' below ground level					
filled entire casing with cement					
filled with surface silts from 3' below to Ground level					

CONTRACTOR'S OR LANDOWNER'S CERTIFICATION: This water well was (1) constructed, (2) reconstructed, or 3 plugged under my jurisdiction and was completed on (mo/day/year) 2-8-88 and this record is true to the best of my knowledge and belief. Kansas Water Well Contractor's License No. _____ This Water Well Record was completed on (mo/day/yr) 2-9-88 under the business name of Red Tiger Drilling Co by (signature) Clayton Engel

INSTRUCTIONS: Use typewriter or ball point pen. PLEASE PRESS FIRMLY and PRINT clearly. Please fill in blanks, underline or circle the correct answers. Send top three copies to Kansas Department of Health and Environment, Bureau of Water Protection, Topeka, Kansas 66620-7320, Telephone: 913-862-9360. Send one to WATER WELL OWNER and retain one for your records.