

WATER WELL PLUGGING RECORD Form WWC-5P KSA 82a-1212 ID NO.

MW6

| | | | | |
|--|------------------------------|----------------------|---------------------------|---|
| 1 LOCATION OF WATER WELL: County: Ness | Fraction ¼ SE ¼ NW ¼ NE ¼ | Section Number 31 | Township Number T 18 S | Range Number 23 <input type="checkbox"/> E <input checked="" type="checkbox"/> W |
|--|------------------------------|----------------------|---------------------------|---|

Street/Rural Address of Well Location; if unknown, distance & direction from nearest town or intersection: If at owner's address, check here

~130' SE of 520 S. Pennsylvania St., Ness City, KS 67560

Global Positioning Systems (GPS) information:
 Latitude: 38.44838065 (in decimal degrees)
 Longitude: -99.90399342 (in decimal degrees)
 Elevation: NA

Horizontal Datum WGS84, NAD83, NAD27
 Collection Method:
 GPS unit (Make/model: _____)
 Digital Map/Photo, Topographic Map Land Survey
 Est. Accuracy: <3 m, 3-5 m, 5-15 m, >15 m

2 WATER WELL OWNER: Harold Gable
 RR#, St. Address, Box #: 705 S. Topeka Ave
 City, State ZIP Code: Ness City, KS 67560

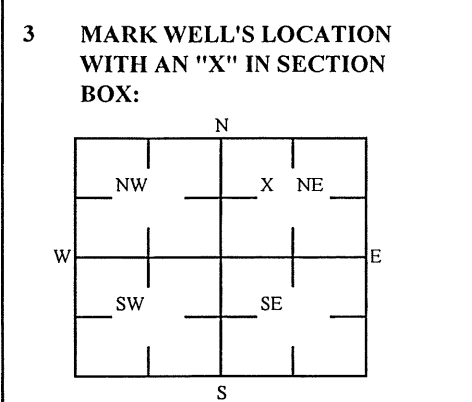

4 DEPTH OF WELL 38.9 ft.
 WELL'S STATIC WATER LEVEL _____ ft
 WELL WAS USED AS:
 Domestic Public Water Supply Dewatering
 Irrigation Oil Field Water Supply Monitoring
 Feedlot Domestic (Lawn & Garden) Injection Well
 Industrial Air Conditioning Other _____
 Was a chemical/bacteriological sample submitted to Department? Yes No

5 TYPE OF BLANK CASING USED:

| | | | | |
|---|-----------------------------------|--|--|---|
| <input type="checkbox"/> Steel | <input type="checkbox"/> RMP (SR) | <input type="checkbox"/> Wrought | <input type="checkbox"/> Fiberglass | <input type="checkbox"/> Other (Specific below) |
| <input checked="" type="checkbox"/> PVC | <input type="checkbox"/> ABS | <input type="checkbox"/> Asbestos-Cement | <input type="checkbox"/> Concrete Tile | |

Blank casing diameter _____ in. Was casing pulled? Yes No If yes, how much 3 ft
 Casing height above or below land surface NA in.

6 GROUT PLUG MATERIAL: Neat cement Cement grout Bentonite Other Soil: 0-3'

Grout Plug Intervals: From 3 ft to 38.9 ft, From _____ ft to _____ ft, From _____ ft to _____ ft,

What is the nearest source of possible contamination:

| | | | |
|---|---|--|--|
| <input type="checkbox"/> Septic tank | <input type="checkbox"/> Seepage pit | <input checked="" type="checkbox"/> Fuel storage | <input type="checkbox"/> Other (specify below) |
| <input type="checkbox"/> Sewer lines | <input type="checkbox"/> Pit privy | <input type="checkbox"/> Fertilizer storage | |
| <input type="checkbox"/> Watertight sewer lines | <input type="checkbox"/> Sewage lagoon | <input type="checkbox"/> Insecticide storage | |
| <input type="checkbox"/> Lateral lines | <input type="checkbox"/> Feed yard | <input type="checkbox"/> Abandoned water well | Direction from well? _____ |
| <input type="checkbox"/> Cess pool | <input type="checkbox"/> Livestock pens | <input type="checkbox"/> Oil well/Gas well | How many feet? _____ |

| FROM | TO | PLUGGING MATERIALS | FROM | TO | PLUGGING MATERIALS |
|------|------|--------------------|------|----|--------------------|
| 0 | 3 | Soil | | | |
| 3 | 38.9 | Bentonite | | | |
| | | | | | |
| | | | | | |
| | | | | | |
| | | | | | |
| | | | | | |
| | | | | | |
| | | | | | |
| | | | | | |

KDHE ID: Home Oil Co. Station #2; U6-068-00015

7 CONTRACTOR'S OR LANDOWNER'S CERTIFICATION: This water well was plugged under my jurisdiction and was completed on (mo/day/year) 4/3-4/23 and this record is true to the best of my knowledge and belief. Kansas Water Contractor's License No. 757. This Water Well Record was completed on (mo/day/year) 4/7/2023 under the business name of Larsen & Associates, Inc. By (signature) _____

Send one white copy to Kansas Department of Health & Environment, Geology Section, 1000 SW Jackson Street, Ste. 420, Topeka, KS 66612-1367. Send one copy to WATER WELL OWNER and retain one for your records. Visit us at <http://www.kdheks.gov/waterwell/index.html> Telephone 785-296-5524.

NOTE: Figures exhibited within this report are only to be used within the context of this report. Placement of property lines, wells, structures, and roads is based on the available information from county appraiser maps, surveys, site visits, and/or previous vendor reports and should be considered approximate.

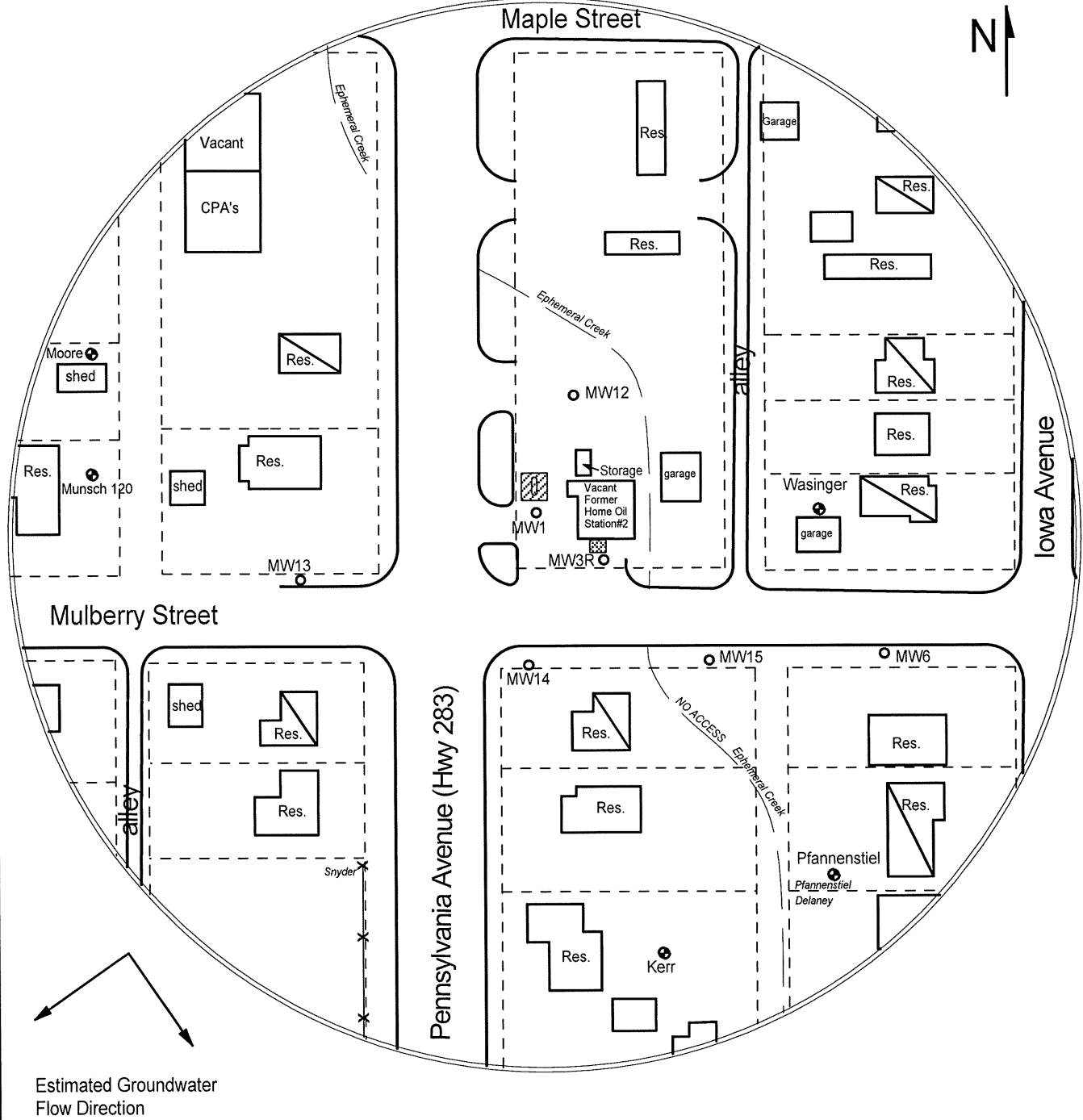

FIGURE 1 - 350 FT RADIUS AREA BASE MAP



1311 E 25th St. Suite B
Lawrence, KS 66046

785-841-8707 office
785-865-4282 fax

PROJECT:
Home Oil Co. Station #2
520 South Pennsylvania
Ness City, KS
KDHE ID: U6-068-00015
Date: 4/3-4/23

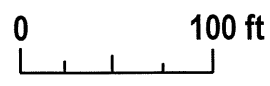

LEGEND:

- Approximate Location of Former UST Basin & Pump Island
- Approximate Location of Former Drainage Pit
- Building with Basement
- Approximate Location of Property Line
- Private Well
- Plugged Well