

WATER WELL PLUGGING RECORD Form WWC-5P KSA 82a-1212 ID NO.

MW1

1 LOCATION OF WATER WELL: County: Ness	Fraction ¼ SE ¼ NW ¼ NE ¼	Section Number 31	Township Number T 18 S	Range Number 23 <input type="checkbox"/> E <input checked="" type="checkbox"/> W
--	------------------------------	----------------------	---------------------------	---

Street/Rural Address of Well Location; if unknown, distance & direction from nearest town or intersection: If at owner's address, check here
520 S. Pennsylvania St., Ness City, KS 67560

Global Positioning Systems (GPS) information:
Latitude: 38.44863444 (in decimal degrees)
Longitude: -99.90481461 (in decimal degrees)
Elevation: NA

Horizontal Datum WGS84, NAD83, NAD27
Collection Method:

2 WATER WELL OWNER: Harold Gable
RR#, St. Address, Box #: 705 S. Topeka Ave
City, State ZIP Code: Ness City, KS 67560

GPS unit (Make/model: _____)
 Digital Map/Photo, Topographic Map Land Survey
Est. Accuracy: <3 m, 3-5 m, 5-15 m, >15 m

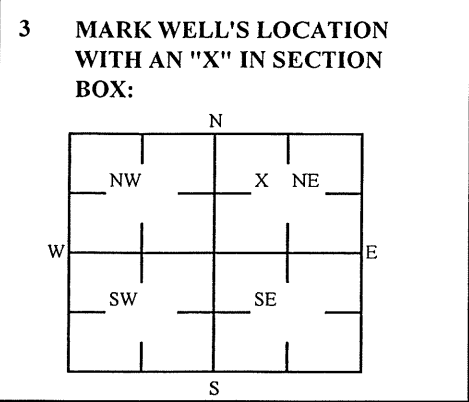

4 DEPTH OF WELL 44.5 ft.
WELL'S STATIC WATER LEVEL _____ ft
WELL WAS USED AS:
 Domestic Public Water Supply Dewatering
 Irrigation Oil Field Water Supply Monitoring
 Feedlot Domestic (Lawn & Garden) Injection Well
 Industrial Air Conditioning Other _____
Was a chemical/bacteriological sample submitted to Department? Yes No

5 TYPE OF BLANK CASING USED:
 Steel RMP (SR) Wrought Fiberglass Other (Specific below)
 PVC ABS Asbestos-Cement Concrete Tile
Blank casing diameter _____ in. Was casing pulled? Yes No If yes, how much 3 ft
Casing height above or below land surface NA in.

6 GROUT PLUG MATERIAL: Neat cement Cement grout Bentonite Other Concrete: 0-0.5'; Soil: 0.5-3'
Grout Plug Intervals: From 3 ft to 44.5 ft, From _____ ft to _____ ft, From _____ ft to _____ ft
What is the nearest source of possible contamination:
 Septic tank Seepage pit Fuel storage Other (specify below) _____
 Sewer lines Pit privy Fertilizer storage _____
 Watertight sewer lines Sewage lagoon Insecticide storage _____
 Lateral lines Feed yard Abandoned water well Direction from well? _____
 Cess pool Livestock pens Oil well/Gas well How many feet? _____

FROM	TO	PLUGGING MATERIALS	FROM	TO	PLUGGING MATERIALS
0	0.5	Concrete			
0.5	3	Soil			
3	44.5	Bentonite			

KDHE ID: Home Oil Co. Station #2; U6-068-00015

7 CONTRACTOR'S OR LANDOWNER'S CERTIFICATION: This water well was plugged under my jurisdiction and was completed on (mo/day/year) 4/3-4/23 and this record is true to the best of my knowledge and belief. Kansas Water Contractor's License No. 757. This Water Well Record was completed on (mo/day/year) 4/7/2025 under the business name of Larsen & Associates, Inc. By (signature) _____

Send one white copy to Kansas Department of Health & Environment, Geology Section, 1000 SW Jackson Street, Ste. 420, Topeka, KS 66612-1367. Send one copy to WATER WELL OWNER and retain one for your records
Visit us at <http://www.kdheks.gov/waterwell/index.html> Telephone 785-296-5524.

NOTE: Figures exhibited within this report are only to be used within the context of this report. Placement of property lines, wells, structures, and roads is based on the available information from county appraiser maps, surveys, site visits, and/or previous vendor reports and should be considered approximate.

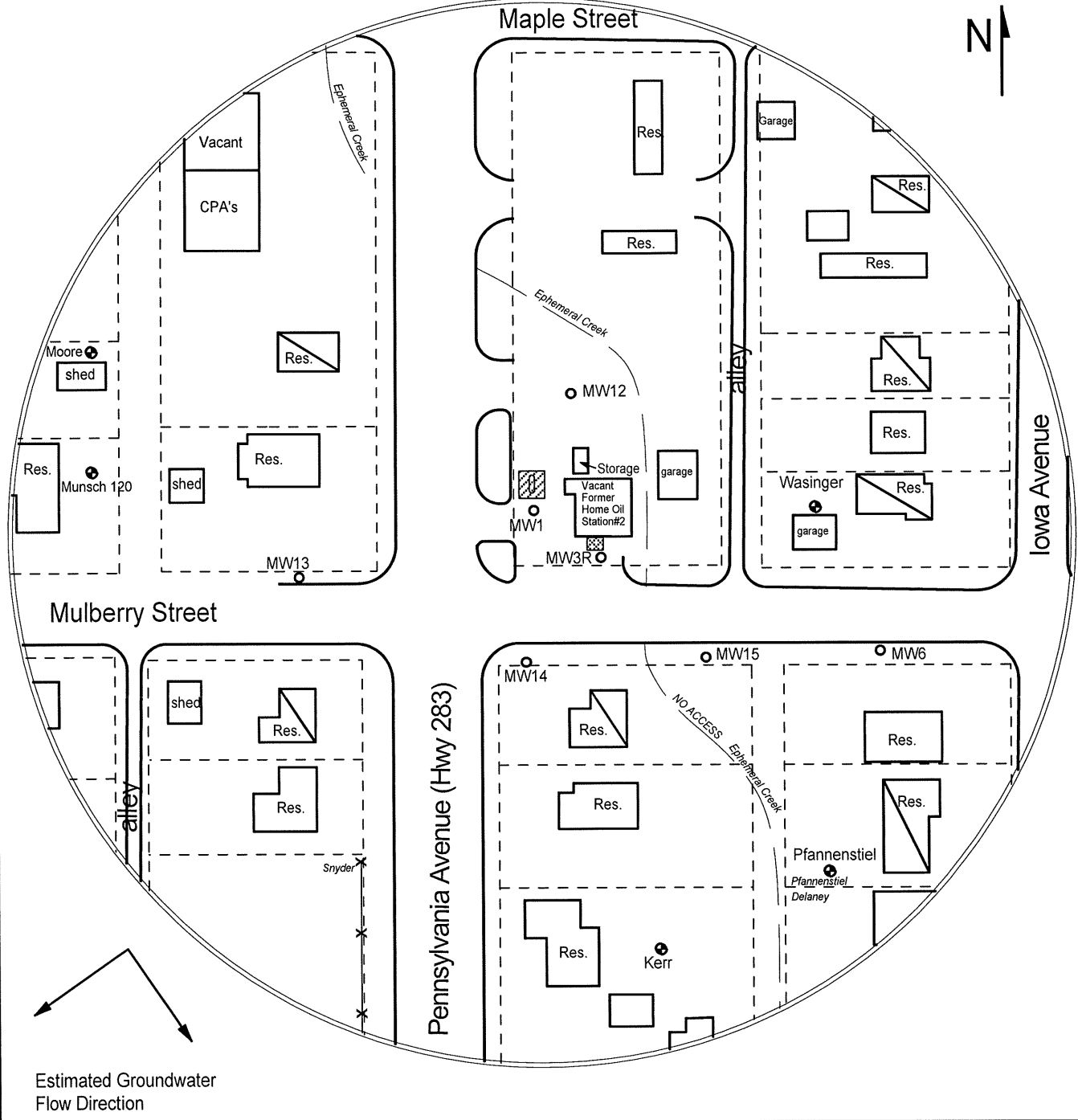

FIGURE 1 - 350 FT RADIUS AREA BASE MAP



PROJECT:
Home Oil Co. Station #2
520 South Pennsylvania
Ness City, KS
KDHE ID: U6-068-00015
Date: 4/3-4/23

- LEGEND:**
- Approximate Location of Former UST Basin & Pump Island
 - Approximate Location of Former Drainage Pit
 - Building with Basement
 - Approximate Location of Property Line
 - Private Well
 - Plugged Well

1311 E 25th St. Suite B
Lawrence, KS 66046

785-841-8707 office
785-865-4282 fax

