

**WATER WELL RECORD Form WWC-5**

Division of Water Resources App. No. \_\_\_\_\_

Well ID **MW-19**

Original Record  Correction  Change in Well Use

<b>1 LOCATION OF WATER WELL:</b> County: Lane	Fraction NW ¼ SE ¼ SW ¼ SE ¼	Section Number 18	Township Number T 18 S	Range Number R 28 <input type="checkbox"/> E <input checked="" type="checkbox"/> W
--	---------------------------------	----------------------	---------------------------	---

<b>2 WELL OWNER:</b> Last Name: First: Street or Rural Address where well is located (if unknown, distance and direction from nearest town or intersection): If at owner's address, check here: <input type="checkbox"/> Business: USD 482 Address: PO Box 878 Address: City: Dighton State: KS ZIP: 67839 120' south of Annabelle, 28' west of Delaware; 320 E James, Dighton
---

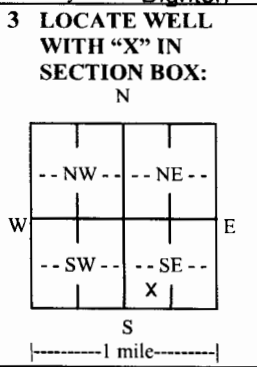

**4 DEPTH OF COMPLETED WELL:** 68.2 ft.  
Depth(s) Groundwater Encountered: 1) \_\_\_\_\_ ft.  
2) \_\_\_\_\_ ft. 3) \_\_\_\_\_ ft., or 4)  Dry Well  
WELL'S STATIC WATER LEVEL: 57.68 ft.  
 below land surface, measured on (mo-day-yr) 8/2/2021  
 above land surface, measured on (mo-day-yr) \_\_\_\_\_  
Pump test data: Well water was \_\_\_\_\_ ft.  
after \_\_\_\_\_ hours pumping \_\_\_\_\_ gpm  
Well water was \_\_\_\_\_ ft.  
after \_\_\_\_\_ hours pumping \_\_\_\_\_ gpm  
Estimated Yield: \_\_\_\_\_ gpm  
Bore Hole Diameter: 8.5 in. to 69 ft. and \_\_\_\_\_ in. to \_\_\_\_\_ ft.

**5 Latitude:** 38.483721 (decimal degrees)  
**Longitude:** 100.454768 (decimal degrees)  
Horizontal Datum:  WGS 84  NAD 83  NAD 27  
Source for Latitude/Longitude:  
 GPS (unit make/model: EPOCH)  
(WAAS enabled?  Yes  No)  
 Land Survey  Topographic Map  
 Online Mapper: \_\_\_\_\_

**6 Elevation:** 2763.30 ft.  Ground Level  TOC  
Source:  Land Survey  GPS  Topographic Map  
 Other \_\_\_\_\_

**7 WELL WATER TO BE USED AS:**

1. Domestic: <input type="checkbox"/> Household <input type="checkbox"/> Lawn & Garden <input type="checkbox"/> Livestock	2. Irrigation	3. Feedlot	4. Industrial	5. <input type="checkbox"/> Public Water Supply: well ID _____	6. <input type="checkbox"/> Dewatering: how many wells? _____	7. <input type="checkbox"/> Aquifer Recharge: well ID _____	8. <input checked="" type="checkbox"/> Monitoring: well ID MW-19	9. Environmental Remediation: well ID _____ <input type="checkbox"/> Air Sparge <input type="checkbox"/> Soil Vapor Extraction <input type="checkbox"/> Recovery <input type="checkbox"/> Injection	10. <input type="checkbox"/> Oil Field Water Supply: lease _____	11. Test Hole: well ID _____ <input type="checkbox"/> Cased <input type="checkbox"/> Uncased <input type="checkbox"/> Geotechnical	12. Geothermal: how many bores? _____ a) Closed Loop <input type="checkbox"/> Horizontal <input type="checkbox"/> Vertical b) Open Loop <input type="checkbox"/> Surface Discharge <input type="checkbox"/> Inj. of Water	13. <input type="checkbox"/> Other (specify): _____
--	---------------	------------	---------------	--	---	---	--	---	--	---	---	---

Was a chemical/bacteriological sample submitted to KDHE?  Yes  No If yes, date sample was submitted: \_\_\_\_\_  
Water well disinfected?  Yes  No

**8 TYPE OF CASING USED:**  Steel  PVC  Other \_\_\_\_\_ CASING JOINTS:  Glued  Clamped  Welded  Threaded  
Casing diameter 2 in. to 68.2 ft., Diameter \_\_\_\_\_ in. to \_\_\_\_\_ ft., Diameter \_\_\_\_\_ in. to \_\_\_\_\_ ft.  
Casing height above land surface 5 in. Weight \_\_\_\_\_ lbs./ft. Wall thickness or gauge No. \_\_\_\_\_  
TYPE OF SCREEN OR PERFORATION MATERIAL:  
 Steel  Stainless Steel  Fiberglass  PVC  Other (Specify) \_\_\_\_\_  
 Brass  Galvanized Steel  Concrete tile  None used (open hole)  
SCREEN OR PERFORATION OPENINGS ARE:  
 Continuous Slot  Mill Slot  Gauze Wrapped  Torch Cut  Drilled Holes  Other (Specify) \_\_\_\_\_  
 Louvered Shutter  Key Punched  Wire Wrapped  Saw Cut  None (Open Hole)  
SCREEN-PERFORATED INTERVALS: From 48 ft. to 68.2 ft., From \_\_\_\_\_ ft. to \_\_\_\_\_ ft., From \_\_\_\_\_ ft. to \_\_\_\_\_ ft.  
GRAVEL PACK INTERVALS: From 45.8 ft. to 69 ft., From \_\_\_\_\_ ft. to \_\_\_\_\_ ft., From \_\_\_\_\_ ft. to \_\_\_\_\_ ft.

**9 GROUT MATERIAL:**  Neat cement  Cement grout  Bentonite  Other \_\_\_\_\_  
Grout Intervals: From 1 ft. to 45.8 ft., From \_\_\_\_\_ ft. to \_\_\_\_\_ ft., From \_\_\_\_\_ ft. to \_\_\_\_\_ ft.  
Nearest source of possible contamination:  
 Septic Tank  Lateral Lines  Pit Privy  Livestock Pens  Insecticide Storage  
 Sewer Lines  Cess Pool  Sewage Lagoon  Fuel Storage  Abandoned Water Well  
 Watertight Sewer Lines  Seepage Pit  Feedyard  Fertilizer Storage  Oil Well/Gas Well  
 Other (Specify) \_\_\_\_\_  
Direction from well? \_\_\_\_\_ Distance from well? \_\_\_\_\_ ft.

10 FROM	TO	LITHOLOGIC LOG	FROM	TO	LITHO. LOG (cont.) or PLUGGING INTERVALS
0	1	Grass/top soil			
1	8	Silt, then clay			
8	26	Clay with caliche and trace sand			
26	37	Clay and caliche with trace sand			
37	45	Sand, sandy clay w/caliche, trace gravel			
45	54	Clay, with sandy clay			
54	60	Caliche with trace clay			
60	63	Sand with gravel, clay, and caliche			
63	69	Caliche, with clay and trace sand			

**11 CONTRACTOR'S OR LANDOWNER'S CERTIFICATION:** This water well was  constructed,  reconstructed, or  plugged under my jurisdiction and was completed on (mo-day-year) 7/28/2021 and this record is true to the best of my knowledge and belief. Kansas Water Well Contractor's License No. 881. This Water Well Record was completed on (mo-day-year) 1. \_\_\_\_\_ under the business name of Wootter Pump and Well. Signature: \_\_\_\_\_

Mail 1 white copy along with a fee of \$5.00 for each constructed well to: Kansas Department of Health and Environment, Bureau of Water, KWTS Section, 1000 SW Jackson St., Suite 420, Topeka, Kansas 66612-1367. Mail one to Water Well Owner and retain one for your records. Telephone 785-296-5524.  
Visit us at <http://www.kdheks.gov/waterwell/index.html> KSA 82a-1212 **Revised 7/10/2015**

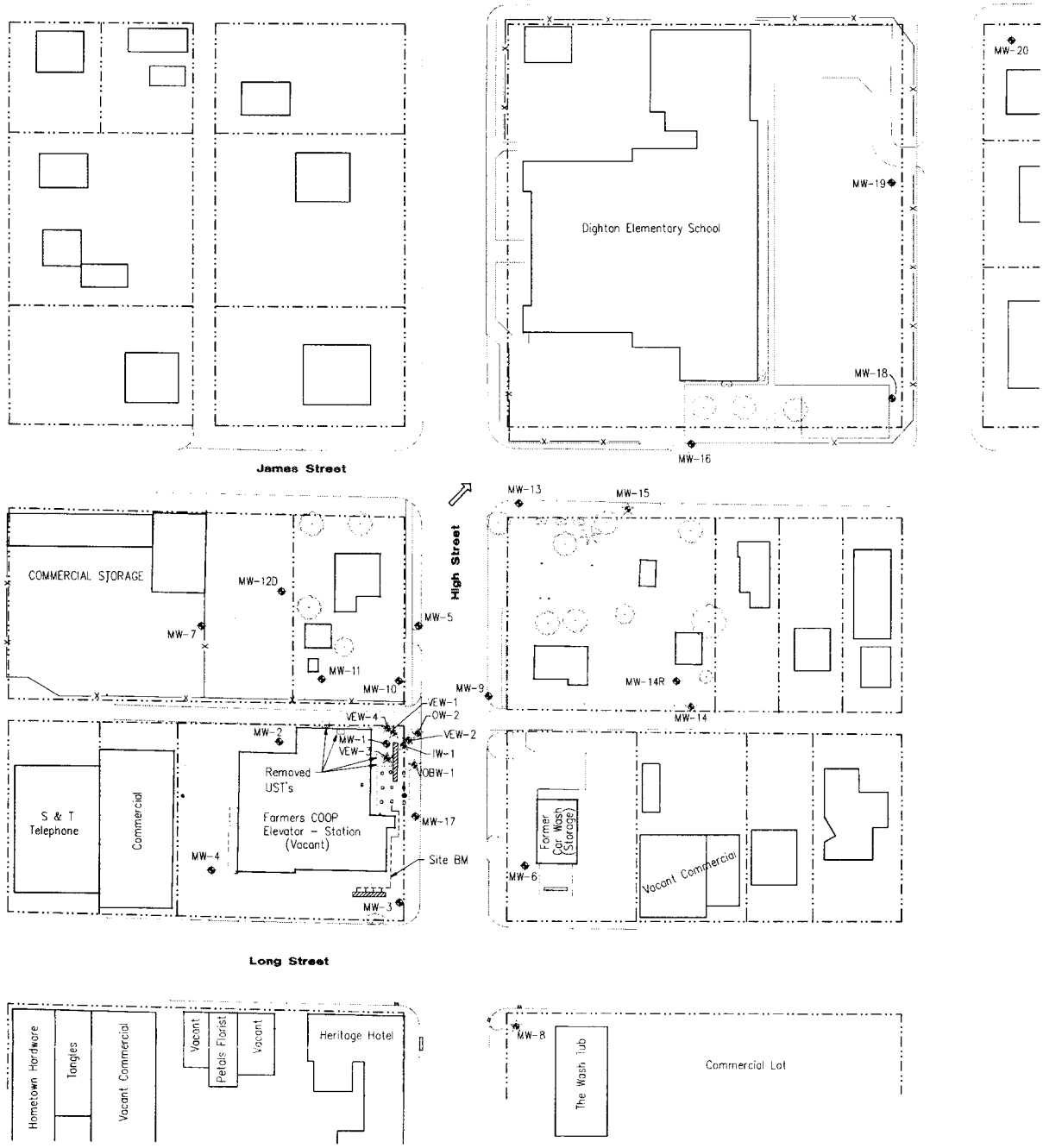

**LEGEND**

- = MONITORING WELL
- = ABANDONED/PLUGGED WELL
- = EXISTING PUMP ISLANDS
- = EXISTING UNDERGROUND STORAGE TANKS
- = FENCE
- = APPROXIMATE ROW LINES
- = GROUNDWATER FLOW DIRECTION

NOTE:  
 PROPERTIES ARE RESIDENTIAL UNLESS  
 OTHERWISE INDICATED.

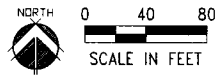

**FIGURE A**

SCALE	AS SHOWN
PROJECT NO.	271-P1-03
DATE	AUGUST 2021
FIELD BOOK	18A (CONE) NO. 859
TITLE	271-P1-03
DRAWN BY	ASB/BJ
CHECKED BY	
DATE	

**FARMERS COOP ELEVATOR-STATION**  
**SITE BASE MAP**  
 239 E. LONG STREET, DIGHTON, KS U1-051-12966

**MILCO**  
 Environmental Services, Inc.  
 1400 W. 10th Street, Suite 200  
 Dighton, KS 66425  
 Phone: 785.923.5523  
 Fax: 785.923.5524  
 Email: info@milcoenv.com