

WATER WELL PLUGGING RECORD Form WWC-5P

KSA 82a-1212

ID NO.

EVO-79

1 LOCATION OF WATER WELL: County: McPherson	Fraction $\frac{1}{4}$ $\frac{1}{4}$ NE $\frac{1}{4}$ NW $\frac{1}{4}$	Section Number 22	Township Number T 18 S	Range Number 3 <input type="checkbox"/> E <input checked="" type="checkbox"/> W
---	---	----------------------	---------------------------	--

Street/Rural Address of Well Location; if unknown, distance & direction from nearest town or intersection: If at owner's address, check here 1500 Pueblo Road
McPherson, Kansas 67460

Global Positioning Systems (GPS) information:
Latitude: 38.476668 (in decimal degrees)
Longitude: -97.641949 (in decimal degrees)
Elevation: 1523.03
Horizontal Datum: WGS84, NAD83, NAD27
Collection Method:

2 WATER WELL OWNER: USACE - CENWK (KS City)
RR#, St. Address, Box #: 601 E 12th Street - Room 460
City, State ZIP Code: Kansas City, Missouri 64106

GPS unit (Make/Model: _____)
 Digital Map/Photo, Topographic Map, Land Survey
Est. Accuracy: < 3 m, 3-5 m, 5-15 m, > 15 m

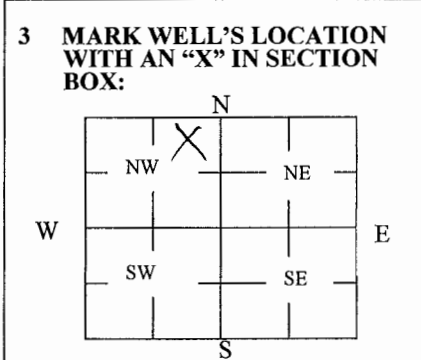

4 DEPTH OF WELL 66.0 ft.
WELL'S STATIC WATER LEVEL ~ 31' ft
WELL WAS USED AS:

<input type="checkbox"/> Domestic	<input type="checkbox"/> Public Water Supply	<input type="checkbox"/> Dewatering
<input type="checkbox"/> Irrigation	<input type="checkbox"/> Oil Field Water Supply	<input type="checkbox"/> Monitoring
<input type="checkbox"/> Feedlot	<input type="checkbox"/> Domestic (Lawn & Garden)	<input checked="" type="checkbox"/> Injection Well
<input type="checkbox"/> Industrial	<input type="checkbox"/> Air Conditioning	<input type="checkbox"/> Other _____

Was a chemical/bacteriological sample submitted to Department? Yes No

5 TYPE OF BLANK CASING USED:

<input type="checkbox"/> Steel	<input type="checkbox"/> RMP (SR)	<input type="checkbox"/> Wrought	<input type="checkbox"/> Fiberglass	<input type="checkbox"/> Other (Specify below)
<input checked="" type="checkbox"/> PVC	<input type="checkbox"/> ABS	<input type="checkbox"/> Asbestos-Cement	<input type="checkbox"/> Concrete Tile	

Blank casing diameter 4 in. Was casing pulled? Yes No If yes, how much About 3 feet
Casing height above or below land surface -0.5 in.

6 GROUT PLUG MATERIAL: Neat cement Cement grout Bentonite Other _____

Grout Plug Intervals: From 2 ft. to 66.0 ft., From _____ ft. to _____ ft., From _____ ft. to _____ ft.

What is the nearest source of possible contamination:

<input type="checkbox"/> Septic tank	<input type="checkbox"/> Seepage pit	<input type="checkbox"/> Fuel storage	<input type="checkbox"/> Other (specify below)
<input type="checkbox"/> Sewer lines	<input type="checkbox"/> Pit privy	<input type="checkbox"/> Fertilizer storage	
<input type="checkbox"/> Watertight sewer lines	<input type="checkbox"/> Sewage lagoon	<input type="checkbox"/> Insecticide storage	
<input type="checkbox"/> Lateral lines	<input type="checkbox"/> Feedyard	<input type="checkbox"/> Abandoned water well	Direction from well? _____
<input type="checkbox"/> Cess pool	<input type="checkbox"/> Livestock pens	<input type="checkbox"/> Oil well/Gas well	How many feet? _____

FROM	TO	PLUGGING MATERIALS	FROM	TO	PLUGGING MATERIALS
0	2	Top soil			
2	66.0	Bentonite			

7 CONTRACTOR'S OR LANDOWNER'S CERTIFICATION: This water well was plugged under my jurisdiction and was completed on (mo/day/year) 12/6/17 and this record is true to the best of my knowledge and belief. Kansas Water Well Contractor's License No. 597. This Water Well Record was completed on (mo/day/year) 12/12/17 under the business name of Los Alamos Technical Associates, Inc./Cascade by (signature) Ray Wel, CPG

Send one white copy to Kansas Department of Health & Environment, Geology Section, 1000 SW Jackson Street, Ste. 420, Topeka, KS 66612-1367. Send one copy to WATER WELL OWNER and retain one for your records.
Visit us at <http://www.kdheks.gov/waterwell/index.html> Telephone 785-296-5524.