

CORRECTION(S) TO WATER WELL RECORD (WWC-5)

(to rectify lacking or incorrect information)

County: Scott

Location listed as:

Section-Township-Range: 18-185-32W

Fraction ($\frac{1}{4}$ $\frac{1}{4}$ $\frac{1}{4}$): None Given

Location changed to:

18-185-32W

NW SW SW

Other changes: Initial statements: _____

Changed to: _____

Comments: _____

verification method: Well address, attached map, city street map on internet, and Scott City 1:24,000 topo. map.

initials: ARD date: 10/12/2005

1 LOCATION OF WATER WELL: Fraction $\frac{1}{4}$ $\frac{1}{4}$ $\frac{1}{4}$ Section Number 18 Township Number T 18 S Range Number R 32 E 20
 County: Scott

Distance and direction from nearest town or city street address of well if located within city?
222 South Main Street, Scott City, Kansas 67871

2 WATER WELL OWNER: Presta Oil Inc
 RR#, St. Address, Box #: 1109 Hattie Street
 City, State, ZIP Code: Garden City, KS 67846
 Board of Agriculture, Division of Water Resources
 Application Number:

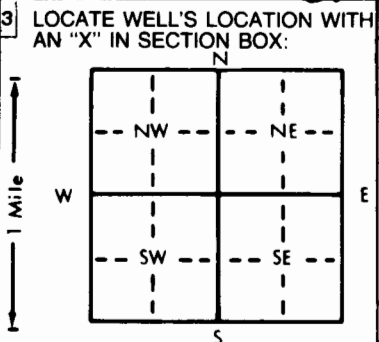

4 DEPTH OF COMPLETED WELL: 155 ft. ELEVATION:
 Depth(s) Groundwater Encountered 1. 145 ft. 2. ft. 3. ft.
 WELL'S STATIC WATER LEVEL: 145 ft. below land surface measured on mo/day/yr 7-9-05
 Pump test data: Well water was ft. after hours pumping gpm
 Est. Yield 1.5 gpm: Well water was ft. after hours pumping gpm
 Bore Hole Diameter: 8 in. to 1.55 ft. and in. to ft.
 WELL WATER TO BE USED AS:
 5 Public water supply 8 Air conditioning 11 Injection well
 1 Domestic 3 Feedlot 6 Oil field water supply 9 Dewatering 12 Other (Specify below)
 2 Irrigation 4 Industrial 7 Lawn and garden only 10 Monitoring well
 Was a chemical/bacteriological sample submitted to Department? Yes No; If yes, mo/day/yr sample was submitted
 Water Well Disinfected? Yes No

5 TYPE OF BLANK CASING USED:
 1 Steel PVC 3 RMP (SR) 4 ABS 5 Wrought iron 6 Asbestos-Cement 7 Fiberglass 8 Concrete tile 9 Other (specify below) CASING JOINTS: Glued Clamped Welded Threaded
 Blank casing diameter: 4 in. to 135 ft., Dia. in. to ft., Dia. in. to ft.
 Casing height above land surface: 0 in., weight 2.006 lbs./ft. Wall thickness or gauge No. 237
 TYPE OF SCREEN OR PERFORATION MATERIAL:
 1 Steel 2 Brass 3 Stainless steel 4 Galvanized steel 5 Fiberglass 6 Concrete tile 7 RMP (SR) 8 ABS 9 Other (specify) 10 Asbestos-cement 11 Other (specify) 12 None used (open hole)
 SCREEN OR PERFORATION OPENINGS ARE:
 1 Continuous slot 2 Louvered shutter 3 Mill slot 4 Key punched 5 Gauzed wrapped 6 Wire wrapped 7 Torch cut 8 Saw cut 9 Drilled holes 10 Other (specify) 11 None (open hole)
 SCREEN-PERFORATED INTERVALS: From 135 ft. to 155 ft., From ft. to ft.
 GRAVEL PACK INTERVALS: From 130 ft. to 155 ft., From ft. to ft.

6 GROUT MATERIAL: 1 Neat cement 2 Cement grout 3 Bentonite 4 Other
 Grout intervals: From 0 ft. to 130 ft., From ft. to ft., From ft. to ft.
 What is the nearest source of possible contamination:
 1 Septic tank 2 Sewer lines 3 Watertight sewer lines 4 Lateral lines 5 Cess pool 6 Seepage pit 7 Pit privy 8 Sewage lagoon 9 Feedyard 10 Livestock pens 11 Fuel storage 12 Fertilizer storage 13 Insecticide storage 14 Abandoned water well 15 Oil well/Gas well 16 Other (specify below)
 Direction from well? How many feet?

FROM	TO	LITHOLOGIC LOG	FROM	TO	PLUGGING INTERVALS
0	10	Brown Sand			
10	40	Brown Silty Sand			
40	142	Brown Clay			
142	155	Brown Sand			

MW-26

7 CONTRACTOR'S OR LANDOWNER'S CERTIFICATION: This water well was (1) constructed, (2) reconstructed, or (3) plugged under my jurisdiction and was completed on (mo/day/year) 7-7-05 and this record is true to the best of my knowledge and belief. Kansas Water Well Contractor's License No. 658 This Water Well Record was completed on (mo/day/yr) 9-20-05 under the business name of Boart Longyear by (signature) [Signature]

Scott County
277 South Main

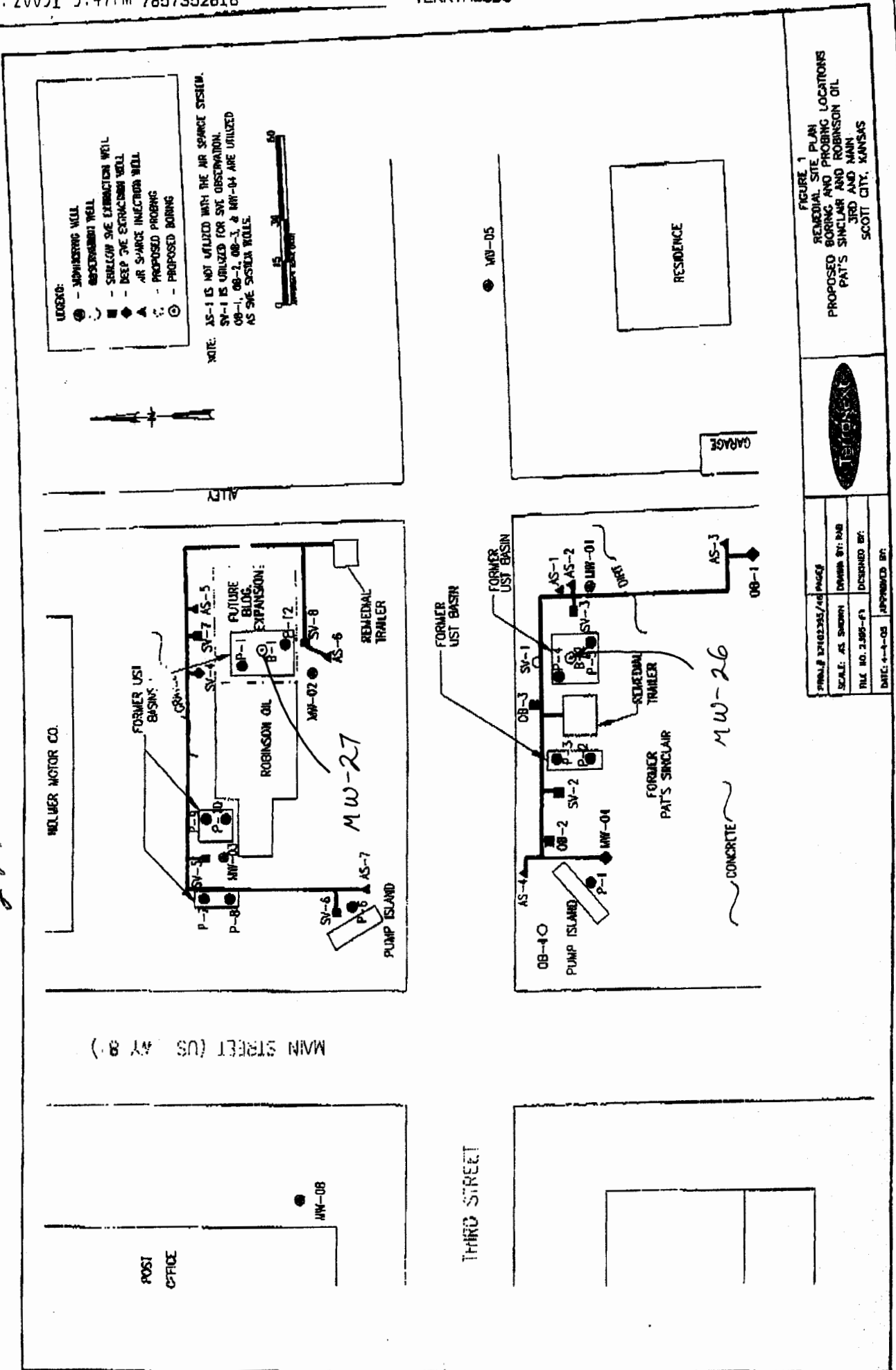

FIGURE 1
REMEDIAL SITE PLAN
PROPOSED BORING AND PROBING LOCATIONS
PAT'S SINGLAIR AND ROBINSON OIL
3RD AND MAIN
SCOTT CITY, KANSAS



FORMAL EXHIBITS / # OF PAGES	
SCALE: AS SHOWN	DRAWN BY: RAB
FILE NO. 2.895-F3	DESIGNED BY:
DATE: 4-1-05	APPROVED BY: