

WATER WELL RECORD

Form WWC-5

Division of Water Resources App. No.

[Empty box for application number]

1 LOCATION OF WATER WELL: County: Greeley Fraction se 1/4 nw 1/4 ne 1/4 ne 1/4 Section Number 29 Township No. T 18 S Range Number R 40 [E] [W]

Street/Rural Address of Well Location; if unknown, distance & direction from nearest town or intersection: If at owner's address, check here [X]. MW 9R

Global Positioning System (GPS) information: Latitude: Longitude: Elevation: Datum: Collection Method: Est. Accuracy:

2 WATER WELL OWNER: United Plains Ac RR#, Street Address, Box #: Tribune Ks City, State, ZIP Code : 67879

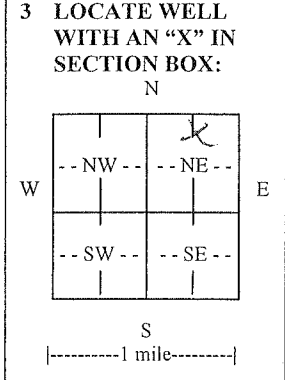

3 LOCATE WELL WITH AN 'X' IN SECTION BOX: 4 DEPTH OF COMPLETED WELL 108 ft. Depth(s) Groundwater Encountered (1) 92 ft. (2) ft. (3) ft. WELL'S STATIC WATER LEVEL 92 ft. below land surface measured on mo/day/yr. 1/13/12 Pump test data: Well water was ft. after hours pumping gpm EST. YIELD gpm. Well water was ft. after hours pumping gpm Bore Hole Diameter 9.5 in. to 108 ft., and in. to ft. WELL WATER TO BE USED AS: [X] Public water supply [] Geothermal [] Injection well [] Domestic [] Feedlot [] Oil field water supply [] Dewatering [] Other (Specify below) [] Irrigation [] Industrial [] Domestic-lawn & garden [X] Monitoring well Was a chemical/bacteriological sample submitted to Department? [] Yes [X] No If yes, mo/day/yr sample was submitted. Water well disinfected? [] Yes [X] No

5 TYPE OF CASING USED: [] Steel [X] PVC [] Other CASING JOINTS: [] Glued [] Clamped [] Welded [X] Threaded Casing diameter 4 in. to .83 ft., Diameter in. to ft., Diameter in. to ft. Casing height above land surface 0 in., Weight sch 40 lbs./ft., Wall thickness or gauge No. TYPE OF SCREEN OR PERFORATION MATERIAL: [] Steel [] Stainless Steel [X] PVC [] Other (Specify) [] Brass [] Galvanized Steel [] None used (open hole) SCREEN OR PERFORATION OPENINGS ARE: [] Continuous slot [X] Mill slot [] Gauze wrapped [] Torch cut [] Drilled holes [] None (open hole) [] Louvered shutter [] Key punched [] Wire wrapped [] Saw cut [] Other (specify) SCREEN-PERFORATED INTERVALS: From 108 ft. to .83 ft., From ft. to ft. GRAVEL PACK INTERVALS: From 108 ft. to .76 ft., From ft. to ft. From ft. to ft., From ft. to ft.

6 GROUT MATERIAL: [] Neat cement [X] Cement grout [] Bentonite [] Other Grout Intervals: From .76 ft. to 0 ft., From ft. to ft., From ft. to ft. What is the nearest source of possible contamination: [] Septic tank [] Lateral lines [] Pit privy [] Livestock pens [] Insecticide storage [] Other (specify below) [] Sewer lines [] Cesspool [] Sewage lagoon [X] Fuel storage [] Abandoned water well [] Watertight sewer lines [] Seepage pit [] Feedyard [] Fertilizer storage [] Oil well/gas well [] Old fuel storage sit Direction from well east Distance from well 100

Table with columns: FROM, TO, LITHOLOGIC LOG, FROM, TO, LITHO. LOG (cont.) or PLUGGING INTERVALS. Rows: 0-60 Sand, 60-85 Sand with Clechey, 85-108 Sand with Large gravel.

7 CONTRACTOR'S OR LANDOWNER'S CERTIFICATION: This water well was [X] constructed, [] reconstructed, or [] plugged under my jurisdiction and was completed on (mo/day/year) 1/13/12 and this record is true to the best of my knowledge and belief. Kansas Water Well Contractor's License No. 665. This Water Well Record was completed on (mo/day/year) 1/26/12 under the business name of Pratt Well Service Inc. by (signature) [Signature]

INSTRUCTIONS: Use typewriter or ball point pen. PLEASE PRESS FIRMLY and PRINT clearly. Please fill in blanks and check the correct answers. Send three copies (white, blue, pink) to Kansas Department of Health and Environment, Bureau of Water, Geology Section, 1000 SW Jackson St., Suite 420, Topeka, Kansas 66612-1367. Telephone 785-296-5522. Send one copy to WATER WELL OWNER and retain one for your records. Include fee of \$5.00 for each constructed well. Visit us at http://www.kdheks.gov/waterwell/index.html.