

USE TYPEWRITER OR BALL POINT PEN-PRESS FIREPEN, PRINT CLEARLY.

WATER WELL RECORD
KSA 82a-1201-1215

Kansas Department of Health and Environment-Division of Environment
(Water well Contractors)
Topeka, Kansas 66620

Location of well: **McKAY PERSON** County: **McPherson** Fraction: **NE 1/4 SE 1/4** Section number: **19** Township number: **T 18** Range number: **S R 5 NW**

2. Distance and direction from nearest town or city: **3 East 4 mi. Winona, KS**
Street address of well location if in city:
3. Owner of well: **ADISON ELWOOD**
R.R. or street: **RR I Winona, KS 67491**
City, state, zip code:

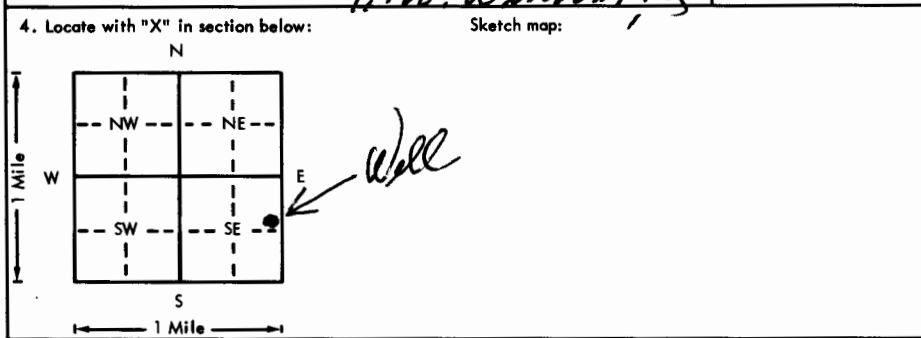

6. Bore hole dia. **8** in. Completion date: **11-3-76**
Well depth: **11-3-76**
7. Cable tool Rotary Driven Dug
 Hollow rod Jetted Bored Reverse rotary
8. Use: Domestic Public supply Industry
 Irrigation Air conditioning Stock
 Lawn Oil field water Other
9. Casing: Material **PVC** Height: Above or below
Threaded Welded Surface **12** in.
RMP PVC Weight lbs./ft.
Dia. **4** in. to **60** ft. depth Wall Thickness: inches or
Dia. in. to ft. depth gage No. **3/16 2 in**

5. Type and color of material	From	To
TOP SOIL	0	5
SHALE BLUE	5	16
SHALE - GRAY soft	16	30
SHALE - BLUE	30	45
SHALE - RED + GREEN	45	58
SHALE - Red Dark	58	60
Cased 60 ft.		

10. Screens: Manufacturer's name: **Peterson**
Type: **PVC** Dia. **4"**
Slot/gauze: **48** Length: **10**
Set between **50** ft. and **60** ft.
ft. and ft.
Gravel pack? **Yes** Size range of material: **1/4"**
11. Static water level: **17** ft. below land surface Date: **11-3-76** mo./day/yr.
12. Pumping level below land surfaces:
27 ft. after **2** hrs. pumping **10** g.p.m.
 ft. after hrs. pumping g.p.m.
Estimated maximum yield **10** g.p.m.
13. Water sample submitted: Yes No Date: mo./day/yr.
14. Well head completion: **no**
 Pitless adapter inches above grade
15. Well grouted? **yes**
With: Neat cement Bentonite Concrete
Depth: From **0** ft. to **10** ft.
16. Nearest source of possible contamination: **Sept tank**
ft. **500** Direction **NE** Type **Sept tank**
Well disinfected upon completion? Yes No
17. Pump: Not installed
Manufacturer's name:
Model number: HP: Volts:
Length of drop pipe: ft. capacity: g.p.m.
Type:
 Submersible Turbine
 Jet Reciprocating
 Centrifugal Other

18. Elevation: Topography: Hill Slope Upland Valley
19. Remarks:
20. Water well contractor's certification:
This well was drilled under my jurisdiction and this report is true to the best of my knowledge and belief.
Peterson Drilling Inc 138A
Business name License No.
Address **307 150 Lindbergh, KS**
Signed **Walker Peterson** Date **12-9-76**
Authorized representative