

WATER WELL PLUGGING RECORD Form WWC-5P

KSA 82a-1212

ID NO.

1 LOCATION OF WATER WELL: County: Barton	Fraction SE ¼ SE ¼ SW ¼ SW ¼	Section Number 29	Township Number T 19 S	Range Number 13 <input type="checkbox"/> E <input checked="" type="checkbox"/> W
----------------------------------------------------	---------------------------------	-----------------------------	----------------------------------	--------------------------------------------------------------------------------------------

Street/Rural Address of Well Location; if unknown, distance & direction from nearest town or intersection: If at owner's address, check here

3700 W. 10th Street, Great Bend, KS

Global Positioning Systems (GPS) information:

Latitude: 38.36213 (in decimal degrees)

Longitude: 98.78905 (in decimal degrees)

Elevation: 1860.42

Datum: WGS84, NAD83, NAD27

Collection Method:

GPS unit (Make/Model: _____)

Digital Map/Photo, Topographic Map, Land Survey

Est. Accuracy: < 3 m, 3-5 m, 5-15 m, > 15 m

2 WATER WELL OWNER: Former Presto #19
RR#, St. Address, Box #: 3700 W. 10th Street
City, State ZIP Code: Great Bend, KS

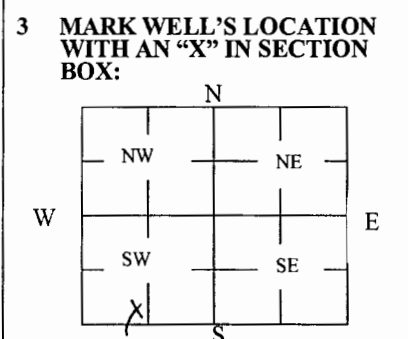

4 DEPTH OF WELL 26.63 ft.

WELL'S STATIC WATER LEVEL 15.59 ft

WELL WAS USED AS:

<input type="checkbox"/> Domestic	<input type="checkbox"/> Public Water Supply	<input type="checkbox"/> Dewatering
<input type="checkbox"/> Irrigation	<input type="checkbox"/> Oil Field Water Supply	<input type="checkbox"/> Monitoring
<input type="checkbox"/> Feedlot	<input type="checkbox"/> Domestic (Lawn & Garden)	<input type="checkbox"/> Injection Well
<input type="checkbox"/> Industrial	<input type="checkbox"/> Air Conditioning	<input type="checkbox"/> Other _____

Was a chemical/bacteriological sample submitted to Department? Yes No

5 TYPE OF BLANK CASING USED:

Steel RMP (SR) Wrought Fiberglass Other (Specify below) _____

PVC ABS Asbestos-Cement Concrete Tile

Blank casing diameter 2 in. Was casing pulled? Yes No If yes, how much _____

Casing height above or below land surface -0.54 in.

6 GROUT PLUG MATERIAL: Neat cement Cement grout Bentonite Other _____

Grout Plug Intervals: From 0 ft. to 26.63 ft., From _____ ft. to _____ ft., From _____ to _____ ft.

What is the nearest source of possible contamination:

<input type="checkbox"/> Septic tank	<input type="checkbox"/> Seepage pit	<input type="checkbox"/> Fuel Storage	<input checked="" type="checkbox"/> Other (specify below)
<input type="checkbox"/> Sewer lines	<input type="checkbox"/> Pit privy	<input type="checkbox"/> Fertilizer storage	<u>LUST SITE</u>
<input type="checkbox"/> Watertight sewer lines	<input type="checkbox"/> Sewage lagoon	<input type="checkbox"/> Insecticide storage	
<input type="checkbox"/> Lateral lines	<input type="checkbox"/> Feedyard	<input type="checkbox"/> Abandoned water well	Direction from well? _____
<input type="checkbox"/> Cess pool	<input type="checkbox"/> Livestock pens	<input type="checkbox"/> Oil well/Gas well	How many feet? _____

FROM	TO	PLUGGING MATERIALS	FROM	TO	PLUGGING MATERIALS
0	26.63	Bentonite			AS6

7 CONTRACTOR'S OR LANDOWNER'S CERTIFICATION: This water well was plugged under my jurisdiction and was completed on (mo/day/year) 12/9/14 and this record is true to the best of my knowledge and belief. Kansas Water Well Contractor's License No. 594. This Water Well Record was completed on (mo/day/year) 1/9/2014 under the business name of Coranco Great Plains Inc. by (signature) [Signature]

INSTRUCTIONS: Use typewriter or ballpoint pen. Please press firmly and print clearly. Please fill in blanks, underline or circle the correct answers. Send top three copies to Kansas Department of Health and Environment, Bureau of Water, Geology Section, 1000 SW Jackson St., Ste. 420, Topeka, Kansas 66612-1367. Telephone: 785/296-5524. Send one to Water Well Owner and retain one for your records. Visit us at <http://www.kdheks.gov/waterwell/index.html>.

Check one: White Copy Blue Copy Pink Copy