

MW2

☒ Original Record ☐ Correction ☐ Change in Well Use

Well ID

[illegible]

Barton

32-19-15 N

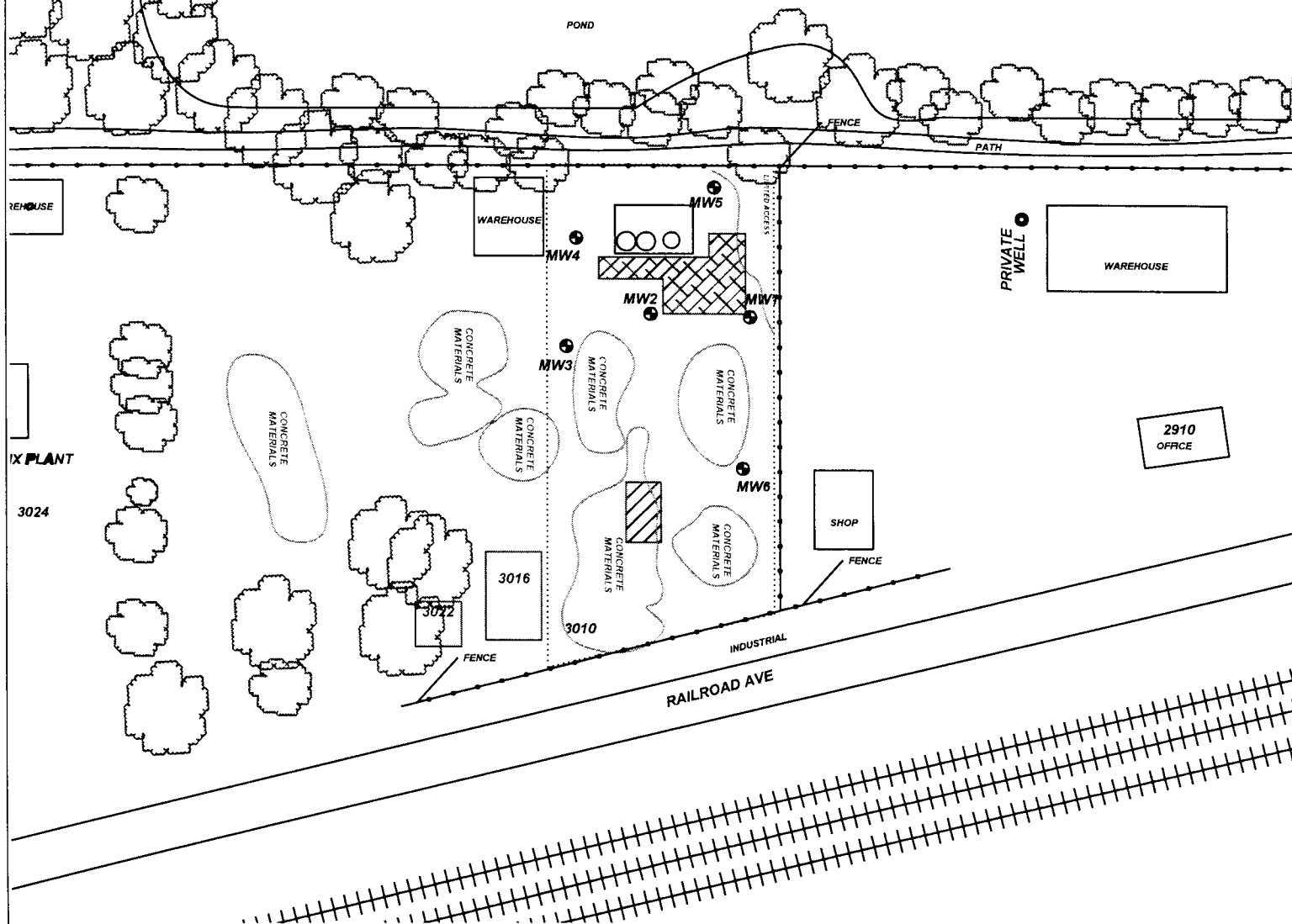

PROJECT: EARL WESTHOFF (FORMER AMES OIL)

ADDRESS: 3010 RAILROAD AVE

LOCATION: GREAT BEND, KS

DRAWN BY: C. ROE DATE: 5/14/18

REVISED BY: C. ROE DATE: 4/1/22

AEI JOB #: TM236 KDHE JOB #: A6-005-40222

SCALE: 1" = 100'

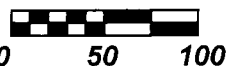

NOTES: *INDICATED BORING FOR UNSATURATED HYDROLOGIC ZONE SAMPLE

TITLE:

FIGURE 2.1 AREA BASE MAP 350' RADIUS



ASSOCIATED
ENVIRONMENTAL
INC.

LEGEND:

- = (3) ON-ROAD/OFF-ROAD DIESEL ASTS
- = FORMER ASTS
- = EXCAVATION EXTENTS
- = PRIVATE WELL
- = MONITORING WELL
- = SUBJECT PROPERTY

