

WATER WELL PLUGGING RECORD Form WWC-5P KSA 82a-1212 ID NO.

MW1

1 LOCATION OF WATER WELL: County: BARTON	Fraction NE ¼ NE ¼ NW ¼ NE ¼	Section Number 32	Township Number T 19 S	Range Number 13 <input type="checkbox"/> E <input checked="" type="checkbox"/> W
---	--	-----------------------------	----------------------------------	--

Street/Rural Address of Well Location; if unknown, distance & direction from nearest town or intersection: If at owner's address, check here <input type="checkbox"/> 3010 RAILROAD AVE GREAT BEND, KS 67530	Global Positioning Systems (GPS) information: Latitude: 38.35433 (in decimal degrees) Longitude: 98.77984 (in decimal degrees) Elevation: 1852.79 Horizontal Datum: <input type="checkbox"/> WGS84, <input checked="" type="checkbox"/> NAD83, <input type="checkbox"/> NAD27 Collection Method: <input type="checkbox"/> GPS unit (Make/Model: _____) <input type="checkbox"/> Digital Map/Photo, <input type="checkbox"/> Topographic Map, <input checked="" type="checkbox"/> Land Survey Est. Accuracy: <input checked="" type="checkbox"/> < 3 m, <input type="checkbox"/> 3-5 m, <input type="checkbox"/> 5-15 m, <input type="checkbox"/> > 15 m
---	---

2 WATER WELL OWNER: KDHE RR#, St. Address, Box #: 1000 SW JACKSON City, State ZIP Code: TOPEKA, KS 66612	
---	--

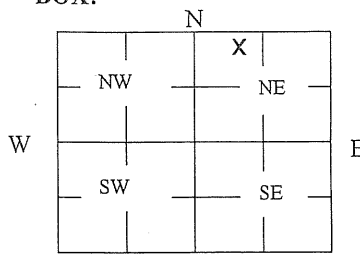
3 MARK WELL'S LOCATION WITH AN "X" IN SECTION BOX: 	4 DEPTH OF WELL <u>13.56</u> ft. WELL'S STATIC WATER LEVEL <u>10.18</u> ft. WELL WAS USED AS: <input type="checkbox"/> Domestic <input type="checkbox"/> Public Water Supply <input type="checkbox"/> Dewatering <input type="checkbox"/> Irrigation <input type="checkbox"/> Oil Field Water Supply <input checked="" type="checkbox"/> Monitoring <input type="checkbox"/> Feedlot <input type="checkbox"/> Domestic (Lawn & Garden) <input type="checkbox"/> Injection Well <input type="checkbox"/> Industrial <input type="checkbox"/> Air Conditioning <input type="checkbox"/> Other _____ Was a chemical/bacteriological sample submitted to Department? Yes <input type="checkbox"/> No <input checked="" type="checkbox"/>
--	--

5 TYPE OF BLANK CASING USED:

Steel RMP (SR) Wrought Fiberglass Other (Specify below) _____
 PVC ABS Asbestos-Cement Concrete Tile _____

Blank casing diameter 2 ^{BDA} in. Was casing pulled? Yes No If yes, how much 3'
 Casing height above or below land surface 36 in.

6 GROUT PLUG MATERIAL: Neat cement Cement grout Bentonite Other GRAVEL 0-0.5

Grout Plug Intervals: From 0.5 ft. to 13.56 ft., From _____ ft. to _____ ft., From _____ ft. to _____ ft.

What is the nearest source of possible contamination:

<input type="checkbox"/> Septic tank	<input type="checkbox"/> Seepage pit	<input checked="" type="checkbox"/> Fuel storage	<input type="checkbox"/> Other (specify below) _____
<input type="checkbox"/> Sewer lines	<input type="checkbox"/> Pit privy	<input type="checkbox"/> Fertilizer storage	
<input type="checkbox"/> Watertight sewer lines	<input type="checkbox"/> Sewage lagoon	<input type="checkbox"/> Insecticide storage	
<input type="checkbox"/> Lateral lines	<input type="checkbox"/> Feedyard	<input type="checkbox"/> Abandoned water well	Direction from well? _____
<input type="checkbox"/> Cess pool	<input type="checkbox"/> Livestock pens	<input type="checkbox"/> Oil well/Gas well	How many feet? _____

FROM	TO	PLUGGING MATERIALS	FROM	TO	PLUGGING MATERIALS
0	0.5	GRAVEL			
0.5	13.56	BENTONITE			

7 CONTRACTOR'S OR LANDOWNER'S CERTIFICATION: This water well was plugged under my jurisdiction and was completed on (mo/day/year) 12/4/23 and this record is true to the best of my knowledge and belief. Kansas Water Well Contractor's License No. 585. This Water Well Record was completed on (mo/day/year) 12/18/23 under the business name of ASSOCIATED ENVIRONMENTAL INC. by (signature) _____

Send one white copy to Kansas Department of Health & Environment, Geology Section, 1000 SW Jackson Street, Ste. 420, Topeka, KS 66612-1367. Send one copy to WATER WELL OWNER and retain one for your records.
 Visit us at <http://www.kdheks.gov/waterwell/index.html> Telephone 785-296-5524.

KSA82a-1212 Revised 1/20/2015

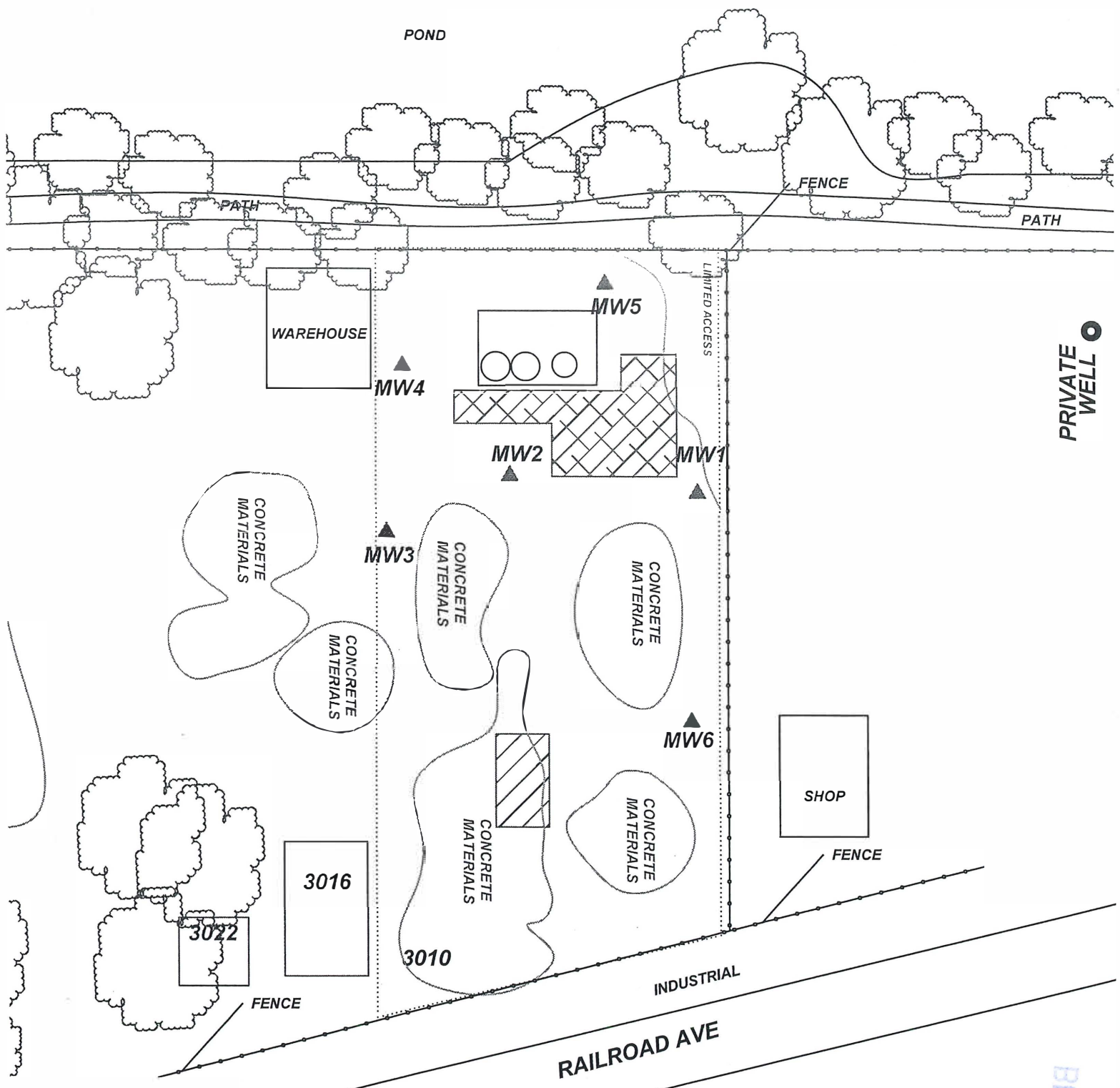

PROJECT: EARL WESTHOFF (FORMER AMES OIL)
 ADDRESS: 3010 RAILROAD AVE
 LOCATION: GREAT BEND, KS
 DRAWN BY: C. ROE DATE: 5/14/18
 REVISED BY: B. STALNAKER DATE: 12/20/23
 AET JOB #: TM236 KDHE JOB #: A6-005-40222

TITLE: FIGURE 2.2
 AREA BASE MAP
 CLOSE-UP
 ASSOCIATED ENVIRONMENTAL INC.

LEGEND:
 [Symbol] = (3) ON-ROAD/OFF-ROAD DIESELASTS
 [Symbol] = FORMER ASTS
 [Symbol] = EXCAVATION EXTENTS
 [Symbol] = PRIVATE WELL
 [Symbol] = MONITORING WELL
 [Symbol] = PLUGGED/DESTROYED WELL
 [Symbol] = SUBJECT PROPERTY
 T.19 R. 13W Sec. 32
 Barton County

SCALE: 1" = 50'

NOTES:

BUREAU OF WATER