

WATER WELL PLUGGING RECORD Form WWC-5P

KSA 82a-1212 ID NO.

MW3

1 LOCATION OF WATER WELL: County: BARTON	Fraction NW ¼ NE ¼ NW ¼ NE ¼	Section Number 32	Township Number T 19 S	Range Number 13 <input type="checkbox"/> E <input checked="" type="checkbox"/> W
--	---------------------------------	----------------------	---------------------------	---

Street/Rural Address of Well Location; if unknown, distance & direction from nearest town or intersection: If at owner's address, check here 3010 RAILROAD AVE GREAT BEND, KS 67530

Global Positioning Systems (GPS) information:
 Latitude: 38.35429 (in decimal degrees)
 Longitude: 98.78024 (in decimal degrees)
 Elevation: 1853.38
 Horizontal Datum: WGS84, NAD83, NAD27
 Collection Method:

2 WATER WELL OWNER: KDHE
 RR#, St. Address, Box #: 1000 SW JACKSON
 City, State ZIP Code: TOPEKA, KS 66612

GPS unit (Make/Model: _____)
 Digital Map/Photo, Topographic Map, Land Survey
 Est. Accuracy: < 3 m, 3-5 m, 5-15 m, > 15 m

3 MARK WELL'S LOCATION WITH AN "X" IN SECTION BOX:

4 DEPTH OF WELL 14.50 ft.
 WELL'S STATIC WATER LEVEL 10.63 ft
 WELL WAS USED AS:

<input type="checkbox"/> Domestic	<input type="checkbox"/> Public Water Supply	<input type="checkbox"/> Dewatering
<input type="checkbox"/> Irrigation	<input type="checkbox"/> Oil Field Water Supply	<input checked="" type="checkbox"/> Monitoring
<input type="checkbox"/> Feedlot	<input type="checkbox"/> Domestic (Lawn & Garden)	<input type="checkbox"/> Injection Well
<input type="checkbox"/> Industrial	<input type="checkbox"/> Air Conditioning	<input type="checkbox"/> Other _____

Was a chemical/bacteriological sample submitted to Department? Yes No

5 TYPE OF BLANK CASING USED:

<input type="checkbox"/> Steel	<input type="checkbox"/> RMP (SR)	<input type="checkbox"/> Wrought	<input type="checkbox"/> Fiberglass	<input type="checkbox"/> Other (Specify below) _____
<input checked="" type="checkbox"/> PVC	<input type="checkbox"/> ABS	<input type="checkbox"/> Asbestos-Cement	<input type="checkbox"/> Concrete Tile	

Blank casing diameter 2 in. Was casing pulled? Yes No If yes, how much 3'
 Casing height above or below land surface 36 in.

6 GROUT PLUG MATERIAL: Neat cement Cement grout Bentonite Other GRAVEL 0-0.5

Grout Plug Intervals: From 0.5 ft. to 14.50 ft., From _____ ft. to _____ ft., From _____ ft. to _____ ft.

What is the nearest source of possible contamination:

<input type="checkbox"/> Septic tank	<input type="checkbox"/> Seepage pit	<input checked="" type="checkbox"/> Fuel storage	<input type="checkbox"/> Other (specify below) _____
<input type="checkbox"/> Sewer lines	<input type="checkbox"/> Pit privy	<input type="checkbox"/> Fertilizer storage	
<input type="checkbox"/> Watertight sewer lines	<input type="checkbox"/> Sewage lagoon	<input type="checkbox"/> Insecticide storage	
<input type="checkbox"/> Lateral lines	<input type="checkbox"/> Feedyard	<input type="checkbox"/> Abandoned water well	Direction from well? _____
<input type="checkbox"/> Cess pool	<input type="checkbox"/> Livestock pens	<input type="checkbox"/> Oil well/Gas well	How many feet? _____

FROM	TO	PLUGGING MATERIALS	FROM	TO	PLUGGING MATERIALS
0	0.5	GRAVEL			
0.5	14.50	BENTONITE			

7 CONTRACTOR'S OR LANDOWNER'S CERTIFICATION: This water well was plugged under my jurisdiction and was completed on (mo/day/year) 12/4/23 and this record is true to the best of my knowledge and belief. Kansas Water Well Contractor's License No. 585. This Water Well Record was completed on (mo/day/year) 12/18/23 under the business name of ASSOCIATED ENVIRONMENTAL INC. by (signature) _____

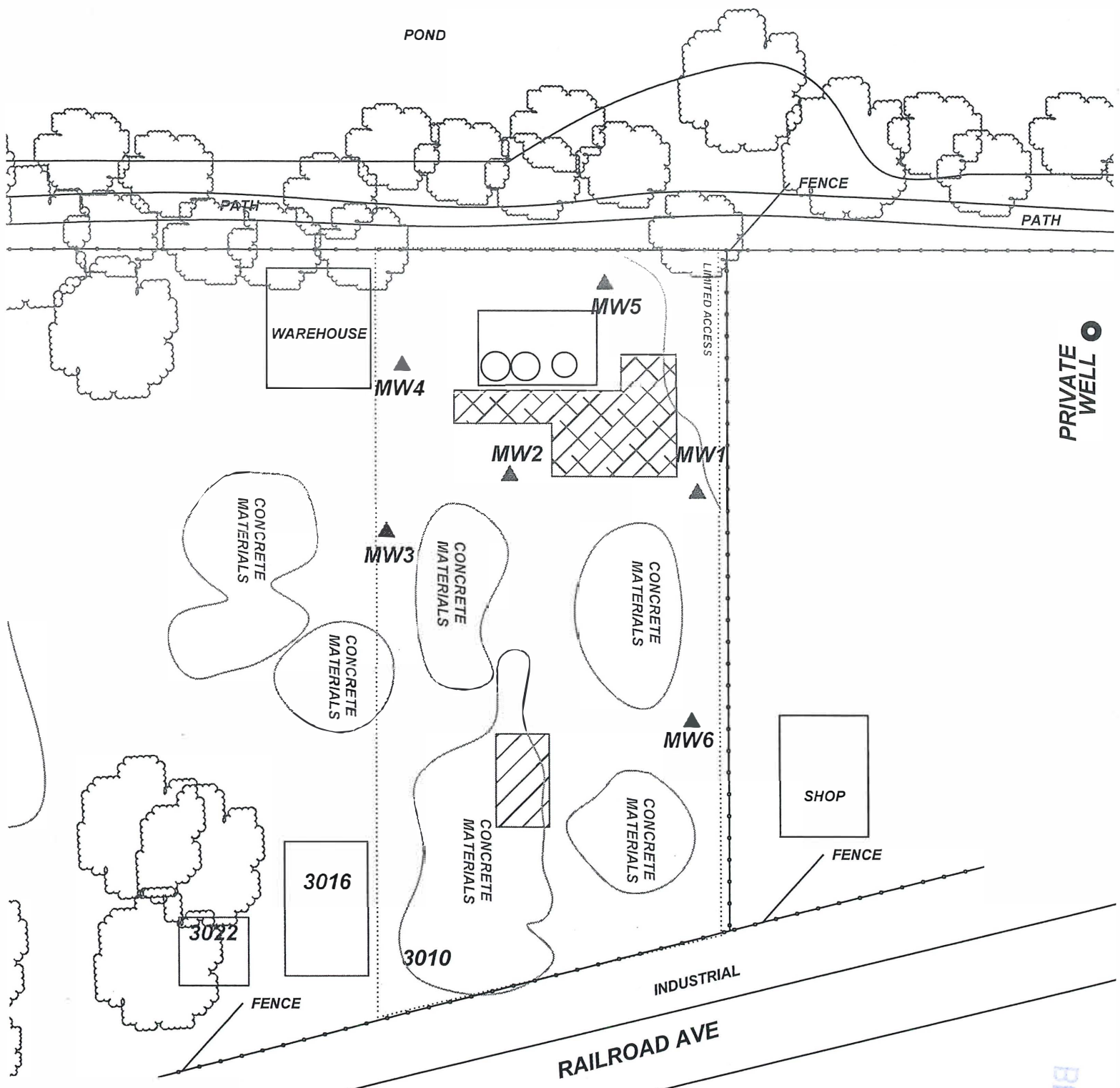

PROJECT: EARL WESTHOFF (FORMER AMES OIL)
 ADDRESS: 3010 RAILROAD AVE
 LOCATION: GREAT BEND, KS
 DRAWN BY: C. ROE DATE: 5/14/18
 REVISED BY: B. STALNAKER DATE: 12/20/23
 AET JOB #: TM236 KDHE JOB #: A6-005-40222

TITLE: **FIGURE 2.2
 AREA BASE MAP
 CLOSE-UP**

**ASSOCIATED
 ENVIRONMENTAL
 INC.**

LEGEND:

- = (3) ON-ROAD/OFF-ROAD DIESELASTS
- = FORMER ASTS
- = EXCAVATION EXTENTS
- = PRIVATE WELL
- = MONITORING WELL
- = PLUGGED/DESTROYED WELL
- = SUBJECT PROPERTY

T.19 R. 13W Sec. 32
 Barton County



NOTES:

BUREAU OF WATER