

WATER WELL PLUGGING RECORD Form WWC-5P

KSA 82a-1212 ID NO.

MW4

1 LOCATION OF WATER WELL: County: BARTON	Fraction NW ¼ NE ¼ NW ¼ NE ¼	Section Number 32	Township Number T 19 S	Range Number 13 <input type="checkbox"/> E <input checked="" type="checkbox"/> W
---	--	-----------------------------	----------------------------------	--

Street/Rural Address of Well Location; if unknown, distance & direction from nearest town or intersection: If at owner's address, check here **3010 RAILROAD AVE
GREAT BEND, KS 67530**

Global Positioning Systems (GPS) information:
 Latitude: **38.35448** (in decimal degrees)
 Longitude: **98.78022** (in decimal degrees)
 Elevation: **1853.22**
 Horizontal Datum: WGS84, NAD83, NAD27
 Collection Method:

2 WATER WELL OWNER: KDHE
 RR#, St. Address, Box #: **1000 SW JACKSON**
 City, State ZIP Code: **TOPEKA, KS 66612**

GPS unit (Make/Model): _____
 Digital Map/Photo, Topographic Map, Land Survey
 Est. Accuracy: < 3 m, 3-5 m, 5-15 m, > 15 m

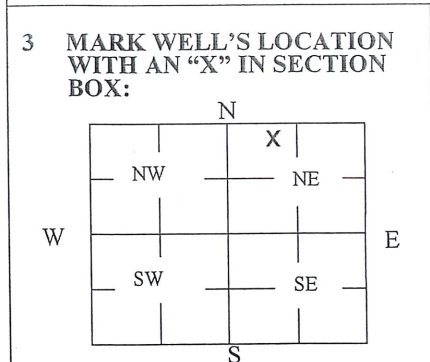

4 DEPTH OF WELL 14.42 ft.
 WELL'S STATIC WATER LEVEL 10.44 ft
 WELL WAS USED AS:
 Domestic Public Water Supply Dewatering
 Irrigation Oil Field Water Supply Monitoring
 Feedlot Domestic (Lawn & Garden) Injection Well
 Industrial Air Conditioning Other _____
 Was a chemical/bacteriological sample submitted to Department? Yes No

5 TYPE OF BLANK CASING USED:

Steel RMP (SR) Wrought Fiberglass Other (Specify below)
 PVC ABS Asbestos-Cement Concrete Tile

Blank casing diameter 2 ^{B&A} in. Was casing pulled? Yes No If yes, how much 3'
 Casing height above or below land surface 36 in.

6 GROUT PLUG MATERIAL: Neat cement Cement grout Bentonite Other GRAVEL 0-0.5

Grout Plug Intervals: From 0.5 ft. to 14.42 ft., From _____ ft. to _____ ft., From _____ ft. to _____ ft.

What is the nearest source of possible contamination:
 Septic tank Seepage pit Fuel storage Other (specify below)
 Sewer lines Pit privy Fertilizer storage
 Watertight sewer lines Sewage lagoon Insecticide storage
 Lateral lines Feedyard Abandoned water well Direction from well? _____
 Cess pool Livestock pens Oil well/Gas well How many feet? _____

FROM	TO	PLUGGING MATERIALS	FROM	TO	PLUGGING MATERIALS
0	0.5	GRAVEL			
0.5	14.42	BENTONITE			

7 CONTRACTOR'S OR LANDOWNER'S CERTIFICATION: This water well was plugged under my jurisdiction and was completed on (mo/day/year) 12/4/23 and this record is true to the best of my knowledge and belief. Kansas Water Well Contractor's License No. 585. This Water Well Record was completed on (mo/day/year) 12/18/23 under the business name of ASSOCIATED ENVIRONMENTAL INC. by (signature) _____

Send one white copy to Kansas Department of Health & Environment, Geology Section, 1000 SW Jackson Street, Ste. 420, Topeka, KS 66612-1367. Send one copy to WATER WELL OWNER and retain one for your records.
 Visit us at <http://www.kdheks.gov/waterwell/index.html> Telephone 785-296-5524.

KSA82a-1212 Revised 1/20/2015

BUREAU OF WATER

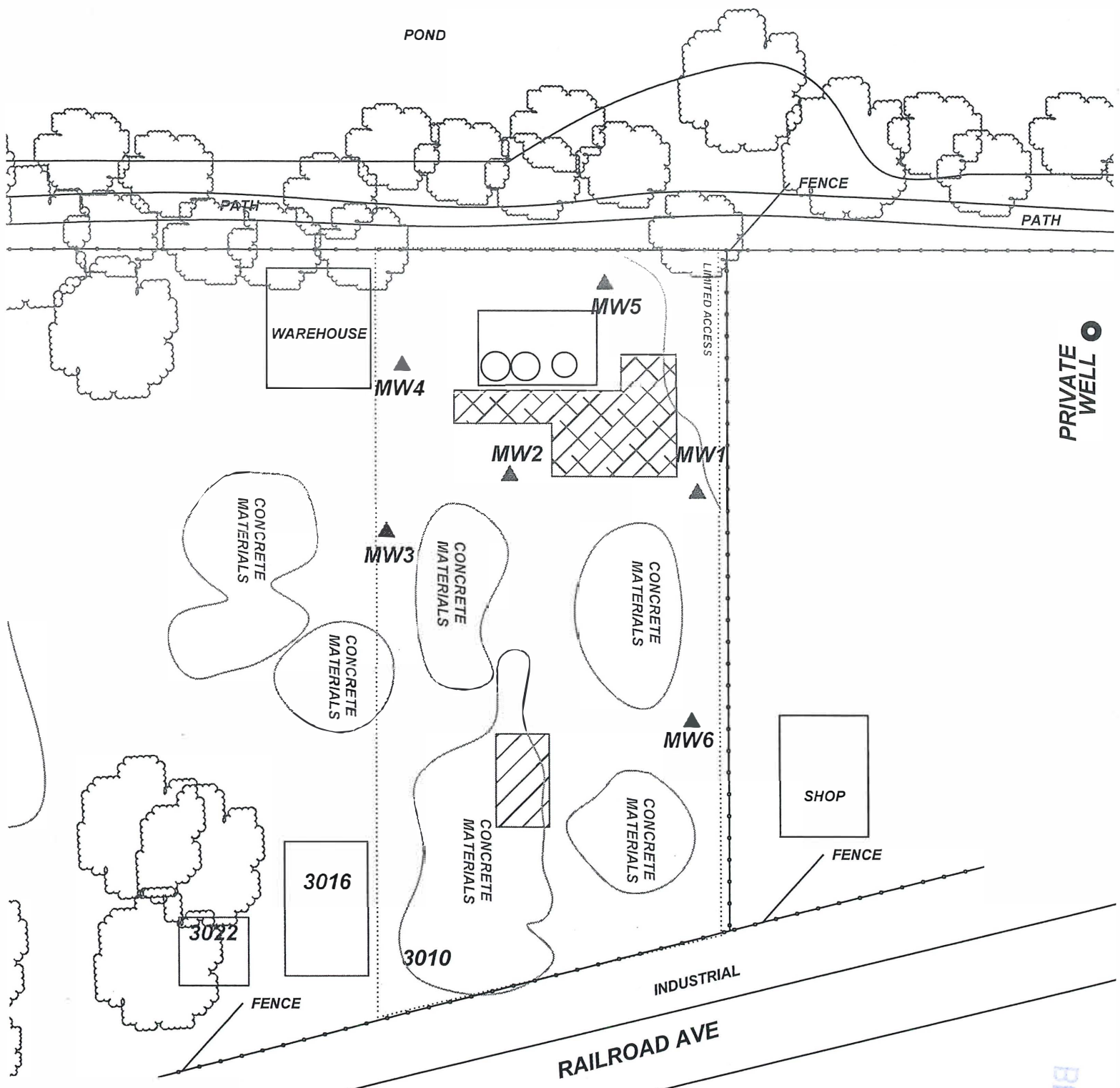

PROJECT: EARL WESTHOFF (FORMER AMES OIL)

ADDRESS: 3010 RAILROAD AVE

LOCATION: GREAT BEND, KS

DRAWN BY: C. ROE **DATE:** 5/14/18

REVISED BY: B. STALNAKER **DATE:** 12/20/23

AEI JOB #: TM236 **KDHE JOB #:** A6-005-40222

TITLE: FIGURE 2.2
AREA BASE MAP
CLOSE-UP

ASSOCIATED ENVIRONMENTAL INC.

LEGEND:

- = (3) ON-ROAD/OFF-ROAD DIESELASTS
- = FORMER ASTS
- = EXCAVATION EXTENTS
- = PRIVATE WELL
- = MONITORING WELL
- = PLUGGED/DESTROYED WELL
- = SUBJECT PROPERTY

T.19 R. 13W Sec. 32
Barton County

SCALE: 1" = 50'

NOTES:

BUREAU OF WATER