

**WATER WELL PLUGGING RECORD Form WWC-5P**

KSA 82a-1212 ID NO.

MW5

<b>1 LOCATION OF WATER WELL:</b> County: BARTON	Fraction NE ¼ NE ¼ NW ¼ NE ¼	Section Number 32	Township Number T 19 S	Range Number 13 <input type="checkbox"/> E <input checked="" type="checkbox"/> W
--	---------------------------------	----------------------	---------------------------	---

Street/Rural Address of Well Location; if unknown, distance & direction from nearest town or intersection: If at owner's address, check here  3010 RAILROAD AVE GREAT BEND, KS 67530

**Global Positioning Systems (GPS) information:**  
 Latitude: 38.35448 (in decimal degrees)  
 Longitude: 98.77989 (in decimal degrees)  
 Elevation: 1853.25  
 Horizontal Datum:  WGS84,  NAD83,  NAD27  
 Collection Method:  
 GPS unit (Make/Model: \_\_\_\_\_)  
 Digital Map/Photo,  Topographic Map,  Land Survey  
 Est. Accuracy:  < 3 m,  3-5 m,  5-15 m,  > 15 m

**2 WATER WELL OWNER: KDHE**  
 RR#, St. Address, Box #: 1000 SW JACKSON  
 City, State ZIP Code: TOPEKA, KS 66612

**3 MARK WELL'S LOCATION WITH AN "X" IN SECTION BOX:**

**4 DEPTH OF WELL** 14.23 ft.  
 WELL'S STATIC WATER LEVEL 10.60 ft  
 WELL WAS USED AS:  
 Domestic  Public Water Supply  Dewatering  
 Irrigation  Oil Field Water Supply  Monitoring  
 Feedlot  Domestic (Lawn & Garden)  Injection Well  
 Industrial  Air Conditioning  Other \_\_\_\_\_  
 Was a chemical/bacteriological sample submitted to Department? Yes  No

**5 TYPE OF BLANK CASING USED:**

Steel  RMP (SR)  Wrought  Fiberglass  Other (Specify below) \_\_\_\_\_  
 PVC  ABS  Asbestos-Cement  Concrete Tile

Blank casing diameter 2<sup>BDA</sup> in. Was casing pulled? Yes  No  If yes, how much 3'  
 Casing height above or below land surface 36 in.

**6 GROUT PLUG MATERIAL:**  Neat cement  Cement grout  Bentonite  Other GRAVEL 0-0.5

Grout Plug Intervals: From 0.5 ft. to 14.23 ft., From \_\_\_\_\_ ft. to \_\_\_\_\_ ft., From \_\_\_\_\_ ft. to \_\_\_\_\_ ft.

What is the nearest source of possible contamination:  
 Septic tank  Seepage pit  Fuel storage  Other (specify below) \_\_\_\_\_  
 Sewer lines  Pit privy  Fertilizer storage \_\_\_\_\_  
 Watertight sewer lines  Sewage lagoon  Insecticide storage \_\_\_\_\_  
 Lateral lines  Feedyard  Abandoned water well Direction from well? \_\_\_\_\_  
 Cess pool  Livestock pens  Oil well/Gas well How many feet? \_\_\_\_\_

FROM	TO	PLUGGING MATERIALS	FROM	TO	PLUGGING MATERIALS
0	0.5	GRAVEL			
0.5	14.23	BENTONITE			

**7 CONTRACTOR'S OR LANDOWNER'S CERTIFICATION:** This water well was plugged under my jurisdiction and was completed on (mo/day/year) 12/4/23 and this record is true to the best of my knowledge and belief. Kansas Water Well Contractor's License No. 585. This Water Well Record was completed on (mo/day/year) 12/18/23 under the business name of ASSOCIATED ENVIRONMENTAL INC. by (signature) \_\_\_\_\_

Send one white copy to Kansas Department of Health & Environment, Geology Section, 1000 SW Jackson Street, Ste. 420, Topeka, KS 66612-1367. Send one copy to WATER WELL OWNER and retain one for your records.  
 Visit us at <http://www.kdheks.gov/waterwell/index.html> Telephone 785-296-5524.

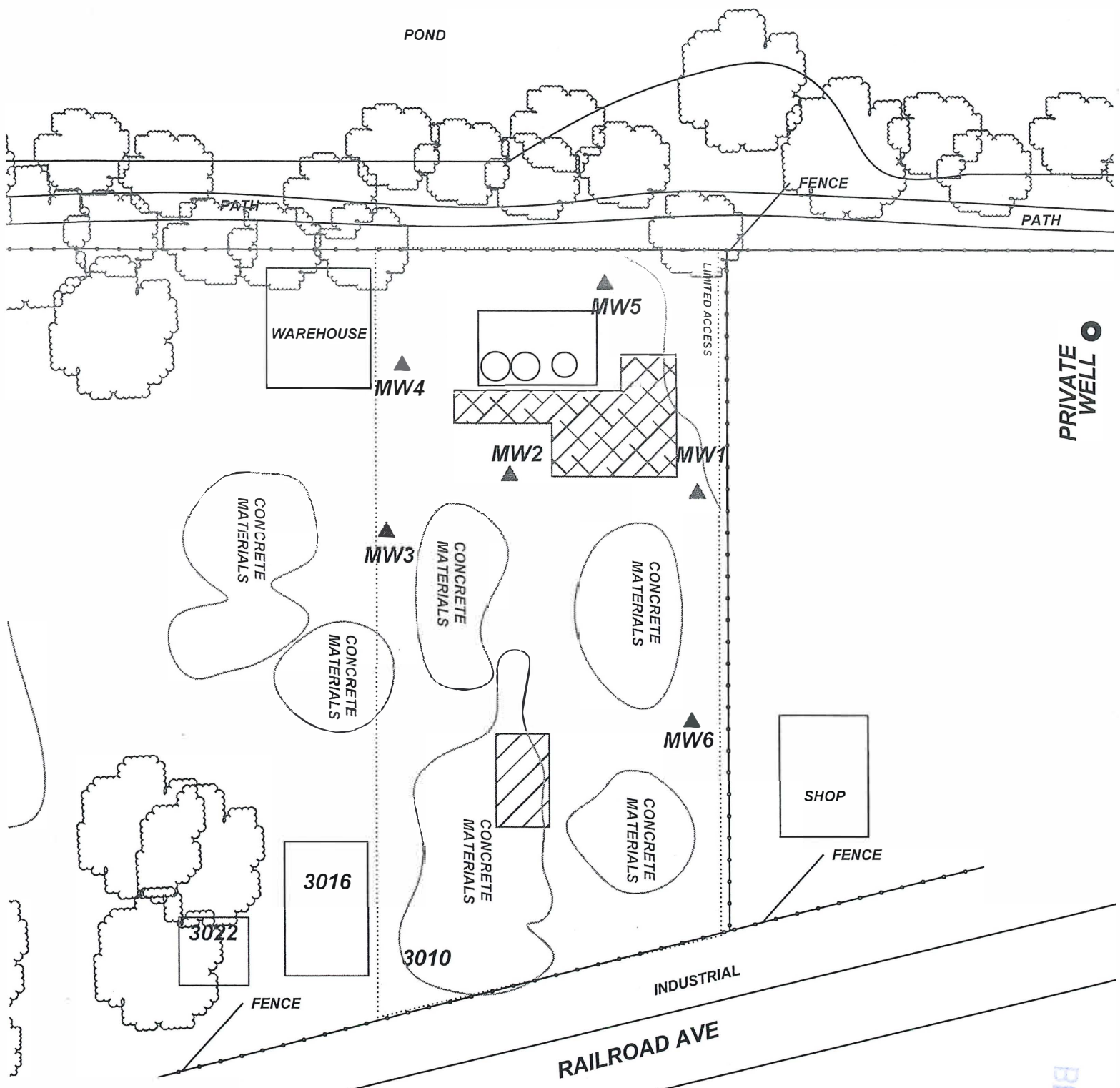

PROJECT: EARL WESTHOFF (FORMER AMES OIL)  
 ADDRESS: 3010 RAILROAD AVE  
 LOCATION: GREAT BEND, KS  
 DRAWN BY: C. ROE DATE: 5/14/18  
 REVISED BY: B. STALNAKER DATE: 12/20/23  
 AET JOB #: TM236 KDHE JOB #: A6-005-40222

TITLE: FIGURE 2.2  
 AREA BASE MAP  
 CLOSE-UP  
 ASSOCIATED ENVIRONMENTAL INC.

LEGEND:  

 = (3) ON-ROAD/OFF-ROAD DIESELASTS  
 = FORMER ASTS  
 = EXCAVATION EXTENTS  
 = PRIVATE WELL  
 = MONITORING WELL  
 = PLUGGED/DESTROYED WELL  
 = SUBJECT PROPERTY  
 T.19 R. 13W Sec. 32  
 Barton County

SCALE: 1" = 50'

NOTES:

BUREAU OF WATER