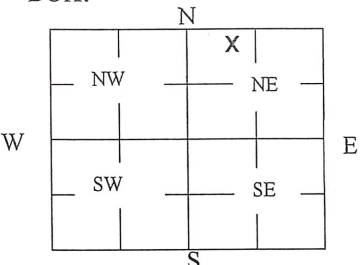

<b>1 LOCATION OF WATER WELL:</b> County: <b>BARTON</b>	Fraction <b>NE 1/4 NE 1/4 NW 1/4 NE 1/4</b>	Section Number <b>32</b>	Township Number <b>T 19 S</b>	Range Number <b>13</b> <input type="checkbox"/> E <input checked="" type="checkbox"/> W
---	--	-----------------------------	----------------------------------	--

Street/Rural Address of Well Location; if unknown, distance & direction from nearest town or intersection: If at owner's address, check here <input type="checkbox"/> <b>3010 RAILROAD AVE GREAT BEND, KS 67530</b>	<b>Global Positioning Systems (GPS) information:</b> Latitude: <b>38.35405</b> (in decimal degrees) Longitude: <b>98.77986</b> (in decimal degrees) Elevation: <b>1853.36</b> Horizontal Datum: <input type="checkbox"/> WGS84, <input checked="" type="checkbox"/> NAD83, <input type="checkbox"/> NAD27 Collection Method: <input type="checkbox"/> GPS unit (Make/Model: _____) <input type="checkbox"/> Digital Map/Photo, <input type="checkbox"/> Topographic Map, <input checked="" type="checkbox"/> Land Survey Est. Accuracy: <input checked="" type="checkbox"/> < 3 m, <input type="checkbox"/> 3-5 m, <input type="checkbox"/> 5-15 m, <input type="checkbox"/> > 15 m
---	---

<b>2 WATER WELL OWNER: KDHE</b> RR#, St. Address, Box #: <b>1000 SW JACKSON</b> City, State ZIP Code: <b>TOPEKA, KS 66612</b>	
---	--

<b>3 MARK WELL'S LOCATION WITH AN "X" IN SECTION BOX:</b> 	<b>4 DEPTH OF WELL</b> <u>14.52</u> ft. WELL'S STATIC WATER LEVEL <u>10.86</u> ft WELL WAS USED AS: <table style="width: 100%;"> <tr> <td><input type="checkbox"/> Domestic</td> <td><input type="checkbox"/> Public Water Supply</td> <td><input type="checkbox"/> Dewatering</td> </tr> <tr> <td><input type="checkbox"/> Irrigation</td> <td><input type="checkbox"/> Oil Field Water Supply</td> <td><input checked="" type="checkbox"/> Monitoring</td> </tr> <tr> <td><input type="checkbox"/> Feedlot</td> <td><input type="checkbox"/> Domestic (Lawn &amp; Garden)</td> <td><input type="checkbox"/> Injection Well</td> </tr> <tr> <td><input type="checkbox"/> Industrial</td> <td><input type="checkbox"/> Air Conditioning</td> <td><input type="checkbox"/> Other _____</td> </tr> </table> Was a chemical/bacteriological sample submitted to Department? Yes <input type="checkbox"/> No <input checked="" type="checkbox"/>	<input type="checkbox"/> Domestic	<input type="checkbox"/> Public Water Supply	<input type="checkbox"/> Dewatering	<input type="checkbox"/> Irrigation	<input type="checkbox"/> Oil Field Water Supply	<input checked="" type="checkbox"/> Monitoring	<input type="checkbox"/> Feedlot	<input type="checkbox"/> Domestic (Lawn & Garden)	<input type="checkbox"/> Injection Well	<input type="checkbox"/> Industrial	<input type="checkbox"/> Air Conditioning	<input type="checkbox"/> Other _____
<input type="checkbox"/> Domestic	<input type="checkbox"/> Public Water Supply	<input type="checkbox"/> Dewatering											
<input type="checkbox"/> Irrigation	<input type="checkbox"/> Oil Field Water Supply	<input checked="" type="checkbox"/> Monitoring											
<input type="checkbox"/> Feedlot	<input type="checkbox"/> Domestic (Lawn & Garden)	<input type="checkbox"/> Injection Well											
<input type="checkbox"/> Industrial	<input type="checkbox"/> Air Conditioning	<input type="checkbox"/> Other _____											

**5 TYPE OF BLANK CASING USED:**

<input checked="" type="checkbox"/> Steel	<input type="checkbox"/> RMP (SR)	<input type="checkbox"/> Wrought	<input type="checkbox"/> Fiberglass	<input type="checkbox"/> Other (Specify below) _____
<input checked="" type="checkbox"/> PVC	<input type="checkbox"/> ABS	<input type="checkbox"/> Asbestos-Cement	<input type="checkbox"/> Concrete Tile	

Blank casing diameter 2 5/8 in. Was casing pulled? Yes  No  If yes, how much 3'  
 Casing height above or below land surface 36 in.

**6 GROUT PLUG MATERIAL:**  Neat cement  Cement grout  Bentonite  Other GRAVEL 0-0.5

Grout Plug Intervals: From 0.5 ft. to 14.52 ft., From \_\_\_\_\_ ft. to \_\_\_\_\_ ft., From \_\_\_\_\_ ft. to \_\_\_\_\_ ft.

What is the nearest source of possible contamination:

<input type="checkbox"/> Septic tank	<input type="checkbox"/> Seepage pit	<input checked="" type="checkbox"/> Fuel storage	<input type="checkbox"/> Other (specify below) _____
<input type="checkbox"/> Sewer lines	<input type="checkbox"/> Pit privy	<input type="checkbox"/> Fertilizer storage	
<input type="checkbox"/> Watertight sewer lines	<input type="checkbox"/> Sewage lagoon	<input type="checkbox"/> Insecticide storage	
<input type="checkbox"/> Lateral lines	<input type="checkbox"/> Feedyard	<input type="checkbox"/> Abandoned water well	Direction from well? _____
<input type="checkbox"/> Cess pool	<input type="checkbox"/> Livestock pens	<input type="checkbox"/> Oil well/Gas well	How many feet? _____

FROM	TO	PLUGGING MATERIALS	FROM	TO	PLUGGING MATERIALS
0	0.5	GRAVEL			
0.5	14.52	BENTONITE			

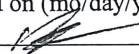
**7 CONTRACTOR'S OR LANDOWNER'S CERTIFICATION:** This water well was plugged under my jurisdiction and was completed on (mo/day/year) 12/4/23 and this record is true to the best of my knowledge and belief. Kansas Water Well Contractor's License No. 585. This Water Well Record was completed on (mo/day/year) 12/18/23 under the business name of ASSOCIATED ENVIRONMENTAL INC. by (signature) 

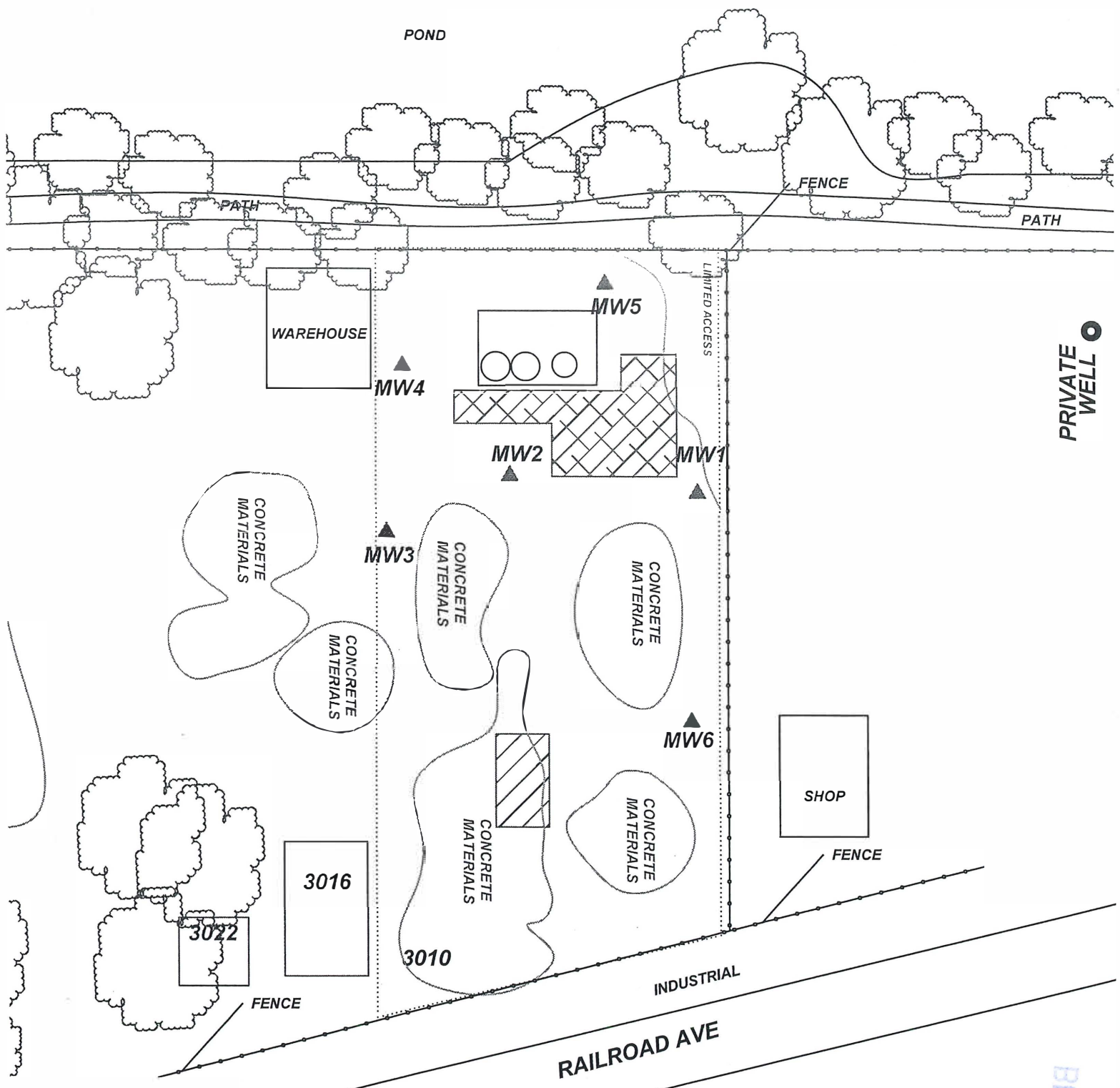

PROJECT: EARL WESTHOFF (FORMER AMES OIL)  
 ADDRESS: 3010 RAILROAD AVE  
 LOCATION: GREAT BEND, KS  
 DRAWN BY: C. ROE DATE: 5/14/18  
 REVISED BY: B. STALNAKER DATE: 12/20/23  
 AET JOB #: TM236 KDHE JOB #: A6-005-40222

TITLE: FIGURE 2.2  
 AREA BASE MAP  
 CLOSE-UP  
 ASSOCIATED ENVIRONMENTAL INC.

LEGEND:  

- (3) ON-ROAD/OFF-ROAD DIESELASTS
- FORMER ASTS
- EXCAVATION EXTENTS
- PRIVATE WELL
- MONITORING WELL
- PLUGGED/DESTROYED WELL
- SUBJECT PROPERTY

T.19 R. 13W Sec. 32  
 Barton County

SCALE: 1" = 50'

NOTES:

BUREAU OF WATER