

WATER WELL RECORD

Form WWC-5

Division of Water Resources App. No.

Well ID

MW1

Original Record Correction Change in Well Ust

1 LOCATION OF WATER WELL: County McPherson Fraction SE 1/4 NE 1/4 SW 1/4 NW 1/4 Section Number 26 Township Number T 19 S Range Number R 3 E W

2 WELL OWNER: Last Name: Higgins Business: Dominion Real Estate, L.L.C. Address: 342 N. Quentin City Wichita State: KS ZIP: 67208 Street or Rural Address where well is located (if unknown, distance and direction from nearest town or intersection): 2201 E Kansas Ave., McPherson, KS 67460

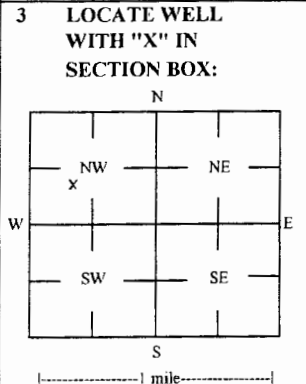

3 LOCATE WELL WITH 'X' IN SECTION BOX: 4 DEPTH OF COMPLETED WELL: 40 ft Depth(s) Groundwater Encountered: 1) 40 ft 2) 29.85 ft 3) 29.85 ft or 4) Dry Well WELL'S STATIC WATER LEVEL: 29.85 ft. X below land surface, measured on (mo-day-yr) 8/11/17

5 Latitude: 38.37155 (decimal degrees) Longitude: 97.62608 (decimal degrees) Horizontal Datum: X WGS 84 Source for Latitude/Longitude: X Land Survey

6 Elevation: 1498.62 ft TOC Source: X Land Survey

7 WELL WATER TO BE USED AS: 1 Domestic: Household, Lawn & Garden, Livestock, Irrigation, Feedlot, Industrial 5 Public Water Supply: well ID 6 Dewatering: how many wells? 7 Aquifer Recharge: well ID 8 X Monitoring: well ID MW1 9 Environmental Remediation: well ID Air Sparge, Soil Vapor Extractor, Recovery, Injection 10 Oil Field Water Supply: lease 11 Test Hole: well ID Cased, Uncased, Geotechnical 12 Geothermal: How many bores? a) Closed Loop Horizontal, Vertical b) Open Loop Surface Discharge, Inj. of Water, Other (specify):

Was a chemical/bacteriological sample submitted to KDHE? No If yes, date sample was submitted: Water well disinfected? No

8 TYPE OF CASING USED: X PVC CASING JOINTS: X Threaded Casing diameter 2 in. to 25 ft, Diameter in. to ft, Diameter in. to ft, Casing height above land surface -0.40 in. Weight lbs./ft. Well thickness or gauge No TYPE OF SCREEN OR PERFORATION MATERIAL: X PVC SCREEN OR PERFORATION OPENINGS ARE: X Mill Slot SCREEN-PERFORATED INTERVALS: From 25 ft. to 40 ft. GRAVEL PACK INTERVALS: From 23 ft. to 40 ft.

9 GROUT MATERIAL: X Bentonite X Other Concrete: 0-1' Grout intervals: From 1 ft. to 23 ft. From ft. to ft. From ft. to ft.

Nearest source of possible contamination: X Fuel Storage

Direction from well? Well within the basin Distance from well? Well within the basin ft

Table with 6 columns: 10 FROM, TO, LITHOLOGIC LOG, FROM, TO, LITHO. LOG (cont.) or PLUGGING INTERVALS. Rows show depth intervals and lithology: Concrete: fill sand, Silty clay with gravel, Sandy silt with clay, Sand with silty sand lenses.

Notes: KDHE ID: Midway Oil Co. (former); U5-059-14886

11 CONTRACTOR'S OR LANDOWNER'S CERTIFICATION: This water well was X constructed, reconstructed, or plugged under my jurisdiction and was completed on (mo-day-year) 8/9/17 and this record is true to the best of my knowledge and belief. Kansas Water Well Contractor's License No 757 This Water Well Record was completed on (mo-day-year) 10/5/17 under the business name of Larsen & Associates, Inc. Signature

Mail 1 white copy along with a fee of \$5.00 for each constructed well to: Kansas Department of Health and Environment, Bureau of Water, 1000 SW Jackson St., Suite 420, Topeka, Kansas 66612-1367. Mail one to Water Well Owner and retain one for your records. Telephone 785-296-5524.

# DENNIS L HANDKE

1820 NW 59th Terrace  
TOPEKA, KANSAS 66618  
785-286-4047 Home  
785-286-1990 Fax

Jessica Chapman  
Larsen & Associates  
1311 E. 25<sup>th</sup> Street, Suite B  
Lawrence, Kansas, 66046

September 25, 2017  
Revised October 6, 2017

RE: Monitor Well Elevation Survey  
2201 E. Kansas Ave., McPherson, Kansas

Proj. 17-00DD  
Midway Oil Co. (formerly)  
U5-059-14886

Bench Mark: Chisled Sq. on sidewalk at the SE corner of the building.

Elev: 1499.32      North 3457      West 4163      (from SE Cor. Sec. 26-19-3W)

MW-1	rim	1499.02	North	3383	SE1/4,NE1/4,SW1/4,NW1/4
	top pipe	1498.62	West	4169	Lat= 38.37155 Long = 97.62608
MW-2	rim	1499.27	North	3379	SE1/4,NE1/4,SW1/4,NW1/4
	top pipe	1499.04	West	4119	Lat= 38.37154 Long = 97.62591
MW-3	rim	1498.20	North	3392	SE1/4,NE1/4,SW1/4,NW1/4
	top pipe	1497.96	West	4237	Lat= 38.37157 Long = 97.62632
MW-4	rim	1497.36	North	3553	SE1/4,NE1/4,SW1/4,NW1/4
	top pipe	1497.03	West	4124	Lat= 38.37202 Long = 97.62593
MW-5	rim	1499.84	North	3299	NE1/4,SE1/4,SW1/4,NW1/4
	top pipe	1499.45	West	4169	Lat= 38.37132 Long = 97.62608
MW-6	rim	1500.16	North	3427	SE1/4,NE1/4,SW1/4,NW1/4
	top pipe	1499.62	West	4091	Lat= 38.37167 Long = 97.62581
MW-7	rim	1498.33	North	3297	NE1/4,NE1/4,SW1/4,NW1/4
	top pipe	1498.00	West	4280	Lat= 38.37131 Long = 97.62647
MW-8	rim	1497.12	North	3436	SW1/4,NE1/4,SW1/4,NW1/4
	top pipe	1496.81	West	4294	Lat= 38.37169 Long = 97.62652
MW-9	rim	1499.43	North	3236	NE1/4,SE1/4,SW1/4,NW1/4
	top pipe	1499.08	West	4239	Lat= 38.37114 Long = 97.62633

Lat & Long derived existing McPherson South 7.5' quad map. WGS 84.

Elevation established from City of McPherson BM#12, Proj CIP-0014, NAD 83.

If you have any questions, please feel free to call me. Thank you for the opportunity to be of service to you.

October 6, 2017  
Dennis L Handke RLS

*Dennis L Handke*

RECEIVED  
OCT 16 2017  
BUREAU OF WATER

NOTE: Figures exhibited within this report are only to be used within the context of this report. Placement of property lines, wells, structures, and roads is based on the available information from county appraiser maps, surveys, site visits, and/or previous vendor reports and should be considered approximate.

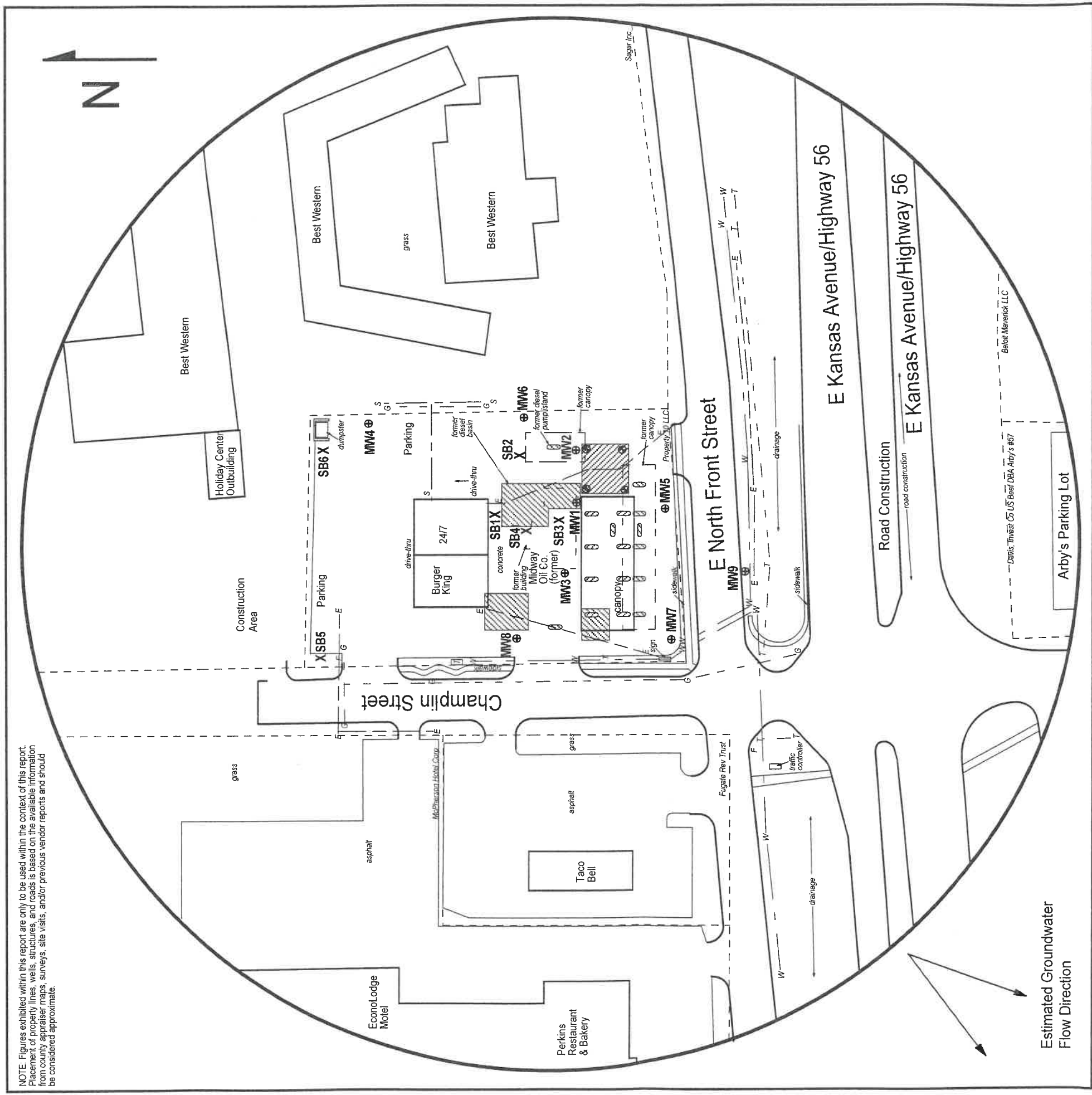

**FIGURE 2.2 - 500 FT RADIUS AREA BASE MAP**



1311 E 25th St., Suite B  
Lawrence, KS 66046

(785) 841-8707 office  
(785) 865-4282 fax

**PROJECT:**

Midway Oil Co. (former)  
2201 East Kansas Ave.  
McPherson, KS  
KDHE ID: U5-059-14886  
Date: 8/11/17



**LEGEND:**

- Approximate Location of Former UST Basin, Product Line and Pump Islands
- Approximate Location of Active UST Basin and Pump Islands
- Approximate Location of Property Line
- Observation Well
- Monitoring Well (Installed 8/7-10/17)
- Soil Boring (Drilled 8/9-11/17)
- Fire Hydrant
- Gas Lines (2 - 6 ft BGS)
- Electric Lines (2 - 6 ft BGS)
- Overhead Lines (25-40 ft high)
- Telephone Lines (2 - 6 ft BGS)
- Water Lines (2 - 6 ft BGS)

NOTE: Location of former and active product lines is unknown.  
NOTE: Utility depths, heights and locations are approximate.

RECEIVED

OCT 16 2017

BUREAU OF WATER