

WATER WELL RECORD

Form WWC-5

Division of Water Resources App. No.

[]

Well ID

MW9

[X] Original Record [] Correction [] Change in Well Ust

1 LOCATION OF WATER WELL: County McPherson Fraction NE 1/4 SE 1/4 SW 1/4 NW 1/4 Section Number 26 Township Number T 19 S Range Number R 3 E [X] W

2 WELL OWNER: Last Name: Higgins First: Patrick Street or Rural Address where well is located (if unknown, distance and direction from nearest town or intersection): If at owner's address, check here: [] -60 ft south of 2201 E Kansas Ave., McPherson, KS 67460

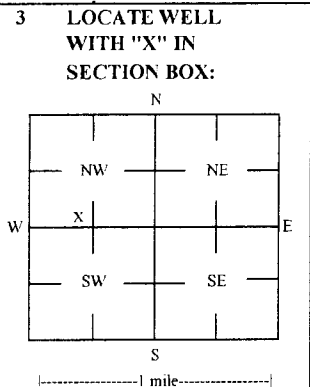

3 LOCATE WELL WITH 'X' IN SECTION BOX: 4 DEPTH OF COMPLETED WELL: 44 ft Depth(s) Groundwater Encountered: 1) _____ ft 2) _____ ft 3) _____ ft, or 4) [] Dry Well WELLS STATIC WATER LEVEL: 36.00 ft. [X] below land surface, measured on (mo-day-yr) 8/11/17 [] above land surface, measured on (mo-day-yr) _____ Pump test data: Well water was _____ ft after _____ hours pumping _____ gpm Water well was _____ ft after _____ hours pumping _____ gpm Estimated Yield: _____ gpm Bore Hole Diameter: 7.25 in to _____ ft, and _____ in to _____ ft

5 Latitude: 38.37114 (decimal degrees) Longitude: 97.62633 (decimal degrees) Horizontal Datum [X] WGS 84 [] NAD 83 [] NAD 27 Source for Latitude/Longitude: [] GPS (unit make/model: _____) (WAAS enabled? [] Yes [] No) [X] Land Survey [] Topographic Map [] Online Mapper

6 Elevation 1499.08 ft [] Ground Level [X] TOC Source [X] Land Survey [] GPS [] Topographic Map [] Other _____

7 WELL WATER TO BE USED AS: 1 Domestic: [] Household [] Lawn & Garden [] Livestock 2 [] Irrigation 3 [] Feedlot 4 [] Industrial 5 [] Public Water Supply: well ID _____ 6 [] Dewatering: how many wells? _____ 7 [] Aquifer Recharge: well ID _____ 8 [X] Monitoring: well ID MW9 9 Environmental Remediation: well ID _____ [] Air Sparge [] Soil Vapor Extractor [] Recovery [] Injection 10 [] Oil Field Water Supply: lease _____ 11 Test Hole: well ID _____ [] Cased [] Uncased [] Geotechnical 12 Geothermal: How many bores? _____ a) Closed Loop [] Horizontal [] Vertical b) Open Loop [] Surface Discharge [] Inj. of Water [] Other (specify): _____

Was a chemical/bacteriological sample submitted to KDHE? [] Yes [X] No If yes, date sample was submitted: _____ Water well disinfected? [] Yes [X] No

8 TYPE OF CASING USED: [] Steel [X] PVC [] Other _____ CASING JOINTS: [] Glued [] Clamped [] Welded [X] Threaded Casing diameter 2 in. to 29 ft, Diameter _____ in. to _____ ft, Diameter _____ in. to _____ ft, Casing height above land surface -0.35 in. Weight _____ lbs./ft. Well thickness or gauge No _____ TYPE OF SCREEN OR PERFORATION MATERIAL: [] Steel [] Stainless Steel [] Fiberglass [X] PVC [] Other (Specify) _____ [] Brass [] Galvanized Steel [] Concrete tile [] None used (open hole) SCREEN OR PERFORATION OPENINGS ARE: [] Continuous Slot [X] Mill Slot [] Gauze Wrapped [] Torch Cut [] Drilled Holes [] Other (Specify) _____ [] Louvered Shutter [] Key Punched [] Wire Wrapped [] Saw Cut [] None (Open Hole) SCREEN-PERFORATED INTERVALS: From 29 ft. to 44 ft. From _____ ft. to _____ ft. From _____ ft. to _____ ft. GRAVEL PACK INTERVALS: From 27 ft. to 44 ft. From _____ ft. to _____ ft. From _____ ft. to _____ ft.

9 GROUT MATERIAL: [] Neat cement [] Cement grout [X] Bentonite [X] Other Concrete: 0-1' Grout intervals: From 1 ft. to 27 ft. From _____ ft. to _____ ft. From _____ ft. to _____ ft.

Nearest source of possible contamination: [] Septic Tank [] Lateral Lines [] Pit Privy [] Livestock Pens [] Insecticide Storage [] Sewer Lines [] Cess Pool [] Sewage Lagoon [X] Fuel Storage [] Abandoned Water Well [] Watertight Sewer Lines [] Seepage Pit [] Feedyard [] Fertilizer Storage [] Oil Well / Gas Well [] Other (Specify) _____ Direction from well? North Distance from well? ~95 ft

Table with columns: FROM, TO, LITHOLOGIC LOG, FROM, TO, LITHO. LOG (cont.) or PLUGGING INTERVALS. Rows: 0-26 Topsoil: Silty clay; 26-30 Sandy clay; 30-44 Clayey sand with gravel.

Notes: KDHE ID: Midway Oil Co. (former); U5-059-14886

11 CONTRACTOR'S OR LANDOWNER'S CERTIFICATION: This water well was [X] constructed, [] reconstructed, or [] plugged under my jurisdiction and was completed on (mo-day-year) 8/10/17 and this record is true to the best of my knowledge and belief. Kansas Water Well Contractor's License No 757 This Water Well Record was completed on (mo-day-year) 10/5/17 under the business name of Larsen & Associates, Inc. Signature _____

Mail 1 white copy along with a fee of \$5.00 for each constructed well to: Kansas Department of Health and Environment, Bureau of Water, G-225 Section, 1000 SW Jackson St., Suite 420, Topeka, Kansas 66612-1367. Mail one to Water Well Owner and retain one for your records. Telephone 785-296-5524.

DENNIS L HANDKE

1820 NW 59th Terrace
TOPEKA, KANSAS 66618
785-286-4047 Home
785-286-1990 Fax

Jessica Chapman
Larsen & Associates
1311 E. 25th Street, Suite B
Lawrence, Kansas, 66046

September 25, 2017
Revised October 6, 2017

RE: Monitor Well Elevation Survey
2201 E. Kansas Ave., McPherson, Kansas

Proj. 17-00DD
Midway Oil Co. (formerly)
U5-059-14886

Bench Mark: Chisled Sq. on sidewalk at the SE corner of the building.

Elev: 1499.32 North 3457 West 4163 (from SE Cor. Sec. 26-19-3W)

MW-1	rim	1499.02	North	3383	SE1/4,NE1/4,SW1/4,NW1/4
	top pipe	1498.62	West	4169	Lat= 38.37155 Long = 97.62608
MW-2	rim	1499.27	North	3379	SE1/4,NE1/4,SW1/4,NW1/4
	top pipe	1499.04	West	4119	Lat= 38.37154 Long = 97.62591
MW-3	rim	1498.20	North	3392	SE1/4,NE1/4,SW1/4,NW1/4
	top pipe	1497.96	West	4237	Lat= 38.37157 Long = 97.62632
MW-4	rim	1497.36	North	3553	SE1/4,NE1/4,SW1/4,NW1/4
	top pipe	1497.03	West	4124	Lat= 38.37202 Long = 97.62593
MW-5	rim	1499.84	North	3299	NE1/4,SE1/4,SW1/4,NW1/4
	top pipe	1499.45	West	4169	Lat= 38.37132 Long = 97.62608
MW-6	rim	1500.16	North	3427	SE1/4,NE1/4,SW1/4,NW1/4
	top pipe	1499.62	West	4091	Lat= 38.37167 Long = 97.62581
MW-7	rim	1498.33	North	3297	NE1/4,NE1/4,SW1/4,NW1/4
	top pipe	1498.00	West	4280	Lat= 38.37131 Long = 97.62647
MW-8	rim	1497.12	North	3436	SW1/4,NE1/4,SW1/4,NW1/4
	top pipe	1496.81	West	4294	Lat= 38.37169 Long = 97.62652
MW-9	rim	1499.43	North	3236	NE1/4,SE1/4,SW1/4,NW1/4
	top pipe	1499.08	West	4239	Lat= 38.37114 Long = 97.62633

Lat & Long derived existing McPherson South 7.5' quad map. WGS 84.

Elevation established from City of McPherson BM#12, Proj CIP-0014, NAD 83.

If you have any questions, please feel free to call me. Thank you for the opportunity to be of service to you.

October 6, 2017
Dennis L Handke RLS

Dennis L Handke

RECEIVED
OCT 16 2017
BUREAU OF WATER

NOTE: Figures exhibited within this report are only to be used within the context of this report. Placement of property lines, wells, structures, and roads is based on the available information from county appraiser maps, surveys, site visits, and/or previous vendor reports and should be considered approximate.

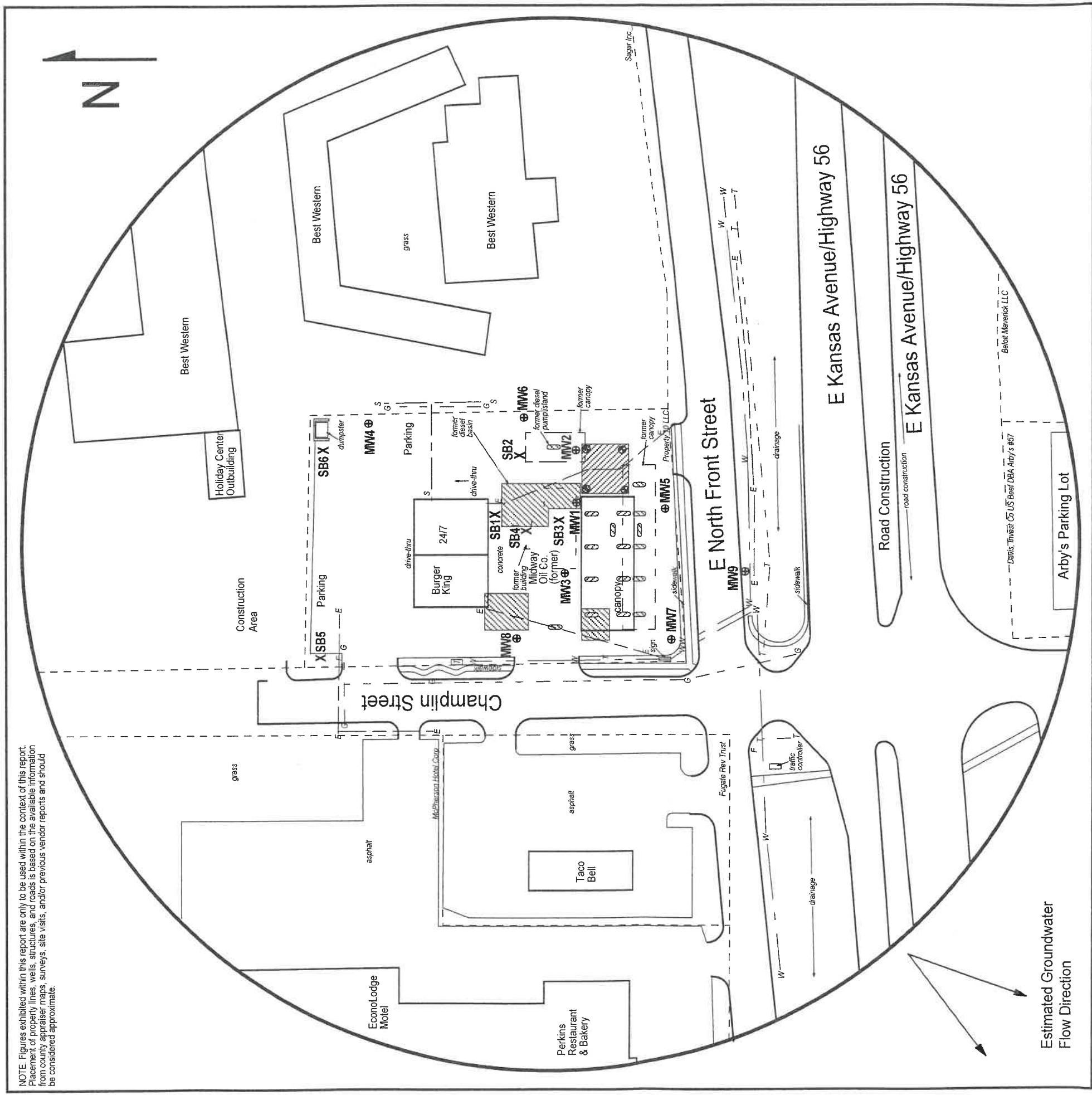

FIGURE 2.2 - 500 FT RADIUS AREA BASE MAP



1311 E 25th St., Suite B
Lawrence, KS 66046

(785) 841-8707 office
(785) 865-4282 fax

PROJECT:

Midway Oil Co. (former)
2201 East Kansas Ave.
McPherson, KS
KDHE ID: U5-059-14886
Date: 8/11/17



LEGEND:

- Approximate Location of Former UST Basin, Product Line and Pump Islands
- Approximate Location of Active UST Basin and Pump Islands
- Approximate Location of Property Line
- Observing Well
- Monitoring Well (Installed 8/7-10/17)
- Soil Boring (Drilled 8/9-11/17)
- Fire Hydrant
- Gas Lines (2 - 6 ft BGS)
- Electric Lines (2 - 6 ft BGS)
- Overhead Lines (25-40 ft high)
- Telephone Lines (2 - 6 ft BGS)
- Water Lines (2 - 6 ft BGS)

NOTE: Location of former and active product lines is unknown.
NOTE: Utility depths, heights and locations are approximate.

RECEIVED

OCT 16 2017

BUREAU OF WATER