

1 LOCATION OF WATER WELL: County: Rice	Fraction SE ¼ NE ¼ SE ¼	Section Number 33	Township Number 19S	Range Number 8W
---	-----------------------------------	-----------------------------	-------------------------------	---------------------------

Distance and direction from nearest town or city street address of well if located within city?

321 N. Grand, Lyons KS

2 WATER WELL OWNER: Farmers Coop. Union RR#, St. Address, Box #: 321 N. Grant City, State, ZIP Code: Lyon, KS	Global Positioning System (decimal degrees, min. of 4 digits) Latitude: <u>NA</u> Longitude: <u>NA</u> Elevation: <u>NA</u> Datum: <u>NA</u> Data Collection Method: <u>NA</u>
---	--

3 MARK WELL'S LOCATON WITH AN "X" IN SECTION BOX:

4 DEPTH OF WELL 38.90 ft. MW1

WELL'S STATIC WATER LEVEL NA ft.

WELL WAS USED AS:

1 Domestic	5 Public Water Supply	9 Dewatering
2 Irrigation	6 Oil Field Water Supply	<input checked="" type="radio"/> 10 Monitoring
3 Feedlot	7 Domestic (Lawn & Garden)	11 Injection Well
4 Industrial	8 Air Conditioning	12 Other _____

Was a chemical/bacteriological sample submitted to Department? Yes ___ No X

5 TYPE OF BLANK CASING USED:

1 Steel	3 RMP (SR)	5 Wrought	7 Fiberglass	9 Other (specify below)
<input checked="" type="radio"/> 2 PVC	4 ABS	6 Asbestos-Cement	8 Concrete Tile	_____

Blank casing diameter 2 in. Was casing pulled? Yes X No ___ If yes, how much 3'

Casing height above or below land surface NA in.

6 GROUT PLUG MATERIAL: 1 Neat cement 2 Cement grout 3 Bentonite 4 Other Gravel; 0-0.2'; Soil: 0.2-3'

Grout Plug Intervals: From 3 ft. to 38.9 ft., From _____ ft. to _____ ft., From _____ ft. to _____ ft.

What is the nearest source of possible contamination:

- | | | | |
|--------------------------|-------------------|-------------------------|--------------------------|
| 1 Septic tank | 6 Seepage pit | 11 Fuel storage | 16 Other (specify below) |
| 2 Sewer lines | 7 Pit privy | 12 Fertilizer storage | _____ |
| 3 Watertight sewer lines | 8 Sewage lagoon | 13 Insecticide storage | _____ |
| 4 Lateral lines | 9 Feedyard | 14 Abandoned water well | Direction from well? |
| 5 Cess pool | 10 Livestock pens | 15 Oil well/Gas well | How many feet? |

FROM	TO	PLUGGING MATERIALS	FROM	TO	PLUGGING MATERIALS
0	0.2	Gravel			
0.2	3	Soil			
3	38.90	Bentonite			

7 CONTRACTOR'S OR LANDOWNER'S CERTIFICATION: This water well was plugged under my jurisdiction and was completed on (mo/day/year) 4/16/14 and this record is true to the best of my knowledge and belief. Kansas Water Well Contractor's License No. 757. This Water Well Record was completed on (mo/day/year) 5/5/14 under the business name of Larsen and Associates, Inc. by (signature)

INSTRUCTIONS: Please fill in blanks or circle the correct answers. Send top three copies to Kansas Department of Health and Environment, Bureau of Water, Geology Section, 1000 SW Jackson St., Ste. 420, Topeka, Kansas 66612-1367. Telephone: 785/296-5522. Send one to Water Well Owner and retain one for your records. Visit us at <http://www.kdheks.gov/waterwell>.

Farmers Coop Union-Lyons

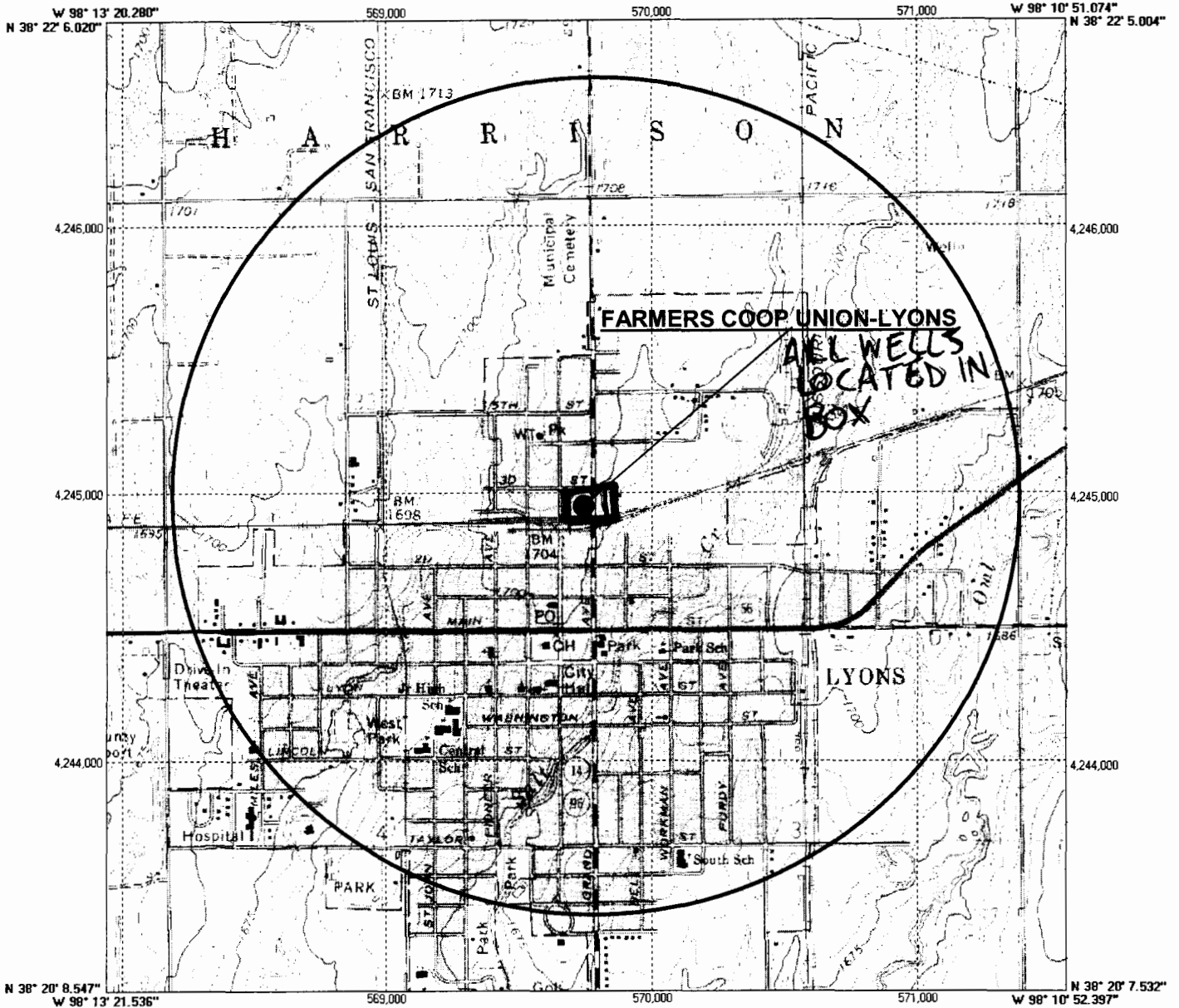

FARMERS COOP UNION-LYONS
ALL WELLS
LOCATED IN
BOX



Farmers Coop Union-Lyons

1927 North American Datum; 1,000-meter UTM grid zone 14
 Generated by BigTopo (www.bigtopo.com)
 Map compiled from USGS Quads: Lyons; KS

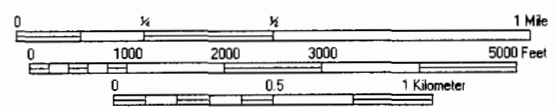

Figure 1: General Site Location
Site Name: Farmers Coop Union-Lyons
Address: 321 N Grand
Lyons, KS
KDHE ID: U5-080-00416

Source: Lyons, KS Quadrangle



RECEIVED
MAY 21 2014
BUREAU OF WATER
S33, T19S, R8W
SE SE NE SE



1311 E 25th St., Suite B, Lawrence, KS 66046 | 785-841-8707 | office
 info@larsenenvironmental.com | 785-865-4282 | fax