

<b>1 LOCATION OF WATER WELL:</b> County: <u>Rice</u>	Fraction <u>SE ¼ NE ¼ SE ¼</u>	Section Number <u>33</u>	Township Number <u>19S</u>	Range Number <u>8W</u>
---	-----------------------------------	-----------------------------	-------------------------------	---------------------------

Distance and direction from nearest town or city street address of well if located within city?

321 N. Grand, Lyons KS

<b>2 WATER WELL OWNER:</b> <u>Farmers Coop. Union</u>  RR#, St. Address, Box #: <u>321 N. Grant</u>  City, State, ZIP Code: <u>Lyon, KS</u>	<b>Global Positioning System</b> (decimal degrees, min. of 4 digits) Latitude: <u>NA</u> Longitude: <u>NA</u> Elevation: <u>NA</u> Datum: <u>NA</u> Data Collection Method: <u>NA</u>
---	--

**3 MARK WELL'S LOCATON WITH AN "X" IN SECTION BOX:**

**4 DEPTH OF WELL** 39.20 ft. MW3

WELL'S STATIC WATER LEVEL NA ft.

WELL WAS USED AS:

1 Domestic	5 Public Water Supply	9 Dewatering
2 Irrigation	6 Oil Field Water Supply	10 Monitoring
3 Feedlot	7 Domestic (Lawn & Garden)	11 Injection Well
4 Industrial	8 Air Conditioning	12 Other _____

Was a chemical/bacteriological sample submitted to Department? Yes \_\_\_ No X

**5 TYPE OF BLANK CASING USED:**

1 Steel	3 RMP (SR)	5 Wrought	7 Fiberglass	9 Other (specify below)
2 PVC	4 ABS	6 Asbestos-Cement	8 Concrete Tile	_____

Blank casing diameter 2 in. Was casing pulled? Yes X No \_\_\_ If yes, how much 3'  
Casing height above or below land surface NA in.

**6 GROUT PLUG MATERIAL:** 1 Neat cement 2 Cement grout 3 Bentonite 4 Other Concrete; 0-0.5'; Soil: 0.5-3'

Grout Plug Intervals: From 3 ft. to 39.20 ft., From \_\_\_\_\_ ft. to \_\_\_\_\_ ft., From \_\_\_\_\_ ft. to \_\_\_\_\_ ft.

What is the nearest source of possible contamination:

- |                          |                   |                         |                          |
|--------------------------|-------------------|-------------------------|--------------------------|
| 1 Septic tank            | 6 Seepage pit     | 11 Fuel storage         | 16 Other (specify below) |
| 2 Sewer lines            | 7 Pit privy       | 12 Fertilizer storage   | _____                    |
| 3 Watertight sewer lines | 8 Sewage lagoon   | 13 Insecticide storage  | _____                    |
| 4 Lateral lines          | 9 Feedyard        | 14 Abandoned water well | Direction from well?     |
| 5 Cess pool              | 10 Livestock pens | 15 Oil well/Gas well    | How many feet?           |

FROM	TO	PLUGGING MATERIALS	FROM	TO	PLUGGING MATERIALS
0	0.5	Concrete			
0.5	3	Soil			
3	39.20	Bentonite			

**7 CONTRACTOR'S OR LANDOWNER'S CERTIFICATION:** This water well was plugged under my jurisdiction and was completed on (mo/day/year) 4/16/14 and this record is true to the best of my knowledge and belief. Kansas Water Well Contractor's License No. 757. This Water Well Record was completed on (mo/day/year) 5/5/14 under the business name of Larsen and Associates, Inc. by (signature)

**INSTRUCTIONS:** Please fill in blanks or circle the correct answers. Send top three copies to Kansas Department of Health and Environment, Bureau of Water, Geology Section, 1000 SW Jackson St., Ste. 420, Topeka, Kansas 66612-1367. Telephone: 785/296-5522. Send one to Water Well Owner and retain one for your records. Visit us at <http://www.kdhehs.gov/waterwell>.

Farmers Coop Union-Lyons

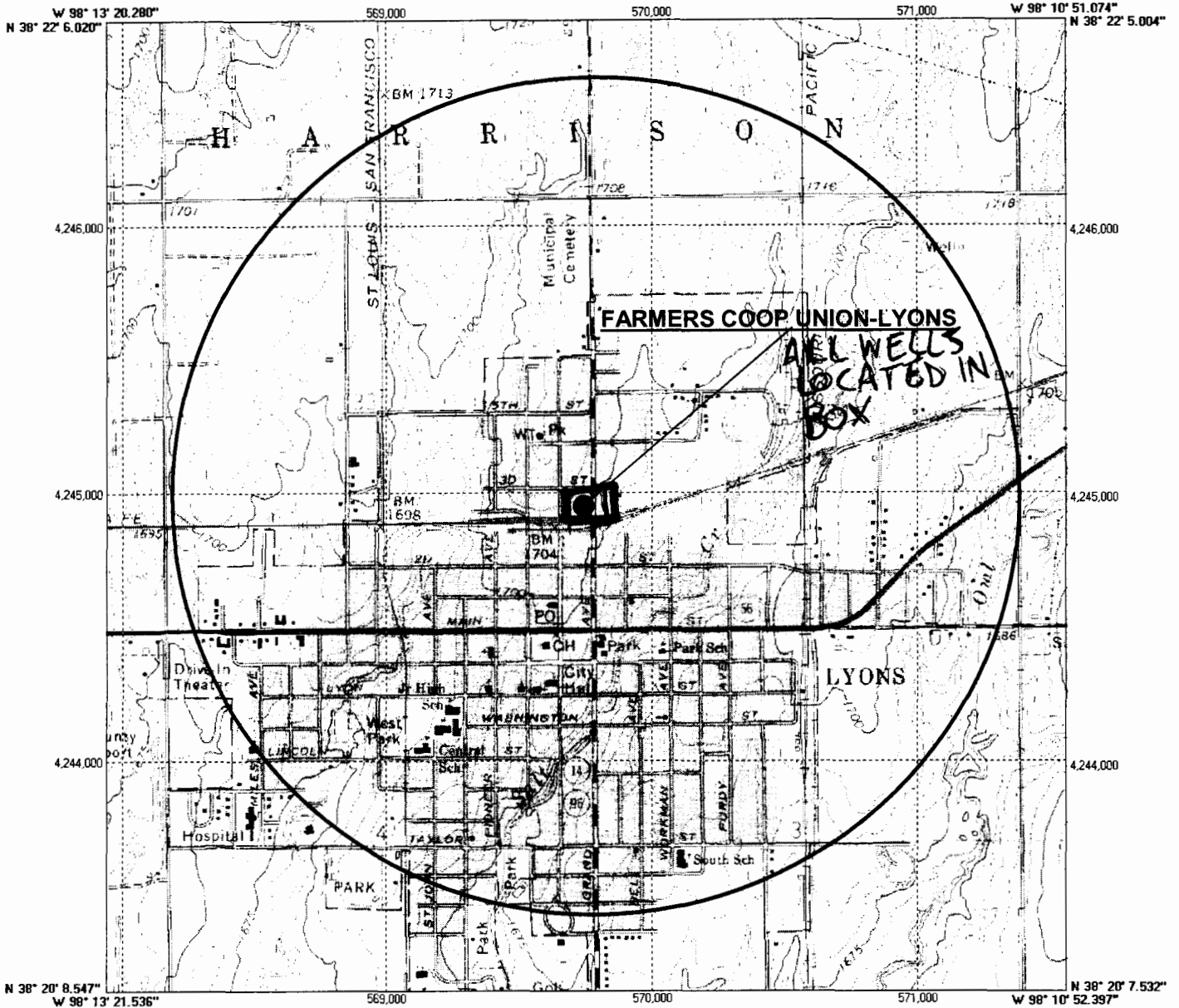

1927 North American Datum; 1,000-meter UTM grid zone 14  
 Generated by BigTopo (www.bigtopo.com)  
 Map compiled from USGS Quads: Lyons; KS

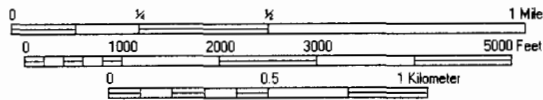

Farmers Coop Union-Lyons

**Figure 1: General Site Location**  
**Site Name: Farmers Coop Union-Lyons**  
**Address: 321 N Grand**  
**Lyons, KS**  
**KDHE ID: U5-080-00416**

**Source: Lyons, KS Quadrangle**



RECEIVED  
 MAY 21 2014  
 S33, T19S, R8W  
 SE SE NE SE BUREAU OF WATER