

Correction

WATER WELL PLUGGING RECORD Form WWC-5P KSA 82a-1212 ID NO. [ ]

1 LOCATION OF WATER WELL: County: Cheyenne Fraction 1/4 1/4 1/4 SE 1/4 Section Number 8 Township Number T 1 S Range Number 38  E  W

Street/Rural Address of Well Location; if unknown, distance & direction from nearest town or intersection: If at owner's address, check here  Terry Martin 931 Gage St Benkelman, NE 69021  
Global Positioning Systems (GPS) information: Latitude: 39.978614 (in decimal degrees) Longitude: -101.598583 (in decimal degrees) Elevation: \_\_\_\_\_ Horizontal Datum:  WGS84,  NAD83,  NAD27 Collection Method: \_\_\_\_\_

2 WATER WELL OWNER: RR#, St. Address, Box #: \_\_\_\_\_ City, State ZIP Code: \_\_\_\_\_  
 GPS unit (Make/Model): \_\_\_\_\_  
 Digital Map/Photo,  Topographic Map,  Land Survey  
Est. Accuracy:  < 3 m,  3-5 m,  5-15 m,  > 15 m

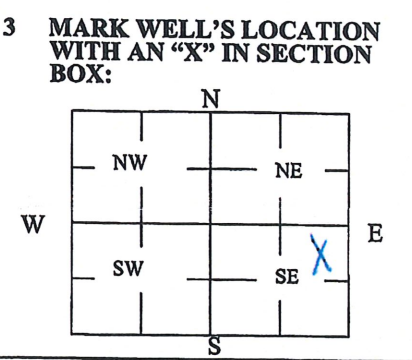

4 DEPTH OF WELL 32 ft.  
WELL'S STATIC WATER LEVEL 12 ft.  
WELL WAS USED AS:  
 Domestic  Public Water Supply  Dewatering  
 Irrigation  Oil Field Water Supply  Monitoring  
 Feedlot  Domestic (Lawn & Garden)  Injection Well  
 Industrial  Air Conditioning  Other \_\_\_\_\_  
Was a chemical/bacteriological sample submitted to Department? Yes  No

5 TYPE OF BLANK CASING USED:  
 Steel  RMP (SR)  Wrought  Fiberglass  Other (Specify below)  
 PVC  ABS  Asbestos-Cement  Concrete Tile  
Blank casing diameter 16 in. Was casing pulled? Yes  No  If yes, how much 5'  
Casing height above or below land surface -5' in.

6 GROUT PLUG MATERIAL:  Neat cement  Cement grout  Bentonite  Other Natural Fill  
Grout Plug Intervals: From 0 ft. to 5 ft., From 5 ft. to 32 ft., From \_\_\_\_\_ ft. to \_\_\_\_\_ ft.  
What is the nearest source of possible contamination:  
 Septic tank  Seepage pit  Fuel storage  Other (specify below)  
 Sewer lines  Pit privy  Fertilizer storage  
 Watertight sewer lines  Sewage lagoon  Insecticide storage  
 Lateral lines  Feedyard  Abandoned water well  
 Cess pool  Livestock pens  Oil well/Gas well  
Direction from well? SW  
How many feet? 2,100 ft.

FROM	TO	PLUGGING MATERIALS	FROM	TO	PLUGGING MATERIALS
0	5	Natural Fill			
5	32	Bentonite			

7 CONTRACTOR'S OR LANDOWNER'S CERTIFICATION: This water well was plugged under my jurisdiction and was completed on (mo/day/year) 10/2/2023 and this record is true to the best of my knowledge and belief. Kansas Water Well Contractor's License No. 946. This Water Well Record was completed on (mo/day/year) 10/17/2023 under the business name of Charles Sargent Irrigation Inc by (signature) [Signature]