

**WATER WELL PLUGGING RECORD Form WWC-5P**

KSA 82a-1212

ID NO.

RW-1

**1 LOCATION OF WATER WELL:** Fraction  $\frac{1}{4}$   $\frac{1}{4}$  NW  $\frac{1}{4}$  SW  $\frac{1}{4}$  Section Number 25 Township Number T 20 S Range Number 11  E  W  
 County: Barton  
 Street/Rural Address of Well Location; if unknown, distance & direction from nearest town or intersection: If at owner's address, check here  1/4 mile south and 1/8 mile east of SE 150 Ave and SE 50 Road  
**Global Positioning Systems (GPS) information:**  
 Latitude: 38.282332 (in decimal degrees)  
 Longitude: -98.494982 (in decimal degrees)  
 Elevation: \_\_\_\_\_  
 Horizontal Datum:  WGS84,  NAD83,  NAD27  
 Collection Method: \_\_\_\_\_

**2 WATER WELL OWNER:** Koch Transportation  
 RR#, St. Address, Box #: 4111 East 37th St. N  
 City, State ZIP Code: Wichita KS 67220  
 GPS unit (Make/Model: Garmin etrek)  
 Digital Map/Photo,  Topographic Map,  Land Survey  
 Est. Accuracy:  < 3 m,  3-5 m,  5-15 m,  > 15 m

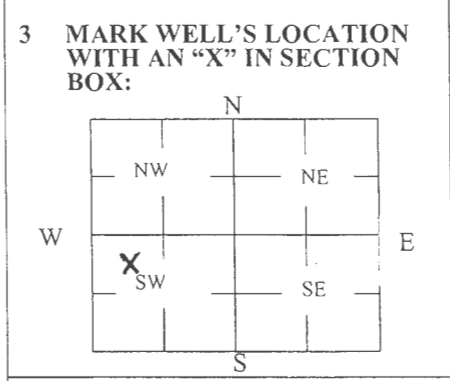

**4 DEPTH OF WELL** 30 ft.  
 WELL'S STATIC WATER LEVEL \_\_\_\_\_ ft.  
 WELL WAS USED AS:  
 Domestic  Public Water Supply  Dewatering  
 Irrigation  Oil Field Water Supply  Monitoring  
 Feedlot  Domestic (Lawn & Garden)  Injection Well  
 Industrial  Air Conditioning  Other \_\_\_\_\_  
 Was a chemical/bacteriological sample submitted to Department? Yes  No

**5 TYPE OF BLANK CASING USED:**  
 Steel  RMP (SR)  Wrought  Fiberglass  Other (Specify below)  
 PVC  ABS  Asbestos-Cement  Concrete Tile  
 Blank casing diameter 5 in. Was casing pulled? Yes  No  If yes, how much au  
 Casing height above or below land surface 30 in.

**6 GROUT PLUG MATERIAL:**  Neat cement  Cement grout  Bentonite  Other Top Soil  
 Grout Plug Intervals: From 0 ft. to 3 ft., From 3 ft. to 30 ft., From — ft. to — ft.  
 What is the nearest source of possible contamination:  
 Septic tank  Seepage pit  Fuel storage  Other (specify below)  
 Sewer lines  Pit privy  Fertilizer storage  
 Watertight sewer lines  Sewage lagoon  Insecticide storage  
 Lateral lines  Feedyard  Abandoned water well Direction from well? \_\_\_\_\_  
 Cess pool  Livestock pens  Oil well/Gas well How many feet? \_\_\_\_\_

FROM	TO	PLUGGING MATERIALS	FROM	TO	PLUGGING MATERIALS
0	3	Top Soil			
3	30	Bentonite			

**7 CONTRACTOR'S OR LANDOWNER'S CERTIFICATION:** This water well was plugged under my jurisdiction and was completed on (mo/day/year) 11/15/2018 and this record is true to the best of my knowledge and belief. Kansas Water Well Contractor's License No. 710. This Water Well Record was completed on (mo/day/year) 11/19/2018 under the business name of Below Ground Surface, Inc. by (signature) Craig R. Hewitt

Send one white copy to Kansas Department of Health & Environment, Geology Section, 1000 SW Jackson Street, Ste. 420, Topeka, KS 66612-1367. Send one copy to WATER WELL OWNER and retain one for your records.  
 Visit us at <http://www.kdheks.gov/waterwell/index.html> Telephone 785-296-5524.

11-10-2018

DAY 1

G:\Koch\Dev\Werrf\GIS\_Documents\Project\_Maps\koch\_631208971\_013\_site\_Y18M03.mxd\_Analyst: b weidman Date: 4/19/2018 3:43:43 PM



Source: Esri, DigitalGlobe, GeoEye, Earthstar Geographics, CNES/Airbus DS, USDA, USGS, AeroGRID, IGN, and the GIS User Community

**LEGEND**

- ▲ Recovery Well
- Monitoring Well
- - - Pipeline

**RECEIVED**  
**DEC. 04 2018**  
**BUREAU OF WATER**

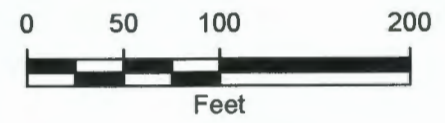

2872 NORTH RIDGE ROAD, SUITE 102B  
 WICHITA, KANSAS 67205  
 (316) 220-8020

**SITE MAP**

CLIENT: KOCH REMEDIATION & ENVIRONMENTAL SERVICES, LLC

LOCATION: DEWERFF SITE  
 BARTON COUNTY, KANSAS

FIGURE:  
**1**