

WATER WELL PLUGGING RECORD Form WWC-5P KSA 82a-1212 ID NO.

1 LOCATION OF WATER WELL: County: Pawnee Fraction 1/4 SW 1/4 SW 1/4 SE 1/4 Section Number 28 Township Number T 20 S Range Number 20 [ ] E [x] W

Street/Rural Address of Well Location; if unknown, distance & direction from nearest town or intersection: If at owner's address, check here [ ] 1/2 West, 5 1/2 North of Burdett

Global Positioning Systems (GPS) information: Latitude: (in decimal degrees) Longitude: (in decimal degrees) Elevation: Datum: [ ] WGS84, [ ] NAD83, [ ] NAD27 Collection Method: [ ] GPS unit (Make/Model: [ ] Digital Map/Photo, [ ] Topographic Map, [ ] Land Survey Est. Accuracy: [ ] < 3 m, [ ] 3-5 m, [ ] 5-15 m, [ ] > 15 m

2 WATER WELL OWNER: Steve Miller RR#, St. Address, Box #: 3535 U Road City, State ZIP Code: Burdett, Ks. 67523

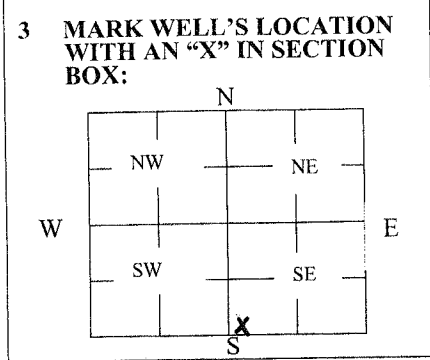

4 DEPTH OF WELL 76 ft. WELL'S STATIC WATER LEVEL 18 ft. WELL WAS USED AS: [x] Irrigation [ ] Domestic [ ] Feedlot [ ] Industrial [ ] Public Water Supply [ ] Oil Field Water Supply [ ] Domestic (Lawn & Garden) [ ] Air Conditioning [ ] Dewatering [ ] Monitoring [ ] Injection Well [ ] Other Was a chemical/bacteriological sample submitted to Department? Yes [ ] No [x]

5 TYPE OF BLANK CASING USED: [x] Steel [ ] PVC [ ] RMP (SR) [ ] ABS [ ] Wrought [ ] Asbestos-Cement [ ] Fiberglass [ ] Concrete Tile [ ] Other (Specify below) Blank casing diameter 16 in. Was casing pulled? Yes [ ] No [x] If yes, how much Casing height above or below land surface 0 in.

6 GROUT PLUG MATERIAL: [ ] Neat cement [x] Cement grout [ ] Bentonite [ ] Other Grout Plug Intervals: From 20 ft. to 0 ft. What is the nearest source of possible contamination: [x] Other (specify below) None [ ] Septic tank [ ] Sewer lines [ ] Watertight sewer lines [ ] Lateral lines [ ] Cess pool [ ] Seepage pit [ ] Pit privy [ ] Sewage lagoon [ ] Feedyard [ ] Livestock pens [ ] Fuel Storage [ ] Fertilizer storage [ ] Insecticide storage [ ] Abandoned water well [ ] Oil well/Gas well Direction from well? How many feet?

Table with 6 columns: FROM, TO, PLUGGING MATERIALS, FROM, TO, PLUGGING MATERIALS. Row 1: 76, 20, Chlorinated gravel. Row 2: 20, 0, Cement.

7 CONTRACTOR'S OR LANDOWNER'S CERTIFICATION: This water well was plugged under my jurisdiction and was completed on (mo/day/year) 4/11/11 and this record is true to the best of my knowledge and belief. Kansas Water Well Contractor's License No. 134. This Water Well Record was completed on (mo/day/year) 5/12/11 under the business name of Rosencrantz- Bemis by (signature) [Signature]

INSTRUCTIONS: Use typewriter or ballpoint pen. Please press firmly and print clearly. Please fill in blanks, underline or circle the correct answers. Send top three copies to Kansas Department of Health and Environment, Bureau of Water, Geology Section, 1000 SW Jackson St., Ste. 420, Topeka, Kansas 66612-1367. Telephone: 785/296-5524. Send one to Water Well Owner and retain one for your records. Visit us at http://www.kdheks.gov/waterwell/index.html.