

WATER WELL RECORD

Form WWC-5

Division of Water Resources App. No. 20100005

| | | | | | | |
|---|-----|---|------|--|--|--|
| 1 LOCATION OF WATER WELL: | | Fraction | | Section Number | Township Number | Range Number |
| County: Wichita | | $\frac{1}{4}$ NW $\frac{1}{4}$ SE $\frac{1}{4}$ NW $\frac{1}{4}$ | | 15 | T 20 S | R 35 <input type="checkbox"/> E <input checked="" type="checkbox"/> W |
| Street/Rural Address of Well Location; if unknown, distance & direction from nearest town or intersection: If at owner's address, check here <input type="checkbox"/> . | | | | Global Positioning System (GPS) information: | | |
| 2 WATER WELL OWNER: Darren McRea RR#, St. Address, Box # : Rt 2, Box 130 City, State, ZIP Code : Leoti, KS 67861 | | | | Latitude: _____ (in decimal degrees) | | |
| | | | | Longitude: _____ (in decimal degrees) | | |
| | | | | Elevation: _____ | | |
| | | | | Datum: <input type="checkbox"/> WGS 84, <input type="checkbox"/> NAD 83, <input type="checkbox"/> NAD 27 | | |
| | | | | Collection Method: <input type="checkbox"/> GPS unit (Make/Model: _____) <input type="checkbox"/> Digital Map/Photo, <input type="checkbox"/> Topographic Map, <input type="checkbox"/> Land Survey Est. Accuracy: <input type="checkbox"/> <3 m, <input type="checkbox"/> 3-5 m, <input type="checkbox"/> 5-15 m, <input type="checkbox"/> >15 m | | |
| 3 LOCATE WELL WITH AN "X" IN SECTION BOX: | | 4 DEPTH OF COMPLETED WELL <u>100</u> ft. | | | | |
| | | Depth(s) Groundwater Encountered (1) _____ ft. (2) _____ ft. (3) _____ ft. | | | | |
| | | WELL'S STATIC WATER LEVEL <u>NA</u> ft. below land surface measured on mo/day/yr _____ | | | | |
| | | Pump test data: Well water was _____ ft. after _____ hours pumping _____ gpm | | | | |
| | | EST. YIELD _____ gpm: Well water was _____ ft. after _____ hours pumping _____ gpm | | | | |
| | | WELL WATER TO BE USED AS: <input type="checkbox"/> Public water supply <input type="checkbox"/> Geothermal <input type="checkbox"/> Injection well <input type="checkbox"/> Domestic <input type="checkbox"/> Feedlot <input checked="" type="checkbox"/> Oil field water supply <input type="checkbox"/> Dewatering <input type="checkbox"/> Other (Specify below) _____ <input type="checkbox"/> Irrigation <input type="checkbox"/> Industrial <input type="checkbox"/> Domestic-lawn & garden <input type="checkbox"/> Monitoring well Was a chemical/bacteriological sample submitted to Department? <input type="checkbox"/> Yes <input checked="" type="checkbox"/> No If yes, mo/day/yr sample was submitted _____ Water Well Disinfected? <input checked="" type="checkbox"/> Yes <input type="checkbox"/> No | | | | |
| 5 TYPE OF CASING USED: <input type="checkbox"/> Steel <input checked="" type="checkbox"/> PVC <input type="checkbox"/> Other _____ | | | | | | |
| CASING JOINTS: <input checked="" type="checkbox"/> Glued <input type="checkbox"/> Clamped <input type="checkbox"/> Welded <input type="checkbox"/> Threaded | | | | | | |
| Casing diameter <u>4.5</u> in. to <u>60</u> ft., Diameter _____ in. to _____ ft., Diameter _____ in. to _____ ft. | | | | | | |
| Casing height above land surface <u>18</u> in., Weight <u>2.38</u> lbs./ft. Wall thickness or gauge No. <u>.248</u> | | | | | | |
| TYPE OF SCREEN OR PERFORATION MATERIAL: <input type="checkbox"/> Steel <input type="checkbox"/> Stainless Steel <input checked="" type="checkbox"/> PVC <input type="checkbox"/> Other (Specify) _____ <input type="checkbox"/> Brass <input type="checkbox"/> Galvanized Steel <input type="checkbox"/> None used (open hole) | | | | | | |
| SCREEN OR PERFORATION OPENINGS ARE: <input type="checkbox"/> Continuous Slot <input type="checkbox"/> Mill slot <input type="checkbox"/> Gauze wrapped <input type="checkbox"/> Torch cut <input type="checkbox"/> Drilled holes <input type="checkbox"/> None (open hole) <input type="checkbox"/> Louvered shutter <input type="checkbox"/> Key punched <input type="checkbox"/> Wire wrapped <input checked="" type="checkbox"/> Saw cut <input type="checkbox"/> Other (specify) _____ | | | | | | |
| SCREEN-PERFORATED INTERVALS: From <u>60</u> ft. to <u>100</u> ft., From _____ ft. to _____ ft. | | | | | | |
| GRAVEL PACK INTERVALS: From <u>20</u> ft. to <u>100</u> ft., From _____ ft. to _____ ft. | | | | | | |
| 6 GROUT MATERIAL: <input type="checkbox"/> Neat cement <input type="checkbox"/> Cement grout <input checked="" type="checkbox"/> Bentonite <input type="checkbox"/> Other _____ | | | | | | |
| Grout Intervals From <u>0</u> ft. to <u>20</u> ft. From _____ ft. to _____ ft. From _____ ft. to _____ ft. | | | | | | |
| What is the nearest source of possible contamination: <input type="checkbox"/> Septic tank <input type="checkbox"/> Lateral lines <input type="checkbox"/> Pit privy <input type="checkbox"/> Livestock pens <input type="checkbox"/> Insecticide storage <input type="checkbox"/> Other (specify below) _____ <input type="checkbox"/> Sewer lines <input type="checkbox"/> Cesspool <input type="checkbox"/> Sewage lagoon <input type="checkbox"/> Fuel storage <input type="checkbox"/> Abandoned water well <input type="checkbox"/> Watertight sewer lines <input type="checkbox"/> Seepage pit <input type="checkbox"/> Feedyard <input type="checkbox"/> Fertilizer storage <input type="checkbox"/> Oil well/gas well <u>None</u> Direction from well _____ Distance from well _____ | | | | | | |
| FROM | TO | LITHOLOGIC LOG | FROM | TO | LITHO. LOG (cont.) or PLUGGING INTERVALS | |
| 0 | 2 | Surface | | | | |
| 2 | 21 | Loess | | | | |
| 21 | 27 | Sandy Clay | | | | |
| 27 | 38 | Fine & med sand w/clay & caliche lenses | | | | |
| 38 | 52 | Fine sand w/caliche lenses | | | | |
| 52 | 80 | Fine & med sand w/clay & caliche | | | | |
| 80 | 92 | Fine sand w/clay strks | | | | |
| 92 | 100 | Yellow ochre/black shale | | | | |
| 7 CONTRACTOR'S OR LANDOWNER'S CERTIFICATION: This water well was <input checked="" type="checkbox"/> constructed, <input type="checkbox"/> reconstructed, or <input type="checkbox"/> plugged under my jurisdiction and was completed on (mo/day/year) <u>12/31/09</u> and this record is true to the best of my knowledge and belief. | | | | | | |
| Kansas Water Well Contractor's License No. <u>554 or 783</u> . This Water Well Record was completed on (mo/day/year) <u>1-11-08</u> | | | | | | |
| under the business name of <u>Woofers Pump & Well Inc.</u> by (signature) <u>[Signature]</u> | | | | | | |
| INSTRUCTIONS: Please fill in blanks and check the correct answers. Send three copies (white, blue, pink) to Kansas Department of Health and Environment, Bureau of Water, Geology Section, 1000 SW Jackson St., Suite 420, Topeka, Kansas 66612-1367. Telephone 785-296-5522. Send one to WATER WELL OWNER and retain one for your records. Include fee of \$5.00 for each constructed well. Visit us at http://www.kdheks.gov/waterwell/index.html . | | | | | | |



KANSAS DEPARTMENT OF HEALTH & ENVIRONMENT

ASSIGNMENT OF WATER WELL TO LANDOWNER

COPY

I, _____ of 711 S. Co. Rd. 17
(Landowner's address)

Leoti KS 67861 am the landowner on which a water well is located in
(City) (State) (Zip)
the NW quarter of the SW quarter of the NW quarter in Section 15, Township 20,
Range 35 ☐ E ☒ W, in Wichita County, Kansas which is approxi-
mately 1960 feet north south, and 1900 feet east west of the apparent NW
section corner. The water well was drilled in 1/2010 (month/year).

I hereby request that Raymond Oil Co. leave the water well,
(Operator name)

which was drilled by Temporary Water Permit # 20100005 00 unplugged, and I will
assume all responsibility for the plugging of said water well in accordance with the requirements
of the Kansas Department of Health and Environment regulation K.A.R. 28-30-7.

LANDOWNER:

Darren McKae 8-1-10
(Signature) (Date)

Darren McKae
(Print)

OPERATOR: Raymond Oil Co.

Ted McHenry 7/20/10
(Signature) (Date)

By: Ted McHenry
(Agent) Geologist

IF ADDITIONAL LANDOWNER

(Signature) (Date)

(Print)

WWC-7

RECEIVED
AUG 04 2010
BUREAU OF WATER

January 8, 2010

WOOFER PUMP AND WELL INC
PO BOX 689
HOXIE KS 67740-0689

RE: Temporary Permit
File No. 20100005

Dear Sir or Madam:

Your application for temporary permit to appropriate water for beneficial use has been examined, approved, and is being returned herewith for your records.

The approval of your application constitutes a temporary permit to appropriate water for beneficial use, as set forth in the application. This permit does not give authority to any right-of-way, or authorize injury to, or trespass upon public or private property, does not constitute authority under K.S.A. 82a 301 through 305 to construct any dam or other obstruction; nor does it obviate the necessity of assent from Federal or Local Governmental authorities, when necessary. Records must be maintained from which the quantity of water actually diverted may be readily determined.

Upon abandonment of the authorized well(s) for the authorized use, and/or dismissal or expiration of this temporary permit, the well(s) must be plugged in accordance with the requirements of Article 30 of the Rules and Regulations as adopted by the Kansas Department of Health and Environment (KDHE). If the well is to be retained by the landowner for other purposes after the expiration, the well(s) must initially be properly constructed by the well driller to comply with Article 30 of the Rules and Regulations as adopted by KDHE. Upon transfer of responsibility for maintenance of the well, a copy of the legal transfer must be forwarded to KDHE Geology Section, 1000 SW Jackson, Suite 420, Topeka, Kansas, 66612-1364, telephone (785) 296-5524.

K.S.A. 82a-728 sets forth, in essence, that it is unlawful to divert or threaten to divert water for the type use you propose without first acquiring approval of the Chief Engineer of the Division of Water Resources. K.S.A. 82a-737 sets forth that violation of the Kansas Water Appropriation Act, any adopted rule or regulation, or any order of the Chief Engineer, may be subject to a civil penalty of up to \$1000, per violation. Each day that any such violation occurs can be considered a separate offense.

If you have any questions, please contact our office at (785) 296-3717.

Sincerely,

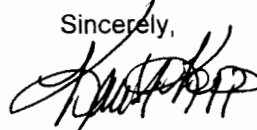

Kenneth A. Kopp, L.G.
Water Appropriation Program

Enclosures
pc: Darren McRae

CERTIFICATE OF SERVICE

On this 8th day of January, 2010, I hereby certify that the attached Approval of Application for Temporary Permit, File No. 20100005, dated January 8, 2010, was mailed postage prepaid, first class, US mail to the following:

DARREN MCRAE
711 S COUNTY ROAD 17
LEOTI KS 67861-6219

WOOFER PUMP AND WELL INC
PO BOX 689
HOXIE KS 67740-0689



Staff

RECEIVED
JAN 15 2010
KS GEO SURVEY

WATER RESOURCES
RECEIVED

JAN 07 2010



State of Kansas

Submit To:

CHIEF ENGINEER
Division of Water Resources
Kansas Department of Agriculture
109 SW 9th Street, 2nd Floor
Topeka, KS 66612-1283
www.ksda.gov/dwr

APPLICATION FOR
TEMPORARY PERMIT

☒ GROUNDWATER
☐ SURFACE WATER
(check one)

STATUTORY FILING FEE OF \$200.00 MUST ACCOMPANY THIS APPLICATION
(Make check payable to the Kansas Department of Agriculture)

20100005

1. Applicant: (Please print or type)
Name Raymond Oil
Street P.O. Box 48788
City and State Wichita KS
Zip Code 67201 Telephone No. _____
Social Security I.D. No. _____
and/or Taxpayer I.D. No. _____

6. Period of use (6 months maximum):
Commencing date: 1-12-10
Ending Date: 6-12-10

2. Location of Point of Diversion:
Sec. 15, Twp. 20, Rng. 35, (E.W.),
Wichita County, Kansas.

7. Location of the proposed point of diversion shall be indicated on the diagram below. Use the center section.

If surface water, indicate on the diagram the course of the stream, and its name.

The scale of the diagram is 2 inches = 1 mile
Each small square represents 10 acres

Distance from Southeast Corner of Section:
3310 feet North from Southeast Corner
3410 feet West from Southeast Corner

Existing water right? Yes ☐ No ☒
If yes, File No. _____

Pending application? Yes ☐ No ☒
If yes, File No. _____

3. Water Use Data:
Proposed Max. Pumping Rate (gpm) 60
Amount Requested (gallons) 300,000
(not to exceed one million gallons unless for dewatering)
Depth of Well (feet) 100, OR
Name of Stream _____

4. Water is to be used for (briefly describe proposed use):
Water Supply Well for Oil
Field Drilling

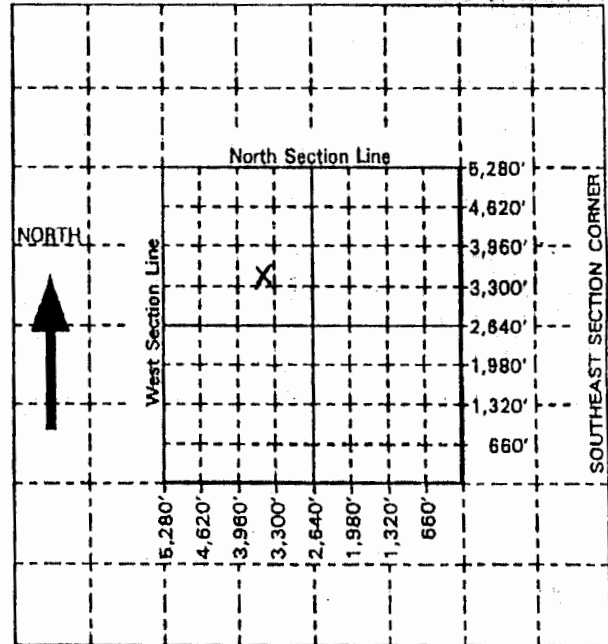

5. Location of place of use:
NW 1/4
15-20-35
Wichita Co

FO. 4
GMD 0
MEETS 0
K.A.R. 5- 1
BY PAV
DATE 01/07/2010

For Office Use Only: Code TMP Fee \$ 200 TR # _____ Recelpt Date 1-7-10 Check # 37364

8. For groundwater use, list below all wells within 1/2 mile of the proposed well, and plot locations upon the diagram on reverse side. If additional space is needed, attach sheet.

Other wells -

Well A Owner(s): _____
Address: _____

Well B Owner(s): _____
Address: _____

9. For surface water use, list below the names and addresses of all landowners from a point 1/2 mile upstream to a point 1/2 mile downstream of the tract of land upon which the point of diversion is located. If additional space is needed, attach sheet.

Tract A Owner(s): _____
Address: _____

Tract B Owner(s): _____
Address: _____

10. The owner of the point of diversion, is (please print):

Darren McRae - Rt 2 - Box 130 - Leoti, KS 67861
(name, address and telephone number)

You must provide evidence of legal access to, or control of, the point of diversion of water, from the landowner or the landowner's authorized representative. Provide a copy of a recorded deed, lease, easement or other document with this application. In lieu thereof, you may sign the following sworn statement: Attached (KAR/KOR)

I have legal access to, or control of, the point of diversion described in this application from the landowner or the landowner's authorized representative. I declare under penalty of perjury that the foregoing is true and correct.

Executed on _____, 20____.

Applicant's Signature

11. The applicant states that the information set forth herein is true and accurate to the best of his/her knowledge.

Signature of Applicant

or

Waste Pump & Well Inc
Authorized Representative

1-5-10
Date

Applicant's Name Printed

Title

DO NOT WRITE BELOW THIS LINE

CONDITIONS OF APPROVAL:

The applicant shall maintain records from which the quantity of water actually diverted may be readily determined.

The use of water herein authorized shall not be made so as to impair any use under existing water rights or prejudicially and unreasonably affect the public interest.

K.S.A. 82a-728 states in part "(a) except for the appropriation of water for the purpose of domestic use, . . . it shall be unlawful for any person to appropriate or threaten to appropriate water from any source without first applying for and obtaining a permit to appropriate water . . ."

Well(s) must be properly constructed by the well driller to comply with Article 30 of the Rules and Regulations as adopted by the Kansas Department of Health and Environment.

The Chief Engineer specifically retains jurisdiction in this matter with authority to make such reasonable reductions in the approved rate of diversion and quantity authorized, and such changes in other terms, conditions, and limitations set forth in this approval and permit to proceed as may be deemed to be in the public interest.

RECEIVED

JAN 15 2010

KS GEO SURVEY

APPLICATION APPROVED

Permit Number: 20100005
Date Issued: January 8, 2010
Effective: January 12, 2010
Expiration Date: June 12, 2010



For: **David W Barfield, P.E.**
Chief Engineer
Division of Water Resources
Kansas Department of Agriculture

The point of diversion authorized by the approval of this application for temporary permit is more particularly described as being located in the Northwest Quarter of the Southwest Quarter of the Northwest Quarter (NW 1/4 SW 1/4 NW 1/4) of Section 15, Township 20 South, Range 35 West, Wichita County, Kansas.

This is a final agency action. If you choose to appeal this decision or any finding or part thereof, you must do so by filing a petition for review in the manner prescribed by the Kansas Act for Judicial Review and Civil Enforcement of Agency Actions (KJRA K.S.A. 77-601 et. seq.) within 30 days of service of this order. Your appeal must be made with the appropriate district court for the district of Kansas. The Chief Legal Counsel for the Kansas Department of Agriculture, 109 SW 9th Street, 4th Floor, Topeka, Kansas 66612, is the agency officer who will receive service of a petition for judicial review on behalf of the Department of Agriculture, Division of Water Resources. If you have questions or would like clarification concerning this order, you may contact the Chief Engineer.