

WATER WELL PLUGGING RECORD Form WWC-5P

KSA 82a-1212 ID NO.

1 LOCATION OF WATER WELL: County: Rice	Fraction $\frac{1}{4}$ NW $\frac{1}{4}$ NW $\frac{1}{4}$ NE $\frac{1}{4}$	Section Number 5	Township Number T 20 S	Range Number 8 <input type="checkbox"/> E <input checked="" type="checkbox"/> W
--	--	---------------------	---------------------------	--

Street/Rural Address of Well Location; if unknown, distance & direction from nearest town or intersection: If at owner's address, check here <input type="checkbox"/> 2000' W of Lyons, 500' S of Hwy 56	Global Positioning Systems (GPS) information: Latitude: _____ (in decimal degrees) Longitude: _____ (in decimal degrees) Elevation: _____ Datum: <input type="checkbox"/> WGS84, <input type="checkbox"/> NAD83, <input type="checkbox"/> NAD27 Collection Method: <input type="checkbox"/> GPS unit (Make/Model: _____) <input type="checkbox"/> Digital Map/Photo, <input type="checkbox"/> Topographic Map, <input type="checkbox"/> Land Survey Est. Accuracy: <input type="checkbox"/> < 3 m, <input type="checkbox"/> 3-5 m, <input type="checkbox"/> 5-15 m, <input type="checkbox"/> > 15 m
---	--

2 WATER WELL OWNER: Rice County Airport
 RR#, St. Address, Box #: 460 N. Logan
 City, State ZIP Code: Lyons, KS 67554

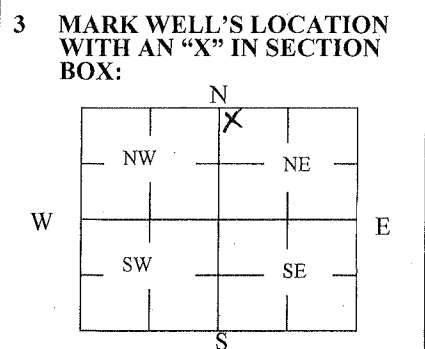

4 DEPTH OF WELL 37.24 ft.
WELL'S STATIC WATER LEVEL 4.35 ft.
WELL WAS USED AS:
 Domestic Public Water Supply Dewatering
 Irrigation Oil Field Water Supply Monitoring
 Feedlot Domestic (Lawn & Garden) Injection Well
 Industrial Air Conditioning Other _____
 Was a chemical/bacteriological sample submitted to Department? Yes No

5 TYPE OF BLANK CASING USED:

Steel RMP (SR) Wrought Fiberglass Other (Specify below) _____
 PVC ABS Asbestos-Cement Concrete Tile

Blank casing diameter 2 in. Was casing pulled? Yes No If yes, how much 3'
 Casing height above or below land surface _____ in.

6 GROUT PLUG MATERIAL: Neat cement Cement grout Bentonite Other _____

Grout Plug Intervals: From 3 ft. to 37.24 ft., From _____ ft. to _____ ft., From _____ to _____ ft.

What is the nearest source of possible contamination:

<input type="checkbox"/> Septic tank	<input type="checkbox"/> Seepage pit	<input type="checkbox"/> Fuel Storage	<input type="checkbox"/> Other (specify below) _____
<input type="checkbox"/> Sewer lines	<input type="checkbox"/> Pit privy	<input type="checkbox"/> Fertilizer storage	
<input type="checkbox"/> Watertight sewer lines	<input type="checkbox"/> Sewage lagoon	<input type="checkbox"/> Insecticide storage	
<input type="checkbox"/> Lateral lines	<input type="checkbox"/> Feedyard	<input type="checkbox"/> Abandoned water well	Direction from well? _____
<input type="checkbox"/> Cess pool	<input type="checkbox"/> Livestock pens	<input type="checkbox"/> Oil well/Gas well	How many feet? _____

FROM	TO	PLUGGING MATERIALS	FROM	TO	PLUGGING MATERIALS
0	3	Soil			
3	37.24	Bentonite			
					MW3

7 CONTRACTOR'S OR LANDOWNER'S CERTIFICATION: This water well was plugged under my jurisdiction and was completed on (mo/day/year) 3/21/2012 and this record is true to the best of my knowledge and belief. Kansas Water Well Contractor's License No. 527. This Water Well Record was completed on (mo/day/year) 4/20/2012 under the business name of GeoCore Inc. by (signature) Dale Bell

INSTRUCTIONS: Use typewriter or ballpoint pen. Please press firmly and print clearly. Please fill in blanks, underline or circle the correct answers. Send top three copies to Kansas Department of Health and Environment, Bureau of Water, Geology Section, 1000 SW Jackson St., Ste. 420, Topeka, Kansas 66612-1367. Telephone: 785/296-5524. Send one to Water Well Owner and retain one for your records. Visit us at <http://www.kdheks.gov/waterwell/index.html>.

Check one: White Copy Blue Copy Pink Copy