

**WATER WELL RECORD**

**Form WWC-5**

Division of Water Resources App. No.

27018

<b>1 LOCATION OF WATER WELL:</b> County: Stafford	Fraction ¼    ¼ NC    ¼ NW    ¼	Section Number 9	Township No. T 21 S	Range Number R 14 <input type="checkbox"/> E <input checked="" type="checkbox"/> W
--	------------------------------------	---------------------	------------------------	---

Street/Rural Address of Well Location; if unknown, distance & direction from nearest town or intersection: If at owner's address, check here   
4 3/4 North, 1 1/4 East of Radium

<b>2 WATER WELL OWNER:</b> Margaret Ann Asher RR#, Street Address, Box #: 2040 NW 60th Avenue City, State, ZIP Code : Great Bend, KS 67530	<b>Global Positioning System (GPS) information:</b> Latitude: ..... (in decimal degrees) Longitude: ..... (in decimal degrees) Elevation: ..... Datum: <input type="checkbox"/> WGS 84, <input type="checkbox"/> NAD 83, <input type="checkbox"/> NAD 27 Collection Method: <input type="checkbox"/> GPS unit (Make/Model: .....) <input type="checkbox"/> Digital Map/Photo, <input type="checkbox"/> Topographic Map, <input type="checkbox"/> Land Survey Est. Accuracy: <input type="checkbox"/> <3 m, <input type="checkbox"/> 3-5 m, <input type="checkbox"/> 5-15 m, <input type="checkbox"/> >15 m
---	--

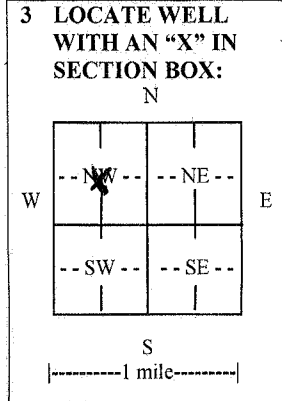

**4 DEPTH OF COMPLETED WELL** 182 ..... ft.

Depth(s) Groundwater Encountered (1)..... ft. (2)..... ft. (3)..... ft.

WELL'S STATIC WATER LEVEL 36 ..... ft. below land surface measured on mo/day/yr. 4-25-13.....

Pump test data: Well water was 61 ..... ft. after 3 ..... hours pumping 1287 ..... gpm

EST. YIELD 1428 gpm. Well water was 64 ..... ft. after 3 1/2 ..... hours pumping 1428 ..... gpm

Bore Hole Diameter 30 ..... in. to 182 ..... ft., and ..... in. to ..... ft.

WELL WATER TO BE USED AS:  Public water supply     Geothermal     Injection well  
 Domestic     Feedlot     Oil field water supply     Dewatering     Other (Specify below)  
 Irrigation     Industrial     Domestic-lawn & garden     Monitoring well .....

Was a chemical/bacteriological sample submitted to Department?  Yes     No  
 If yes, mo/day/yr sample was submitted.....

Water well disinfected?  Yes     No

**5 TYPE OF CASING USED:**  Steel     PVC     Other .....

CASING JOINTS:  Glued     Clamped     Welded     Threaded

Casing diameter 16 ..... in. to 182 ..... ft., Diameter ..... in. to ..... ft., Diameter ..... in. to ..... ft.

Casing height above land surface 18 ..... in., Weight Sch 40 ..... lbs./ft., Wall thickness or gauge No. ....

TYPE OF SCREEN OR PERFORATION MATERIAL:  
 Steel     Stainless Steel     PVC     Other (Specify) .....  
 Brass     Galvanized Steel     None used (open hole)

SCREEN OR PERFORATION OPENINGS ARE:  
 Continuous slot     Mill slot     Gauze wrapped     Torch cut     Drilled holes     None (open hole)  
 Louvered shutter     Key punched     Wire wrapped     Saw cut     Other (specify) .....

SCREEN-PERFORATED INTERVALS: From 182 ..... ft. to 62 ..... ft., From ..... ft. to ..... ft.

GRAVEL PACK INTERVALS: From 182 ..... ft. to 20 ..... ft., From ..... ft. to ..... ft.

**6 GROUT MATERIAL:**  Neat cement     Cement grout     Bentonite     Other .....

Grout Intervals: From ..... ft. to ..... ft., From 20 ..... ft. to 0 ..... ft., From ..... ft. to ..... ft.

What is the nearest source of possible contamination:  
 Septic tank     Lateral lines     Pit privy     Livestock pens     Insecticide storage     Other (specify below)  
 Sewer lines     Cesspool     Sewage lagoon     Fuel storage     Abandoned water well  
 Watertight sewer lines     Seepage pit     Feedyard     Fertilizer storage     Oil well/gas well     None

Direction from well ..... Distance from well .....

FROM	TO	LITHOLOGIC LOG	FROM	TO	LITHO. LOG (cont.) or PLUGGING INTERVALS
0	4	Top soil	121	150	Fine to small sand & gravel,
4	21	Sandy tan clay & fine sand			bits of clay
21	32	Fine sand	150	182	Small sand & gravel, few clay balls
32	36	Tan clay	182		Tan clay
36	41	Ironated sand- fine			
41	87	Sand & gravel- small to med, bigger w/ depth, few clay streaks			
87	102	Sandy tan clay & fine sand; hard streak of cemented sand at 97ft			
102	121	Harder tan clay			

**7 CONTRACTOR'S OR LANDOWNER'S CERTIFICATION:** This water well was  constructed,  reconstructed, or  plugged under my jurisdiction and was completed on (mo/day/year) 6-25-13 ..... and this record is true to the best of my knowledge and belief.

Kansas Water Well Contractor's License No. 134 ..... This Water Well Record was completed on (mo/day/year) 7-9-13 ..... under the business name of Rosencrantz- Bemis ..... by (signature) Gloria Alip .....

**INSTRUCTIONS:** Use typewriter or ball point pen. PLEASE PRESS FIRMLY and PRINT clearly. Please fill in blanks and check the correct answers. Send three copies (white, blue, pink) to Kansas Department of Health and Environment, Bureau of Water, Geology Section, 1000 SW Jackson St., Suite 420, Topeka, Kansas 66612-1367. Telephone 785-296-5524. Send one copy to WATER WELL OWNER and retain one for your records. Include fee of \$5.00 for each constructed well. Visit us at <http://www.kdheks.gov/waterwell/index.html>.