

WATER WELL RECORD

Form WWC-5

Division of Water Resources App. No.

Well ID

MW2R

Original Record Correction Change in Well Use

1 LOCATION OF WATER WELL: County Pawnee Fraction SE 1/4 NW 1/4 NE 1/4 NE 1/4 Section Number 32 Township Number T 21 S Range Number R 16 E W

2 WELL OWNER: Last Name: Van Vleet First: Dean Street or Rural Address where well is located (if unknown, distance and direction from nearest town or intersection): ~60' E of 1323 Broadway, Larned, KS

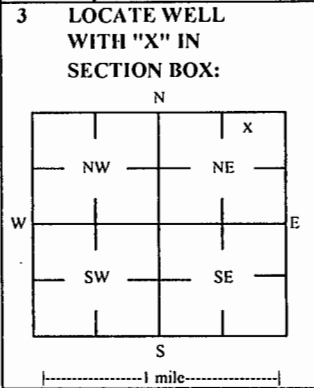

4 DEPTH OF COMPLETED WELL: 45 ft Depth(s) Groundwater Encountered: 1) ft 2) ft 3) ft, or 4) Dry Well WELL'S STATIC WATER LEVEL: 39.74 ft

5 Latitude: 38.18763 (decimal degrees) Longitude: 99.09820 (decimal degrees) Horizontal Datum: WGS 84 NAD 83 NAD 27

6 Elevation 2028.30 ft Ground Level TOC Source Land Survey GPS Topographic Map Other

7 WELL WATER TO BE USED AS: 1 Domestic: Household Lawn & Garden Livestock Irrigation Feedlot Industrial 5 Public Water Supply: well ID 6 Dewatering: how many wells? 7 Aquifer Recharge: well ID 8 Monitoring: well ID MW2R 9 Environmental Remediation: well ID Air Sparge Soil Vapor Extractor Recovery Injection 10 Oil Field Water Supply: lease 11 Test Hole: well ID Cased Uncased Geotechnical 12 Geothermal: How many bores? a) Closed Loop Horizontal Vertical b) Open Loop Surface Discharge Inj. of Water Other (specify):

Was a chemical/bacteriological sample submitted to KDHE? Yes No If yes, date sample was submitted: Water well disinfected? Yes No

8 TYPE OF CASING USED: Steel PVC Other CASING JOINTS: Glued Clamped Welded Threaded Casing diameter 2 in. to 30 ft, Diameter in. to ft, Diameter in. to ft, Casing height above land surface -0.28 in. Weight lbs./ft. Well thickness or gauge No TYPE OF SCREEN OR PERFORATION MATERIAL: Steel Stainless Steel Fiberglass PVC Other (Specify) Brass Galvanized Steel Concrete tile None used (open hole) SCREEN OR PERFORATION OPENINGS ARE: Continuous Slot Mill Slot Gauze Wrapped Torch Cut Drilled Holes Other (Specify) Louvered Shutter Kcy Punched Wire Wrapped Saw Cut None (Open Hole) SCREEN-PERFORATED INTERVALS: From 30 ft. to 45 ft., From ft. to ft., From ft. to ft., GRAVEL PACK INTERVALS: From 28 ft. to 45 ft., From ft. to ft., From ft. to ft.,

9 GROUT MATERIAL: Neat cement Cement grout Bentonite Other Concrete: 0-0.5' Grout intervals: From 0.5 ft. to 28 ft., From ft. to ft., From ft. to ft.,

Nearest source of possible contamination: Septic Tank Lateral Lines Pit Privy Livestock Pens Insecticide Storage Sewer Lines Ccss Pool Sewage Lagoon Fuel Storage Abandoned Water Well Watertight Sewer Lines Seepage Pit Feedyard Fertilizer Storage Oil Well / Gas Well Other (Specify) Direction from well? NE Distance from well? ~25 ft

Table with 6 columns: FROM, TO, LITHOLOGIC LOG, FROM, TO, LITHO. LOG (cont.) or PLUGGING INTERVALS. Rows show depth intervals and lithology: 0-0.5 Concrete, 0.5-28.5 Clayey silt, 28.5-29 Caliche/calcerous nodules, 29-44.5 Very fine sand/loess, 44.5-45 Silty clay.

Notes: KDHE ID: Dean's 66 Service; UI-073-11810

11 CONTRACTOR'S OR LANDOWNER'S CERTIFICATION: This water well was constructed, reconstructed, or plugged under my jurisdiction and was completed on (mo-day-year) 4/5/19 and this record is true to the best of my knowledge and belief. License No 757 This Water Well Record was completed on (mo-day-year) 4/29/19 under the business name of Larsen & Associates, Inc. Signature

Mail 1 white copy along with a fee of \$5.00 for each constructed well to: Kansas Department of Health and Environment, Bureau of Water, GWTS Section, 1000 SW Jackson St., Suite 420, Topeka, Kansas 66612-1367. Mail one to Water Well Owner and retain one for your records. Telephone 785-296-5524.

SMH CONSULTANTS

April 19, 2019

Larsen and Associates
 Jessica Chapman
 1311 East 25th Street, Suite B
 Lawrence, Kansas 66046
 Email: jess@larsenenvironmental.com

RE: Project No. 1904MN1100

Jessica:

The following is the information requested on a Monitoring Well Site, Dean's 66 Service, 1323 Broadway, Larned, Pawnee County, Kansas.

RECEIVED
 MAY 13 2019
 BUREAU OF WATER

Point	North Coord.	East Coord.	Distance SE Cor. North	From S.32 West	Elev. Top Of Rim or PK Nail	Elev. Top of PVC Pipe	Latitude North	Longitude West
SE Corner S.32-T21S-R16W	10000	10000						
MW2R	14810.29	9289.53	4810.29	710.47	2028.58	2028.30	38.18763	99.09820
Site BM	14831.93	9080.02	4831.93	919.98		BM Elevation = 2028.62		

BM Description: "X" cut in concrete 2 feet North of the Northwest corner of the building on site.

MW2R is in the: SE¼ NW¼ NE¼ NE¼ S.32-T21S-R16W

If you have any questions, please do not hesitate in giving us a call.

Sincerely,



Tim Sloan, L.S.
 SMH CONSULTANTS

NOTE: Figures exhibited within this report are only to be used within the context of this report. Placement of property lines, wells, structures, and roads is based on the available information from county appraiser maps, surveys, site visits, and/or previous vendor reports and should be considered approximate.

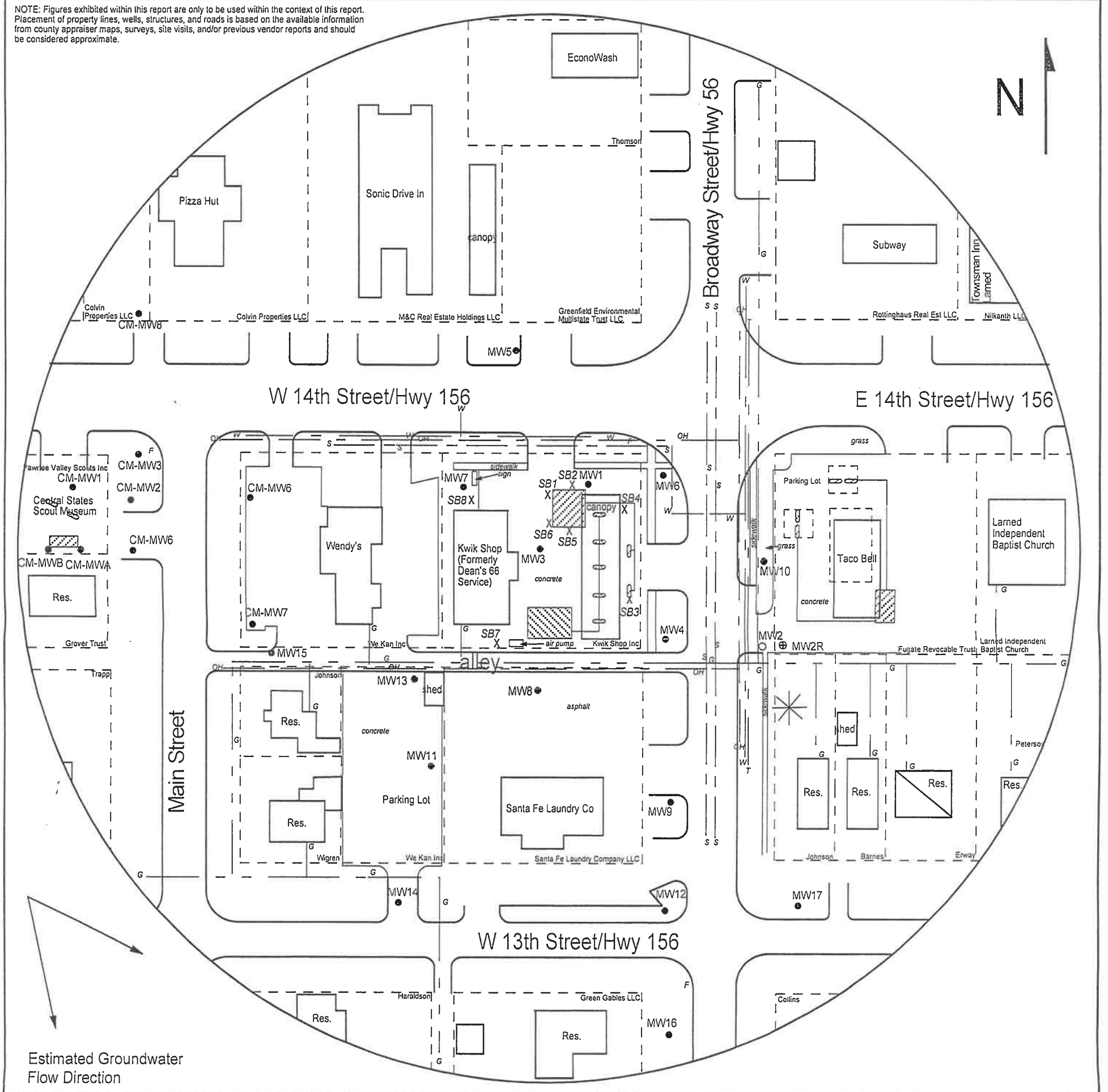

FIGURE 2.2 - 500 FT RADIUS AREA BASE MAP

LEGEND

- Approximate Location of Former UST Basin, Pump Islands & Product Line
- Approximate Location of Active UST Basin, Product Lines & Pump Islands
- Building with Basement
- Approximate Location of Property Line
- Existing Monitoring Well
- Plugged Well
- Monitoring Well (Installed 4/5/19)
- Soil Boring (Drilled 4/4-5/19)
- Fire Hydrant
- Gas Lines (1.5 - 3 ft bgs)
- Overhead Lines (25'-40' high)
- Sewer Lines (2 - 6 ft bgs)
- Telephone Lines (2 - 6 ft bgs)
- Water Lines (2 - 6 ft bgs)

NOTE: SB7 & SB8 were drilled to collect hydrologic samples.
NOTE: Utility depths, heights and locations are approximate.



& ASSOCIATES, INC.

1311 E 25th St., Suite B 785-841-8707 office
Lawrence, KS 66046 785-865-4282 fax

PROJECT:

Dean's 66 Service
1323 Broadway
Larned, KS
KDHE ID: U1-073-11810
Date: 4/11/19

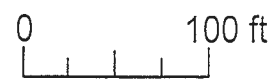

RECEIVED
MAY 13 2019
BUREAU OF WATER