



NOTE: Figures exhibited within this report are only to be used within the context of this report. Placement of property lines, wells, structures, and roads is based on the available information from county appraiser maps, surveys, site visits, and/or previous vendor reports and should be considered approximate.

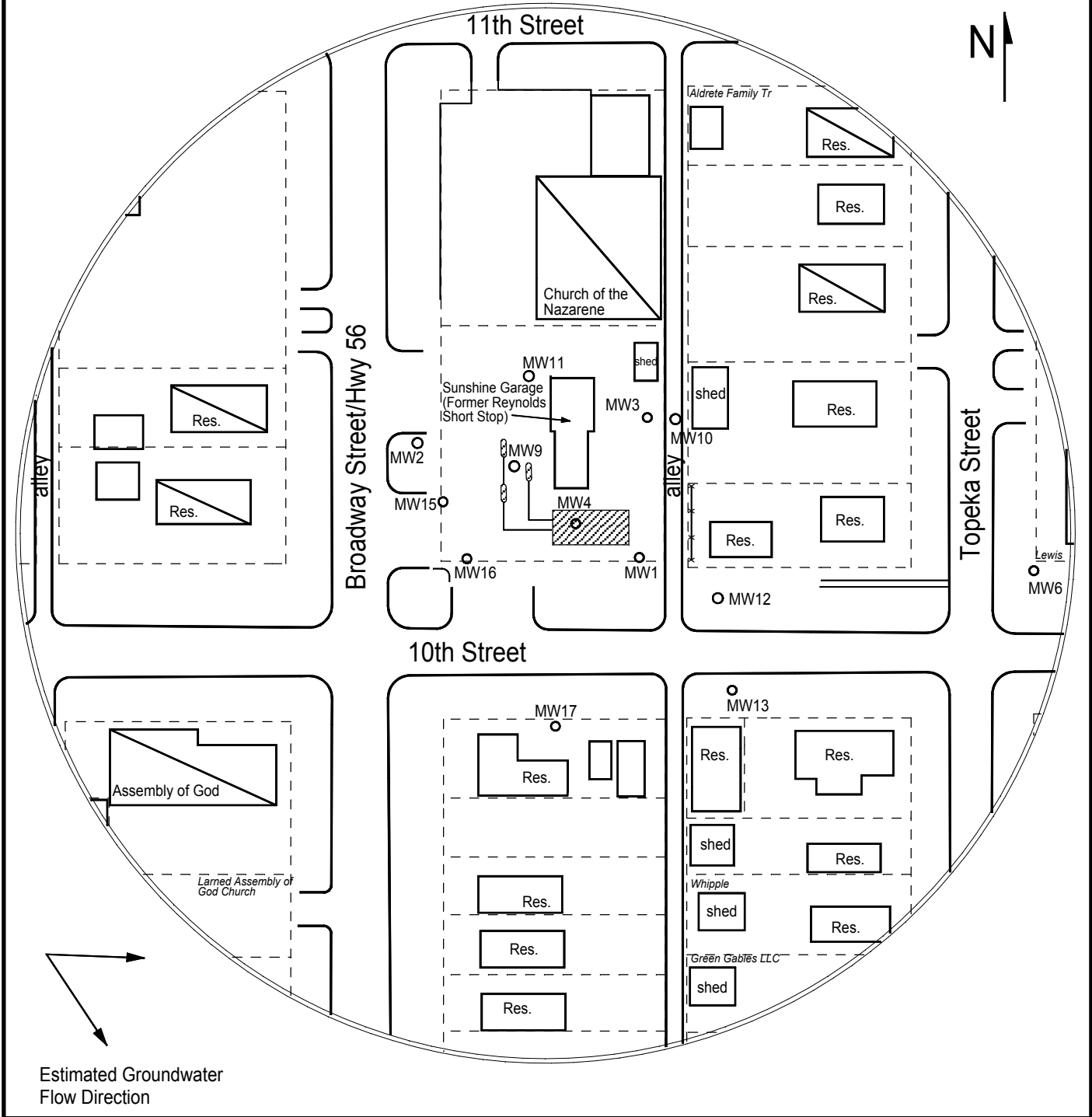

FIGURE 2.1 - 350 FT RADIUS AREA BASE MAP



**PROJECT:**  
 Reynolds Short Stop  
 1006 Broadway  
 Larned, KS  
 KDHE ID: U1-073-00772  
 Date: 12/18/19

**LEGEND:**

- Approximate Location of Former UST Basin, Product Lines & Pump Islands
- Building with Basement
- Approximate Location of Property Line
- Existing Monitoring Well (Installed 12/17/19)
- Suggested Well (Drilled 12/18/19)
- Electric Meter
- Gas Lines (1.5 - 3 ft bgs)
- Overhead Lines (25'-40' high)
- Sewer Lines (2 - 6 ft bgs)
- Water Lines (1.5 - 3 ft bgs)

NOTE: SB7 & SB8 were drilled to collect hydrologic samples.  
 NOTE: Utility depths, heights and locations are approximate.

1311 E 25th St. Suite B    785-841-8707 office  
 Lawrence, KS 66046      785-865-4282 fax

